

Quick Setup

Before using the projector, make sure you read the safety instructions in the online *User's Guide*.

Connect the projector

Choose from the following connections. See the sections below or the online *User's Guide* for details.

Computer

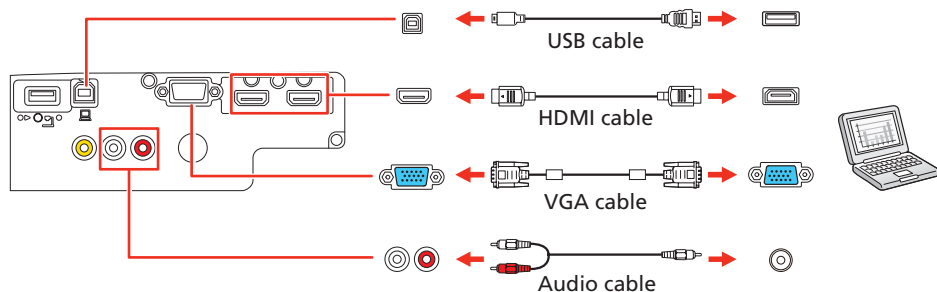

Computer port

Connect one end of a VGA cable to the projector's **Computer** port, and the other end to your laptop or computer's monitor port. Make sure to switch your laptop to external display (see "Troubleshooting" on the back of this sheet). You can also connect an audio cable.

HDMI port

Connect one end of an HDMI cable to one of the projector's HDMI ports shown above and the other end to an HDMI port on your computer.

USB port

Connect the square end of a USB cable to the projector's **USB-B** (square) port. Connect the flat end of the cable to any USB port on your computer.

Windows Vista® or later: After turning on the projector, follow the on-screen instructions to install the Epson® USB Display software (**EMP_UDSE.EXE**; only on first connection). If the software screen does not display automatically, open **My Computer** or **Computer**, then double-click **EPSON_PJ_UD**.

OS X 10.7.x or higher: After turning on the projector, the setup folder for USB Display appears in the Finder. Double-click **USB Display Installer** and follow the on-screen instructions to install the Epson USB Display software (only on first connection).

Video device

Connect multiple video devices and use the **Source Search** button on the projector or remote control to switch between them.

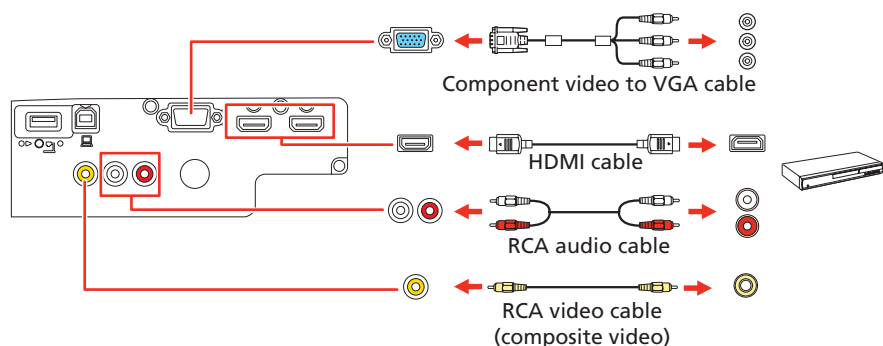

Mobile media device

Connect tablets, smartphones, and other devices that support the MHL™ standard to the **HDMI2/MHL** port.

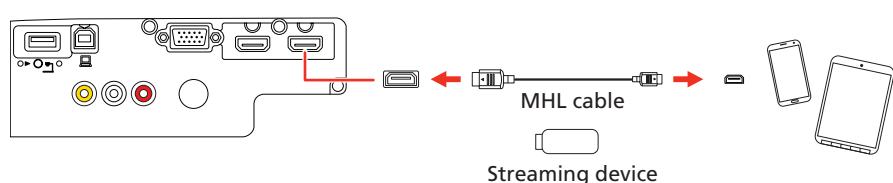

Some devices may require an adapter or may not require an MHL cable. Not all features or functions may be supported. Check your device's documentation for more information.

USB device

Connect a digital camera, USB flash drive, or USB storage device to the projector's **USB-A** (flat) port.

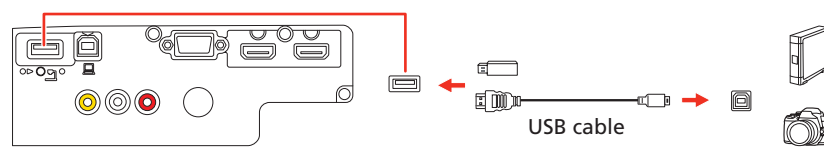

If you connect a digital camera, USB flash drive, or USB storage device, you can use the projector's PC Free feature. See the online *User's Guide* for details.

Turn on your equipment

- 1 Turn on your computer or video source.
- 2 Plug in the projector. The power light on the projector turns blue.

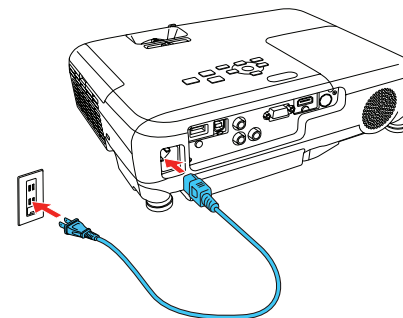

- 3 Open the AV Mute slide all the way.

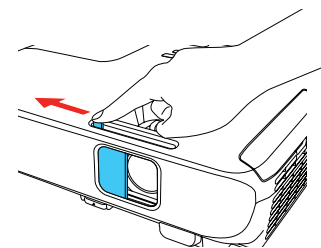

- 4 Press the power button on the projector or remote control. The projector beeps, the Status light flashes blue, and then stays on.

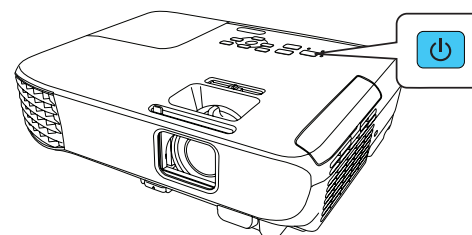

Note: To shut down the projector, press the power button twice.

- 5 Use the arrow buttons on the remote control to highlight any of the options on the Home screen that appears, then press the arrow button to select it. You can switch between projection sources and quickly access various adjustment options from this screen.

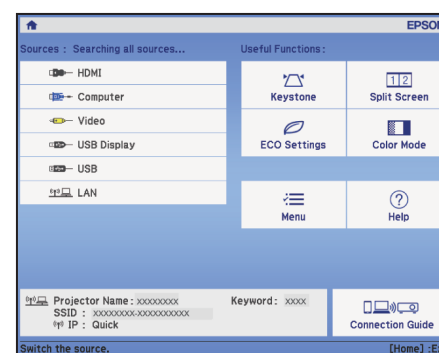

- 6 The default language of the menu system is English. To select another language, press the **Menu** button on the projector or remote control. Select **Extended** and press the arrow button. Select **Language** and press the arrow button. Select your language and press the arrow button. Press the **Menu** button to exit the menu system.



Adjust the image

- 1 If you don't see an image, press the **Source Search** button on the projector or remote control to select the image source.

Note: If you still see a blank screen or have other display problems, see the troubleshooting tips on the back of this sheet.

- 2 To raise the image, press the foot release button and lift the front of the projector. Release the button to lock the foot in position.

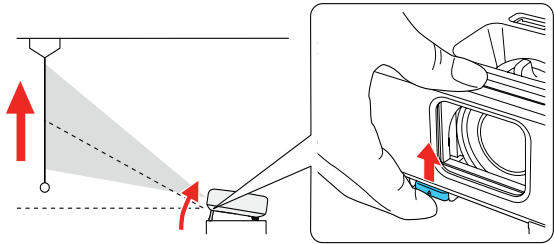

- 3 To reduce or enlarge the image, turn the zoom ring.

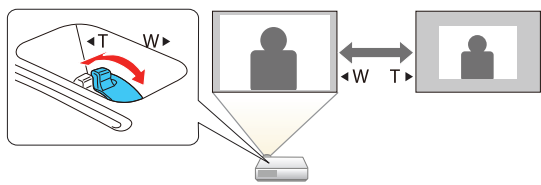

- 4 To sharpen the image, turn the focus ring.

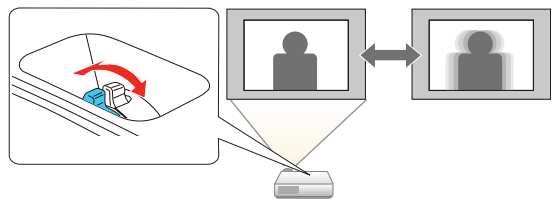

- 5 If your image looks like or , you may have placed the projector off to one side of the screen at an angle. Place the projector directly in front of the center of the screen, facing the screen squarely. If you can't move the projector, use the horizontal keystone slider on the projector to correct the image shape.

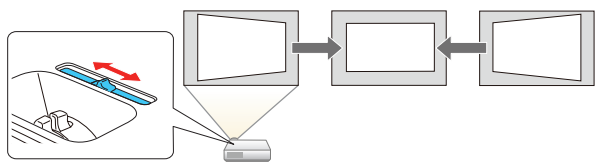

- 6 Your projector automatically adjusts images that look like or , but if necessary you can press the or button on the projector to correct it.

Using the remote control

Install the batteries as shown (two AA batteries).

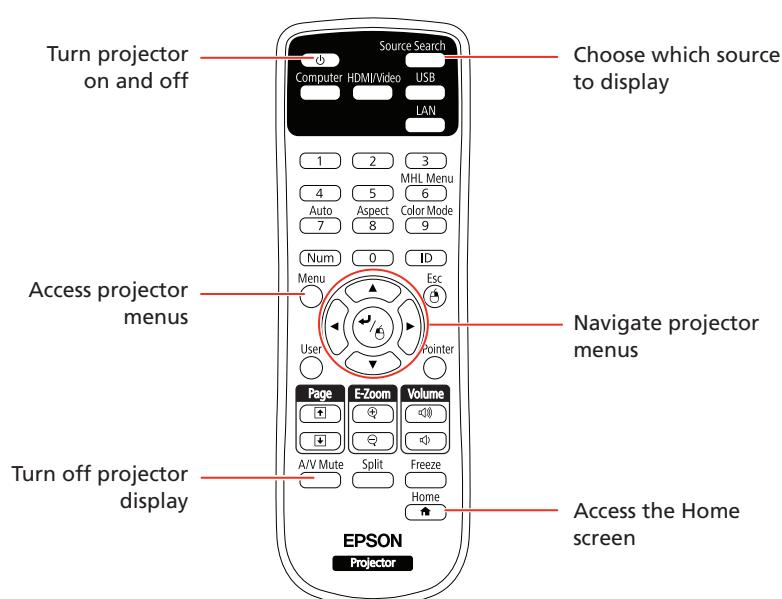
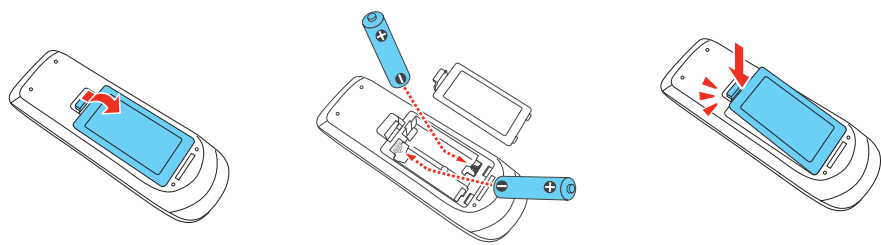

Setting up a wireless connection

- 1 Press the **Menu** button on the remote control.
- 2 Select the **Network** menu and press .
- 3 Select **Wireless LAN On** as the **Wireless Mode** setting.

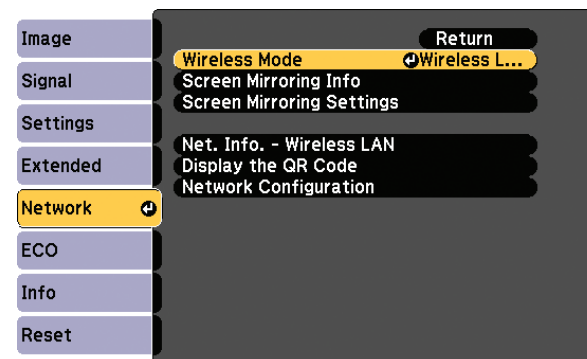

- 4 Select **Network Configuration** and press .
- 5 Select the **Wireless LAN** menu and press .

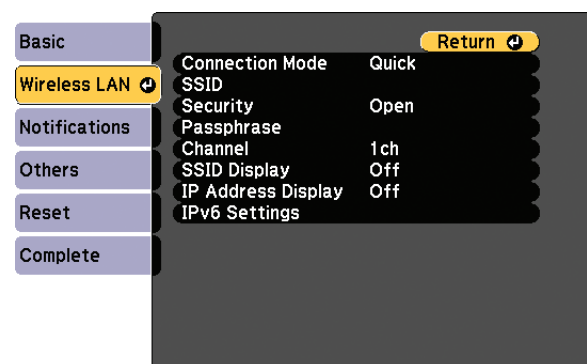

- 6 Select one of the following as the **Connection Mode** setting:
 - **Quick** for a direct connection to a computer, tablet, or smartphone.
 - **Advanced** to connect your projector to a router or access point.
- 7 Select any other settings on the Wireless LAN menu as necessary. See the online *User's Guide* for details.
- 8 When you finish selecting settings, select **Complete** and follow the on-screen instructions to save your settings and exit the menus.

Install the optional software

If you connected a computer to the projector, you can download and install optional software to perform various tasks wirelessly, such as monitoring or controlling your projector and projecting from multiple computers.

You can download the optional software and its manuals from the Epson website, as described in "Where to get help" on the back of this sheet or by installing the projector CD.

Note: The projector CD links you to the product's support page and gives you the option to install links on your desktop to the software manuals. An Internet connection is required.

Projecting from a mobile device

You can project wirelessly from a mobile device (iOS, Android™, or Chromebook™) using the Epson iProjection™ app and a QR code.

- 1 Download Epson iProjection from the Apple App Store, Google Play™, or Chrome Web Store.
- 2 If you connected the projector to a network wirelessly, make sure to connect your mobile device to the same network.
- 3 Press the **LAN** button on the remote control to display a QR code on the projector screen.
- 4 Start Epson iProjection on your mobile device.
- 5 Use the QR code reader feature to read the QR code displayed.



- 6 Follow the app instructions to connect your device to the projector.

For more information on setting up and using this app, visit www.epson.com/projectorapp.

Mirroring a mobile device

If your mobile device (laptop, smartphone, or tablet) supports Miracast®, you can project or mirror your device's screen wirelessly. You do not need any additional software to use this feature.

Note: Some restrictions apply. See the online *User's Guide* for details.

Select screen mirroring settings

- 1 Press the **Menu** button on the remote control.
- 2 Select the **Network** menu and press \swarrow/\ominus .
- 3 Select **Screen Mirroring On** as the **Wireless Mode** setting.

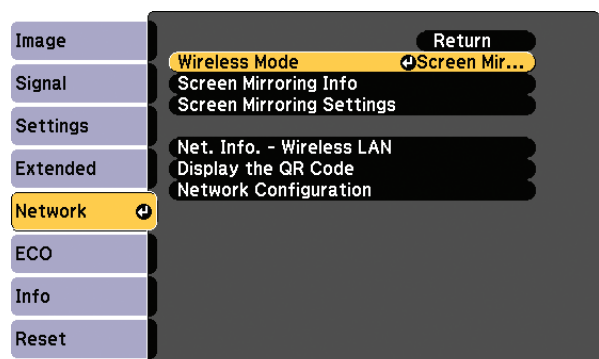

- 4 Select **Screen Mirroring Settings** and press \swarrow/\ominus .
- 5 Select any of the **Screen Mirroring Settings** options as necessary. See the online *User's Guide* for details.

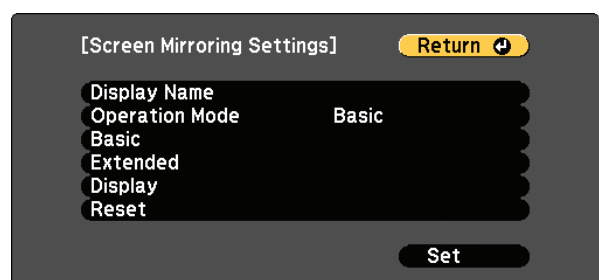

- 6 When you finish selecting settings, select **Set** and follow the on-screen instructions to save your settings and exit the menus.

Connect your device

- 1 Press the **LAN** button on the remote control. You see the Screen Mirroring standby screen.
- 2 Use the Miracast function on your device to search for the projector. You see a list of available devices.
Note: See your device's documentation for details on using its Miracast function.
- 3 If you see a PIN entry screen on your device, enter the PIN code displayed on the Screen Mirroring standby screen or at the bottom right of the projected image.

The projector displays the image from your device once a connection is established.

Caution: It may take some time to establish a connection. Do not disconnect the projector's power cord while it is connecting to your device. Doing so may cause your device to freeze or malfunction.

Troubleshooting

If you see a blank screen or the **No signal** message after turning on your computer or video device, check the following:

- Make sure the Status light on the projector is blue and not flashing, and the A/V Mute slide is open.
- Press the **Source Search** button on the projector or remote control to switch to the correct image source, if necessary.
- Press the **Home** button on the projector or remote control to verify the source input and settings.
- On Windows® 7 or later, hold down the Windows key and press **P** at the same time, then click **Duplicate**.
- If you're using a Windows laptop, press the function key on your keyboard that lets you display on an external monitor. It may be labeled **CRT/LCD** or have an icon such as \square/\square . You may have to hold down the **Fn** key while pressing it (such as **Fn + F7**). Wait a moment for the display to appear.
- If you're using a Mac laptop, open **System Preferences** and select **Displays**. Click the **Arrangement** tab and select the **Mirror Displays** checkbox.

Where to get help

Manuals

For more information about using the projector, click the icons on your desktop to access the online manuals (requires an Internet connection). If you don't see icons to the manuals, you can install them from the projector CD or go to the Epson website, as described below.

Internet support

Visit www.epson.com.jm/support for solutions to common problems. You can download utilities and documentation, get FAQs and troubleshooting advice, or e-mail Epson.

Telephone support services

You can also speak to a service technician by calling one of these numbers:

Argentina	(54 11) 5167-0300 0800-288-37766	Honduras**	800-0122 Code: 8320
Bolivia*	800-100-116	Mexico	01-800-087-1080
Chile	(56 2) 2484-3400	Mexico City	(52 55) 1323-2052
Colombia	018000-915235	Nicaragua*	00-1-800-226-0368
Bogota	(57 1) 523-5000	Panama*	00-800-052-1376
Costa Rica	800-377-6627	Paraguay	009-800-521-0019
Dominican Republic	1-888-760-0068	Peru	0800-10126
Ecuador*	1-800-000-044	Lima	(51 1) 418-0210
El Salvador*	800-6570	Uruguay	00040-5210067
Guatemala*	1-800-835-0358	Venezuela	(58 212) 240-1111

* Contact your local phone company to call this toll free number from a mobile phone.

** Dial the first 7 digits, wait for a message, then enter code.

If your country does not appear on the list, contact your nearest Epson sales office. Toll or long distance charges may apply.

Registration

Register today to get product updates and exclusive offers. You can use the CD included with your projector or go to your product support page at www.epson.com.jm/support and select **Registration**.

Optional accessories

For a list of optional accessories, see the online *User's Guide*.

You can purchase screens or other accessories from an Epson authorized reseller. To find the nearest reseller, contact Epson.

Notices

Wireless LAN Safety and Specifications

Contains wireless LAN module model: WLU5000-D101(RoHS)

This document provides safety instructions and describes the specifications. Read this document carefully before use to ensure your safety and product performance.

Data transmission is always initiated by software, which is then passed down through the MAC, through the digital and analog baseband, and finally to the RF chip. Several special packets are initiated by the MAC. These are the only ways the digital baseband portion will turn on the RF transmitter, which it then turns off at the end of the packet. Therefore, the transmitter will be on only while one of the aforementioned packets is being transmitted. In other words, this device automatically discontinues transmission in case of either absence of information to transmit or operational failure.

This equipment is restricted to indoor operation only.

U.S. FCC Notices

Contains FCC ID: BKMAE-WLU5000

This device complies with Part 15 of the FCC Rules. Operation is subject to the following two conditions: (1) This device may not cause harmful interference, and (2) this device must accept any interference received, including interference that may cause undesired operation.

This equipment has been tested and found to comply with the limits for a Class B digital device, pursuant to Part 15 of the FCC Rules. These limits are designed to provide reasonable protection against harmful interference in a residential installation. This equipment generates, uses and can radiate radio frequency energy and, if not installed and used in accordance with the instructions, may cause harmful interference to radio communications. However, there is no guarantee that interference will not occur in a particular installation. If this equipment does cause harmful interference to radio or television reception, which can be determined by turning the equipment off and on, the user is encouraged to try to correct the interference by one of the following measures:

- Reorient or relocate the receiving antenna.
- Increase the separation between the equipment and receiver.
- Connect the equipment into an outlet on a circuit different from that to which the receiver is connected.
- Consult the dealer or an experienced radio/TV technician for help.

Caution: Changes or modifications not expressly approved by the party responsible for compliance could void the user's authority to operate this equipment. Properly shielded and grounded cables and connectors must be used for connection to host computers and/or peripherals in order to meet FCC emission limits.

This transmitter must not be co-located or operating in conjunction with any other antenna or transmitter.

This equipment complies with FCC radiation exposure limits set forth for an uncontrolled environment and meets the FCC radio frequency (RF) Exposure Guidelines. This equipment should be installed and operated keeping the radiator at least 7.8 inches (20 cm) or more away from person's body.



EPSON and PowerLite are registered trademarks, Epson iProjection is a trademark, and EPSON Exceed Your Vision is a registered logomark of Seiko Epson Corporation.

Apple, App Store, Mac, and OS X are trademarks of Apple Inc., registered in the U.S. and other countries.

Android, Chromebook, and Google Play are trademarks of Google Inc.

General Notice: Other product names used herein are for identification purposes only and may be trademarks of their respective owners. Epson disclaims any and all rights in those marks.

This information is subject to change without notice.

© 2017 Epson America, Inc., 6/17