



# QUICK START GUIDE

MS-C8477-PC/MS-C8477-HPG1



User Manual



Smart Tools

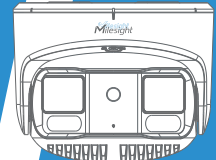
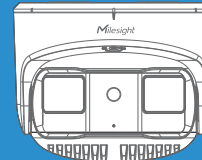

**Milesight** | *Make Sensing Matter*

📄 Milesight IoT Co., Ltd.    🌐 [www.milesight.com](http://www.milesight.com)

---

## Table of Content

1. Package Contents.....	2
2. Hardware Overview.....	2
3. Dimensions.....	3
4. Installation.....	4
5. Assigning an IP Address by Using Smart Tools.....	8
6. Assigning an IP Address via Browser.....	10
7. Accessing from the Web Browser.....	10
8. FCC Statement .....	11

## 1. Package Contents

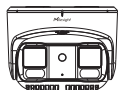

AI (TrueColor) Dual-sensor  
180° Panoramic Camera x 1



Water-proof  
Connector x 1



Quick Start Guide x 1



Warranty Card x 1



Screw Packet x 1

## 2. Hardware Overview



Microphone

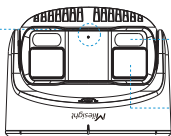

IR LED Lights & White Lights  
(Optional for TrueColor Model)

Lens

Vertical Limit Screw

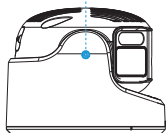

Reset



Micro SD/SDHC/  
SDXC Card Slot

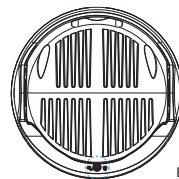

Horizontal Limit Screw

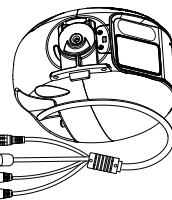

DC 12V  
Ethernet Port (PoE+)  
Audio Out  
Alarm In/Out

## 3. Dimensions

MS-C8477-PC/MS-C8477-HPG1

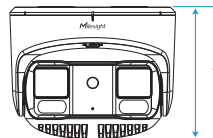

128

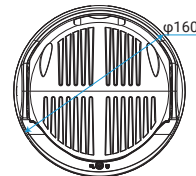

φ160

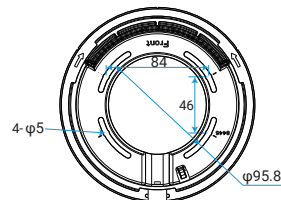

4-φ5

φ95.8

## 4. Installation

**Step1:** Rotate the camera unit to take off the camera mounting bracket.

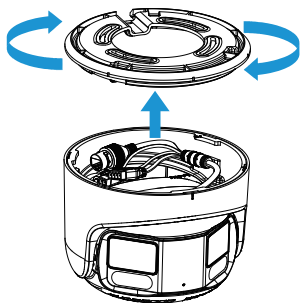

**Step2:** Fix the mounting bracket on the position by using the screw where the camera is intended to be installed.

Wall Mount (A72) and Pendant Mount (A76) are available for installation.

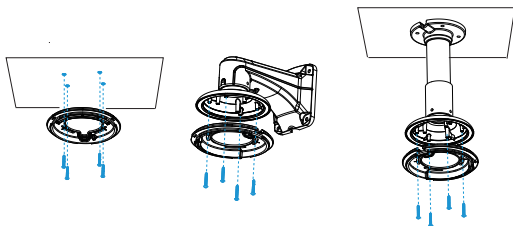

**Step3:** Hang the camera on the mounting bracket using wires and thread the tail cable of the device port into the mounting bracket.

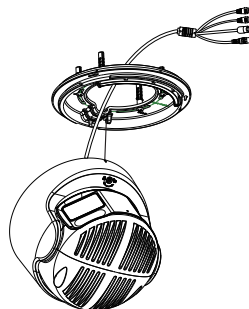

**Note:** If there is no hole in the wall, the tail cable needs to be pulled out from the side, please remove the plug from the slot and make sure the tail cable is in the side wire trough before tightening the mounting bracket screws.

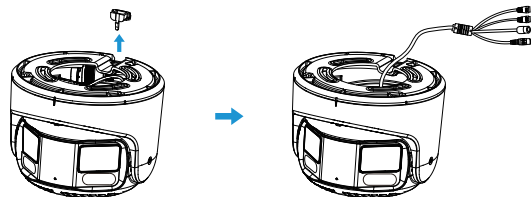

**Step4:** Install the camera to the mounting bracket by rotating it, ensure the installation marking is located between the two endpoints of the bracket mounting, and then tighten the horizontal limit screws.

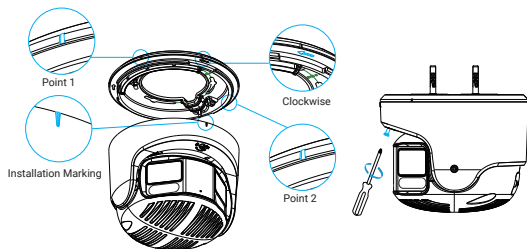

**Step5:** Adjust the camera position by loosening the vertical limit screw or rotating the camera to match the scene.

**Note:** You can adjust the camera angle as needed, the pan range is  $\pm 55^\circ$  and the tilt range is  $0\sim 90^\circ$ .

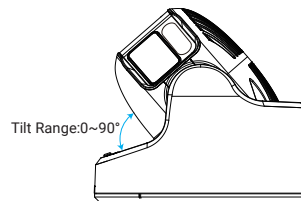
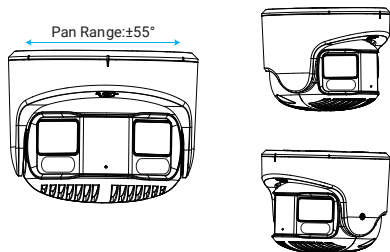

**Note:** Make sure the side of the camera is not too close to the wall or other objects.

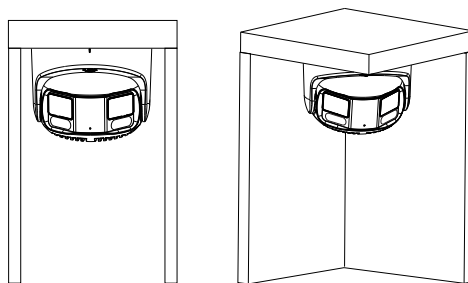

**Step6:** Finish the installation.



## 6. Assigning an IP Address via Browser

If the network segment of the computer and that of the camera are different, please add some 192.168.5.xx(255.255.255.0) for your PC to get access to your cameras, more details can be found on "Milesight Network Camera Quick Start".

## 7. Accessing from the Web Browser

The camera can be used with the most standard operating systems and browsers. The recommended browsers are Internet Explorer, Firefox, Chrome, Safari. More information about the plugin installation, please refer to the troubleshooting:

**5. Milesight-Troubleshooting-Plugin Installation on Windows-IPC**

**6. Milesight-Troubleshooting-Plugin Installation on MAC**

## 8. FCC Statement

Any changes or modifications not expressly approved by the party responsible for compliance could void the user's authority to operate the equipment. This device complies with part 15 of the FCC Rules. Operation is subject to the following two conditions:

1. This device may not cause harmful interference.
2. This device must accept any interference received, including interference that may cause undesired operation.

**Note:** This equipment has been tested and found to comply with the limits for a Class B digital device, pursuant to part 15 of the FCC Rules. These limits are designed to provide reasonable protection against harmful interference in a residential installation. This equipment generates, uses and can radiate radio frequency energy and, if not installed and used in accordance with the instructions, may cause harmful interference to radio communications. However, there is no guarantee that interference will not occur in a particular installation. If this equipment does cause harmful interference to radio or television reception, which can be determined by turning the equipment off and on, the user is encouraged to try to correct the interference by one or more of the following measures:

1. Reorient or relocate the receiving antenna.
2. Increase the separation between the equipment and the receiver.
3. Connect the equipment into an outlet on a circuit different from that to which the receiver is connected.
4. Consult the dealer or an experienced radio/TV technician for help.

### FCC Radiation Exposure Statement:

This equipment complies with FCC radiation exposure limits set forth for an uncontrolled environment. This equipment should be installed and operated with a minimum distance of 20cm between the radiator& your body. This transmitter must not be co-located or operating in conjunction with any other antenna or transmitter.

## **AI (TrueColor) Dual-sensor 180° Panoramic Camera**

Thank you  
for choosing  
Milesight Product