

## Fan Tray for 19 in. Racks - 1U, 6 120V High-Performance Fans, 576 CFM, C14 Inlet

MODEL NUMBER: SRFANTRAY6

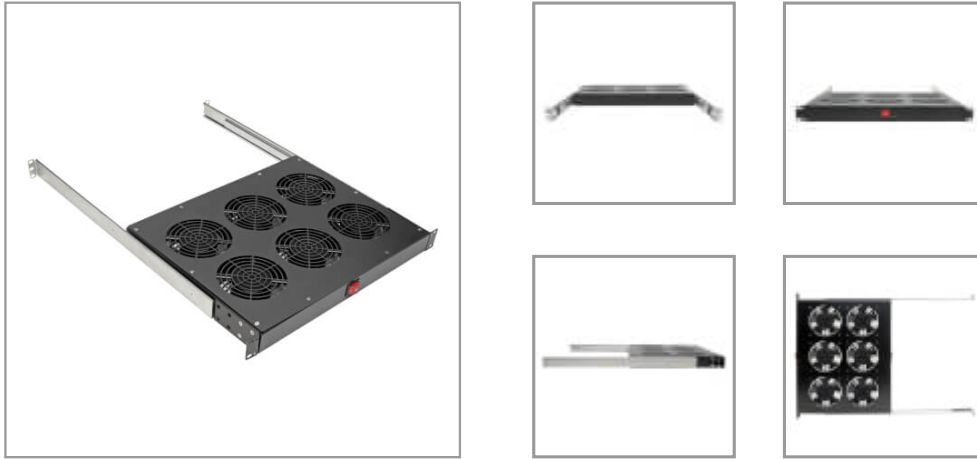

1U fan tray blows cool air through your rack enclosure to keep valuable equipment functioning efficiently without costly failures.

### Features

#### 6 High-Performance Fans Keep Equipment Cool in Crowded Server Rack Enclosures

The SRFANTRAY6 installs easily into 1U of space in an EIA-standard 19-inch rack cabinet. Six powerful four-inch 120V fans mount low in the rack and push cool air toward the top. These high-performance horizontal fans circulate air at 576 cubic feet per minute (CFM). The fan tray comes fully assembled using heavy-duty cold-rolled steel that's built to last through constant use. A rear C14 power inlet accepts an AC power cord (sold separately) that connects the fan tray to a conveniently located wall outlet, surge protector or PDU.

#### Better Rack Ventilation Helps Your Valuable Equipment Operate More Efficiently

This six-fan tray is ideal for maintaining a constant flow of cool air within your rack enclosure. Keeping your rack components cool helps boost system performance and avoid costly equipment failures that can lead to downtime, damage and data loss.

### Highlights

- Cools rack equipment to boost system performance and avoid costly downtime
- High-performance 4 in. 120V fans push cool air up through rack at 576 CFM
- Heavy-duty cold-rolled steel construction designed to last through constant use
- Rear C14 inlet accepts user-supplied power cable for convenient connection to outlet
- Mounts easily into 1U of space in your EIA-standard 19 in. rack enclosure

### Applications

- Direct cool air at servers, switches and other rack components to boost performance and extend operating life

### Package Includes

- SRFANTRAY6 1U Fan Tray for 19 in. Racks, 6 Fans
- Owner's manual

## Specifications

OVERVIEW	
UPC Code	037332214300
INPUT	
Nominal Input Voltage(s) Supported	120V AC
Nominal Input Voltage Description	120V 50/60 Hz
Input Plug Features	NEMA 5-15P



**Tripp Lite**  
1111 W. 35th Street  
Chicago, IL 60609 USA  
Telephone: 773.869.1234  
www.tripplite.com

Input Cord Length (ft.)	6
Input Cord Length (m)	1.83
<b>PHYSICAL</b>	
Shipping Dimensions (hwd / in.)	2.36 x 21.06 x 28.74
Shipping Dimensions (hwd / cm)	5.99 x 53.49 x 73.00
Shipping Weight (lbs.)	8.16
Shipping Weight (kg)	3.70
Unit Dimensions (hwd / in.)	1.73 x 18.90 x 25.820
Unit Dimensions (hwd / cm)	4.39 x 48.01 x 65.58
Unit Weight (lbs.)	7.270
Unit Weight (kg)	3.30
<b>SPECIAL FEATURES</b>	
Sound Level (Noise)	<= 45 dB
<b>WARRANTY</b>	
Product Warranty Period (Worldwide)	2-year limited warranty

© 2019 Tripp Lite. All rights reserved. All product and company names are trademarks or registered trademarks of their respective holders. Use of them does not imply any affiliation with or endorsement by them. Tripp Lite has a policy of continuous improvement. Specifications are subject to change without notice. Tripp Lite uses primary and third-party agencies to test its products for compliance with standards. See a list of Tripp Lite's testing agencies: <https://www.tripplite.com/products/product-certification-agencies>