

# Quick Setup

Before using the projector, make sure you read the safety instructions in the online *User's Guide*.

## Connect the projector

Choose from the following connections. See the sections below or the online *User's Guide* for details.

### Computer

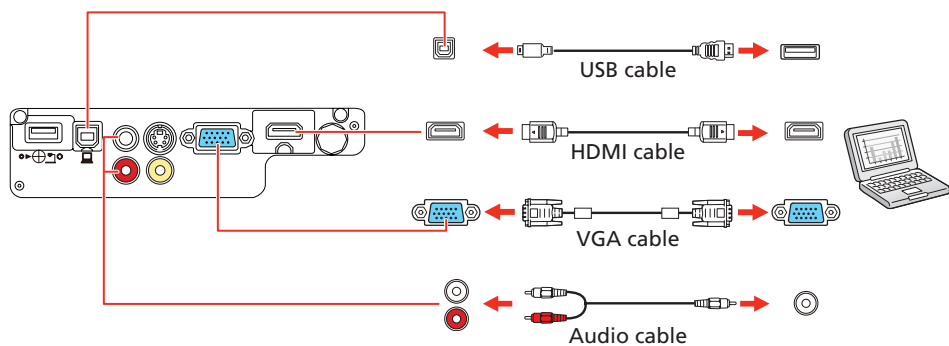

### USB port

Connect the square end of a USB cable to the projector's **USB-B** (square) port. Connect the flat end of the cable to any USB port on your computer.

**Windows® XP or later:** After turning on the projector, follow the on-screen instructions to install the Epson® USB Display software (**EMP\_UDSE.EXE**; only on first connection). If the software screen does not display automatically, open **My Computer** or **Computer**, then double-click **EPSON\_PJ\_UD**.

**OS X 10.5.8 or higher:** After turning on the projector, the setup folder for USB Display appears in the Finder. Double-click **USB Display Installer** and follow the on-screen instructions to install the Epson USB Display software (only on first connection).

**Note:** If you have problems installing the USB Display software, make sure the **USB Type B** setting in the projector's **Extended menu** is set to **USB Display**. See the online *User's Guide* for instructions.

### Computer port

Connect one end of a VGA cable to the projector's **Computer** port, and the other end to your computer's  monitor port. If you are using a laptop, switch it to external display (see "Troubleshooting"). You can also connect an audio cable.

### HDMI port

Connect one end of an HDMI cable to the projector's **HDMI** port and the other end to an HDMI port on your computer.

### Video device

Connect multiple video devices and use the **Source Search** button on the projector or the remote control to switch between them.

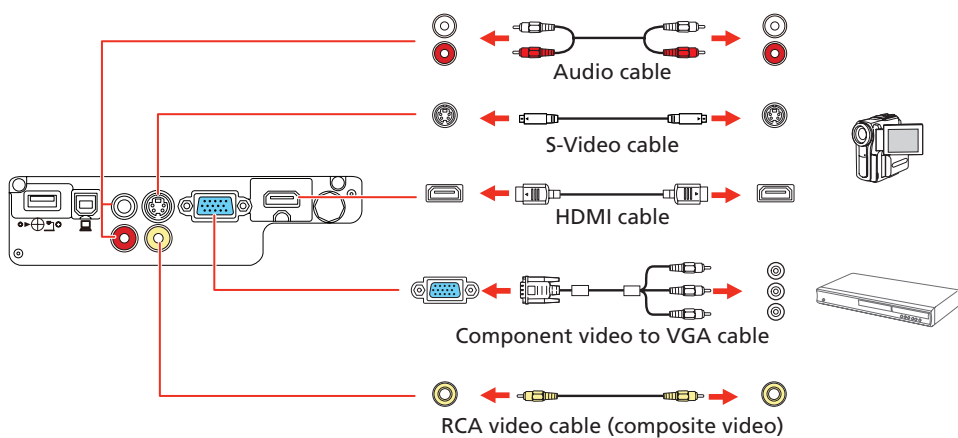

## Camera, USB device, or Epson DC-06 document camera

Connect a digital camera, USB flash drive, USB storage device, or Epson DC-06 document camera to the projector's **USB-A** (flat) port.

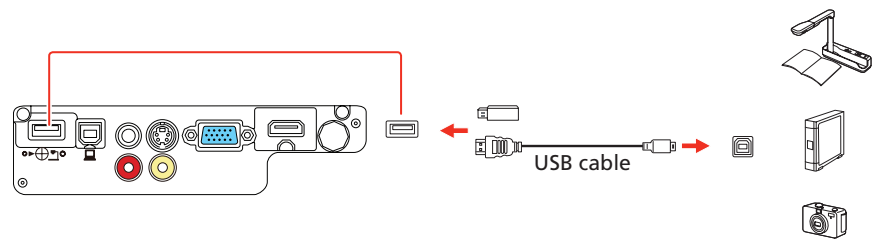

If you connect a digital camera, USB flash drive, or USB storage device, you can use the projector's PC Free feature. You can also connect other Epson document cameras to the projector. See the online *User's Guide* for details.

## Turn on your equipment

- 1 Turn on your computer or video source.
- 2 Plug in the projector. The  power light on the projector turns blue.

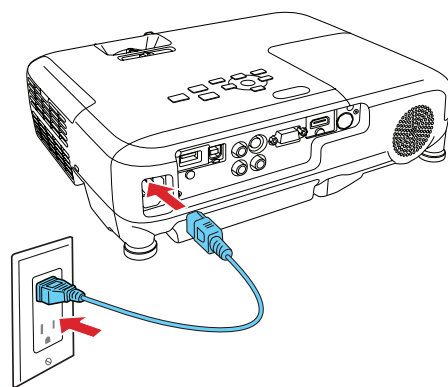

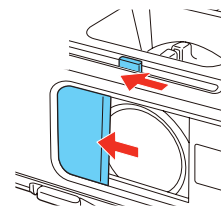

- 3 Open the **A/V Mute** slide all the way.

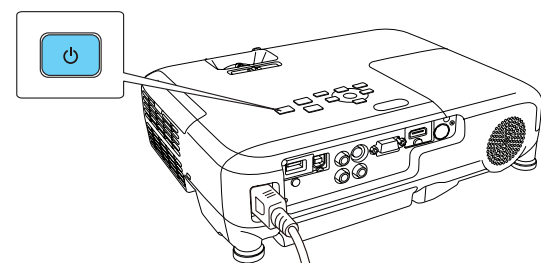

- 4 Press the  power button on the projector or remote control. The projector beeps, the Status light flashes blue, and then stays on.



**Note:** To shut down the projector, press the  power button twice, then unplug it. You don't have to wait for the projector to cool down.

- 5 Use the arrow buttons on the remote control to highlight any of the options on the Home screen that appears, then press  to select it. You can display a QR code, switch between projection sources, and quickly access various adjustment options from this screen.



- 6** The default language of the menu system is **English**. To select another language, press the **Menu** button on the projector or remote control. Select **Extended** and press  $\leftarrow/\rightarrow$ . Select **Language** and press  $\leftarrow/\rightarrow$ . Select your language and press  $\leftarrow/\rightarrow$ . Press the **Menu** button to exit the menu system.

## Adjust the image

- 1** If you don't see an image, press the **Source Search** button on the projector or the remote control to select the image source.
- Note:** If you still see a blank screen or have other display problems, see the troubleshooting tips on the back of this sheet.
- 2** To raise the image, press the foot release button and lift the front of the projector. Release the button to lock the foot in position.

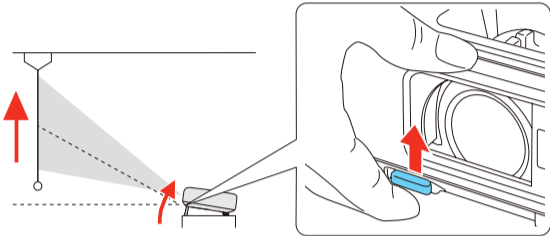

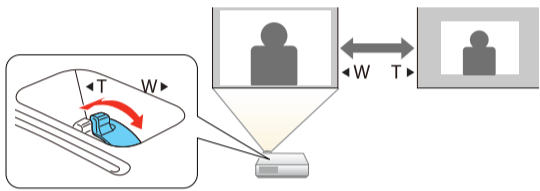

- 3** To reduce or enlarge the image, turn the zoom ring.



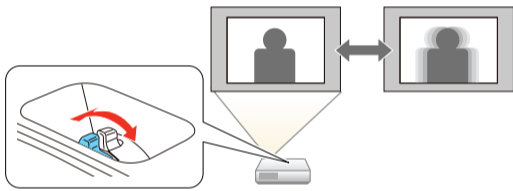

- 4** To sharpen the image, turn the focus ring.

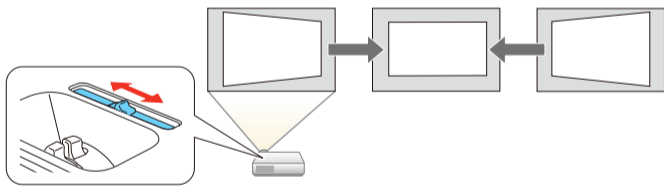

- 5** If your image looks like  or , you may have placed the projector off to one side of the screen at an angle. Place the projector directly in front of the center of the screen, facing the screen squarely. If you can't move the projector, use the horizontal keystone slider on the projector to correct the image shape.



- 6** Your projector automatically adjusts images that look like  or , but if necessary you can press the  $\nabla$  or  $\triangle$  button on the projector to correct it.

## Using the remote control

Install the batteries as shown (two AA batteries).

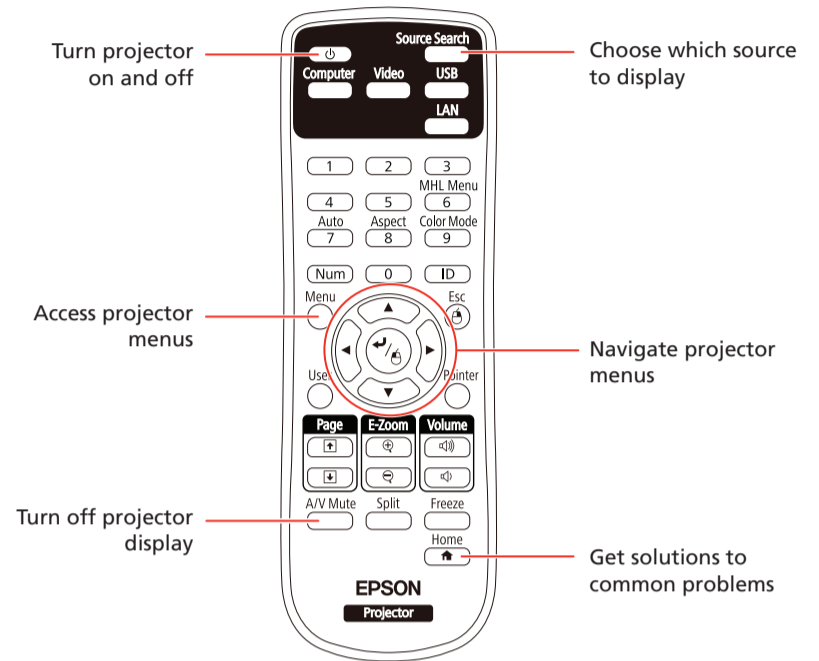
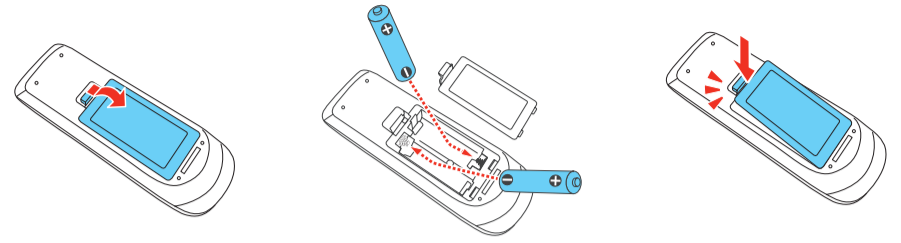

For more information on using the remote control, see the online *User's Guide*.

## Project wirelessly

To use the projector over a wireless network, connect the Epson 802.11b/g/n wireless LAN module to the projector, then follow the steps here to connect the projector over a wireless network.

If you're projecting from a computer, it must have a wireless card or built-in wireless interface, and be running Windows 8, Windows 7, Windows Vista®, Windows XP Professional x64, or Windows XP, or OS X 10.5.8 to 10.10.x.

- 1** Connect the wireless LAN module to the **USB-A** (flat) port.

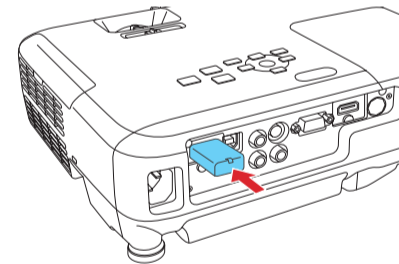

- 2** Press the **Menu** button on the remote control, select the **Network** menu, and press  $\leftarrow/\rightarrow$ .

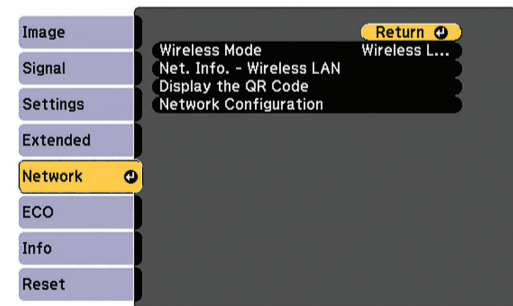

- 3** Choose **Network Configuration** and press  $\leftarrow/\rightarrow$ .

- 4 Select the **Wireless LAN** menu and press  $\leftarrow/\rightarrow$ .

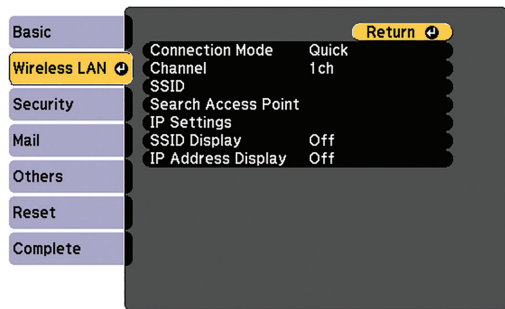

- 5 Choose **Connection Mode**, press  $\leftarrow/\rightarrow$ , select **Quick** (for a direct connection to a computer, tablet, or smartphone) or **Advanced** (for a connection to a router or access point), then press  $\leftarrow/\rightarrow$  again. When you're finished, press **Esc** to return to the Wireless LAN menu.
- 6 If you chose the Advanced connection mode, select **Search Access Point** and press  $\leftarrow/\rightarrow$ . Use the arrow buttons to highlight your network name (SSID) in the list of available connections and press  $\leftarrow/\rightarrow$ .
- 7 If your network has security enabled, enter your network password on the screen that appears. Make sure to enter any uppercase or lowercase letters in the correct case.

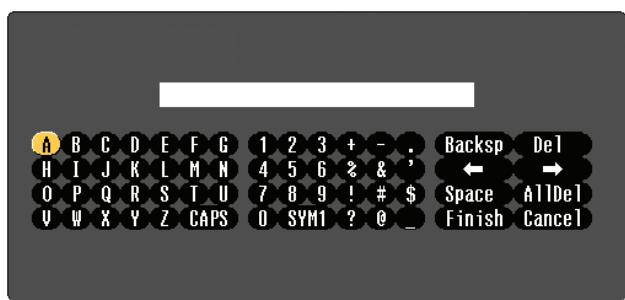

- To select a number or character, use the arrow buttons on the remote control to highlight it, then press  $\leftarrow/\rightarrow$ .
- To switch between uppercase and lowercase letters, select **CAPS** and press  $\leftarrow/\rightarrow$ .
- To change the displayed symbols, select **SYM1** or **SYM2** and press  $\leftarrow/\rightarrow$ .

When you're finished entering the network password, select **Finish** and press  $\leftarrow/\rightarrow$ .

- 8 If you chose the Advanced connection mode, select **IP Settings** and press  $\leftarrow/\rightarrow$ .
- If your network assigns addresses automatically, make sure **DHCP** is turned on. If not, turn off **DHCP** and enter the projector's **IP Address**, **Subnet Mask**, and **Gateway Address**, as needed.
- 9 To prevent the SSID and IP address from appearing on the network standby screen, set the **SSID Display** and **IP Address Display** settings to **Off**.
- 10 When you're finished selecting settings in the Wireless LAN menu, press **Esc**.
- 11 Select **Complete** and press  $\leftarrow/\rightarrow$ , then select **Yes** and press  $\leftarrow/\rightarrow$  again to save your settings.
- 12 See "Install network software" for additional instructions.

## Install network software

Install links to download the network software and manuals from the projector CD. Downloads require an Internet connection. You can also install the software and manuals from the Epson website, as described in "Where to get help."

To project over the network, install the EasyMP® Network Projection software on each computer you will project from. To monitor and control your projector over the network, install the EasyMP Monitor software (Windows only). To project from multiple PCs over the network, install the EasyMP Multi PC Projection software.

Click the icons on your desktop to download and install the software and their manuals. See the manuals for instructions on installing and using the software.

# Project wirelessly from a mobile device

You can connect your mobile device and projector using Epson iProjection™ and a QR code. Make sure the wireless LAN module is installed in your projector and the latest version of Epson iProjection is installed on your device.

## Install the Epson iProjection app

To project from an iOS or Android™ device, download and install the Epson iProjection app. Visit [epson.com/projectorapp](http://epson.com/projectorapp) for more information.



## Direct wireless connection

Make sure your device and Epson projector are not connected to a network and your Epson projector's **Connection Mode** is set to **Quick**.

- 1 Tap **iProjection** on your device's Home screen.
- 2 Tap **Projector** to open the Search Projector menu.

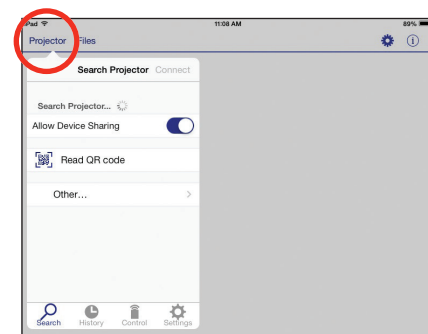

- 3 Tap **Read QR code**.
- 4 Point your device's camera at the QR code your projector displays; the QR code is read automatically.
- 5 Tap **OK** to register your projector's Wi-Fi profile.
- 6 Tap **Install** to install your projector's Wi-Fi profile.
- 7 Tap **Install Now** at the Unsigned Profile notification.
- 8 Tap **Done** to exit the Profile Installed screen.
- 9 Tap **OK** to confirm the connection to the projector.
- 10 Note the projector network name (SSID) shown on your device's screen. Then go to the Wi-Fi settings on your device to select that network.

Your device and Epson projector are now connected.

## Network connection

Make sure your projector and mobile device are connected to the same network.

- 1 Tap **iProjection** on your device's Home screen.
- 2 Tap **Projector** to open the Search Projector menu.

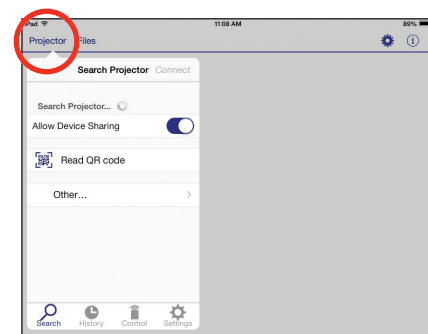

- 3 Tap **Read QR code**.
- 4 Point your device's camera at the QR code your projector displays; the QR code is read automatically.

Your device and Epson projector are now connected.

# Troubleshooting

If you see a blank screen or the **No signal** message after turning on your computer or video device, check the following:

- Make sure the Status light on the projector is blue and not flashing, and the A/V Mute slide is open.
- Press the **Source Search** button on the projector or the remote control to switch to the correct image source, if necessary.
- If you're using a Windows laptop, press the function key on your keyboard that lets you display on an external monitor. It may be labeled **CRT/LCD** or have an icon such as . You may have to hold down the **Fn** key while pressing it (such as **Fn + F7**). Wait a moment for the display to appear.
- If you're using a Mac laptop, open **System Preferences** and select **Displays**. Click the **Arrangement** tab and select the **Mirror Displays** checkbox.

# Where to get help

## Manuals

For more information about using the projector, click the icons on your desktop to access the online manuals (requires an Internet connection). If you don't see icons to the manuals, you can install them from the projector CD or go to the Epson website, as described below.

## Telephone support services

You can also speak to a service technician by calling one of these numbers:

<b>Argentina</b>	(54 11) 5167-0300 0800-288-37766	<b>Honduras**</b>	800-0122 Code: 8320
<b>Bolivia*</b>	800-100-116	<b>Mexico</b>	01-800-087-1080
<b>Chile</b>	(56 2) 2484-3400	<b>Mexico City</b>	(52 55) 1323-2052
<b>Colombia</b>	018000-915235	<b>Nicaragua*</b>	00-1-800-226-0368
<b>Bogota</b>	(57 1) 523-5000	<b>Panama*</b>	00-800-052-1376
<b>Costa Rica</b>	800-377-6627	<b>Paraguay</b>	009-800-521-0019
<b>Dominican Republic*</b>	1-888-760-0068	<b>Peru</b>	0800-10126
<b>Ecuador*</b>	1-800-000-044	<b>Lima</b>	(51 1) 418-0210
<b>El Salvador*</b>	800-6570	<b>Uruguay</b>	00040-5210067
<b>Guatemala*</b>	1-800-835-0358	<b>Venezuela</b>	(58 212) 240-1111

\* Contact your local phone company to call this toll free number from a mobile phone.

\*\* Dial the first 7 digits, wait for a message, then enter code.

If your country does not appear on the list, contact your nearest Epson sales office. Toll or long distance charges may apply.

## Internet support

Visit [global.latin.epson.com/Soporte](http://global.latin.epson.com/Soporte) for solutions to common problems. You can download utilities and documentation, get FAQs and troubleshooting advice, or e-mail Epson (website available in Spanish only).

## Registration

Register today to get product updates and exclusive offers. You can use the CD included with your projector or register online at [global.latin.epson.com/Soporte](http://global.latin.epson.com/Soporte) then select **Registre su producto** (website available in Spanish only).

# Optional accessories

For a list of optional accessories, see the online *User's Guide*.

You can purchase screens or other accessories from an Epson authorized reseller. To find the nearest reseller, contact Epson.

# Wireless notice

Wireless LAN 802.11b/g/n adapter

Model: WN7522BEP

This document provides safety instructions and describes the specifications. Read this document carefully before use to ensure your safety and product performance.

Changes or modifications not expressly approved by the party responsible for compliance could void the user's authority to operate this equipment. This equipment should be installed and operated keeping the radiator at least 20cm or more away from person's body. This device is restricted to indoor operations only.

**EPSON**  
EXCEED YOUR VISION



EPSON, PowerLite, and EasyMP are registered trademarks, Epson iProjection is a trademark, and EPSON Exceed Your Vision is a registered logomark of Seiko Epson Corporation.

Mac and OS X are trademarks of Apple Inc., registered in the U.S. and other countries.

Android is a trademark of Google Inc.

General Notice: Other product names used herein are for identification purposes only and may be trademarks of their respective owners. Epson disclaims any and all rights in those marks.

This information is subject to change without notice.

© 2015 Epson America, Inc., 4/15

Printed in XXXXXX

CPD-42721