

650183 17"-35" Heavy-Duty Dual Monitor Desk Mount Bracket, White

Product Images

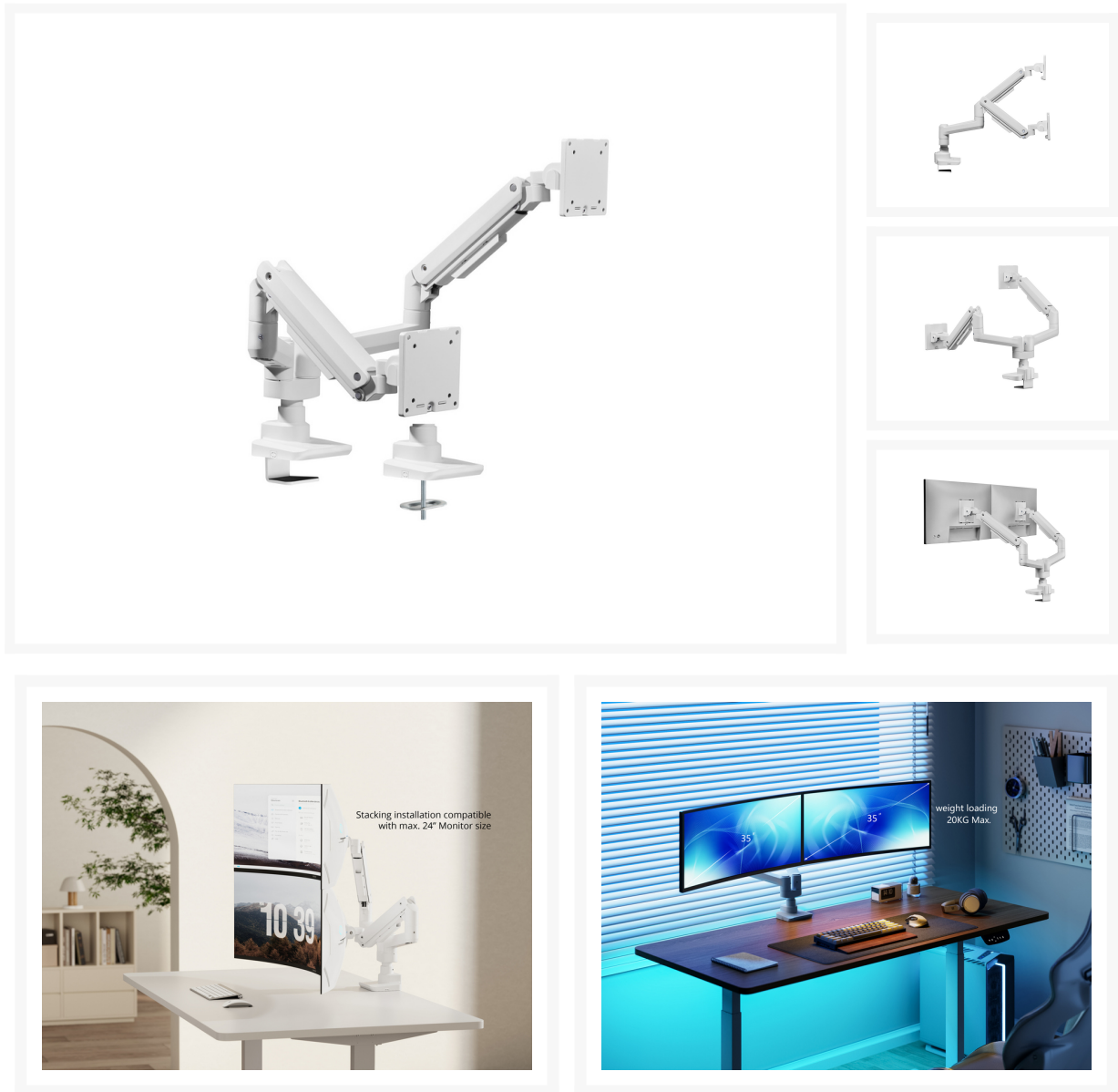

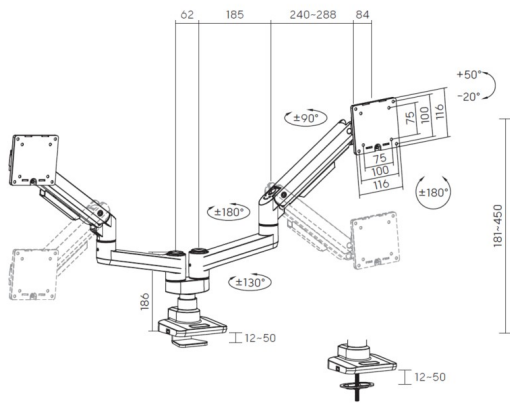

- Max. Load Capacity: 20Kg (per screen)
- Max. VESA: 100x100
- Sturdy and lightweight aluminum construction
- Gas spring structure offers perfect counterbalance presentation in all directions
- Built-in spring tension gauge can be easily adjusted to fit varied weights on the arm
- VESA standards compliant
- Free-tilting design for multiple monitor viewing angles
- Detachable VESA Plate Design
- Cable clips keep cables organized and protected

The Equip 650183 17"-35" Heavy-Duty Dual Monitor Desk Mount Bracket is a robust and versatile solution for organizing and optimizing your workspace. This heavy-duty mount is specifically designed to support dual monitors ranging from 17 inches to 35 inches in size, making it an ideal choice for users who require durability and stability for larger dual-display configurations.

Featuring a sturdy construction, the heavy-duty dual monitor desk mount bracket ensures stability and secure support for monitors with varying weights. The dual-arm design allows for independent movement of each monitor, providing flexibility in positioning and enabling optimal ergonomic arrangements. Whether you're a professional multitasking with multiple applications or a gamer seeking an immersive dual-monitor experience, this mount caters to a variety of needs.

Additional Information

| | |
|-------------------------------|--|
| Harmonized System (HS) code | 852990 |
| Customs product code (TARIC) | 8529909700 |
| Approval and Compliance | RoHS & REACH |
| Package Contents | Desk Mount Bracket User Manual Screws kits |
| Color | White |
| EAN | 4015867236086 |
| Model Number | 650183 |
| Cable management | Yes |
| Pipe Size (Pole height) | 186mm |
| Quick Installation VESA Plate | Yes |
| Compatible Display Size | 17"-35" |
| Installation | Clamp,Grommet |
| Load Capacity (kg) | 20kg |
| Material | Plastic, Stainless Steel, Aluminum |
| Mount | Desk mount |
| Pan (Swivel) range | 90°~90° |
| Screen Rotation | +180°~-180° |
| Screens support quantity | 2 |
| Support Curved TV (Monitors) | Yes |
| Tilt range | +50°~-20° |
| VESA compatibility | 75x75,100x100 |
| Dimensions (W x D x H) | 1033 x 133 x 530 mm |
| Product weight (kg) | 6.42 |

