

Overview

- 4MP (2688 x 1520)
- 2.8-12mm motorized lens
- Built-in IR-LED up to 40 m (131 ft.)
- WDR 120dB
- H.265, H.264 and MJPEG
- Built-in Microphone
- IP67
- ONVIF Profile G, S, T
- NDAA Compliant



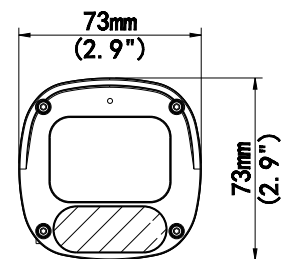
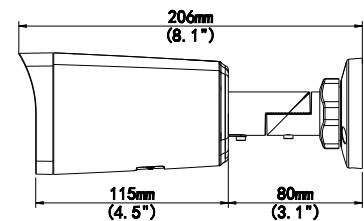
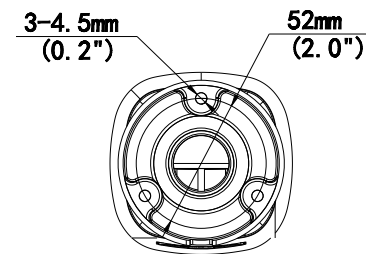

Technical Specifications

Camera	
Image Sensor	1/3" Progressive Scan CMOS
Minimum Illumination	Color: 0.003Lux (F1.6, AGC ON) 0Lux with IR
Shutter Speed	Auto/Manual, 1 ~ 1/100000s
Dynamic Range	120 dB
S/N	> 52 dB
Built-in IR-LED	Up to 50m (164ft.), Wavelength: 850nm
Lens	
Focal Length	2.8~12mm, Motorized Zoom/Auto Focus
Angular Field of View	H: 86.3°~35.2°, V: 47.1°~17.0°, D: 91.9°~38.6°
Angle Adjustment	Pan: 0° ~ 360°, Tilt: 0° ~ 90°, Rotate: 0° ~ 360°
Video	
Resolution and Max. frame rate	Mainstream: 2688x1520, 2560x1440 @25/20fps, 2304*1296, 1920*1080, 1280x720 @30/25fps Sub Stream: 1280x720, 720x576, 640x360 @30/25fps
Image Rotation	Flip Vertical/Flip Horizontal/180°/90°Clockwise/90°Anti-clockwise
Image Settings	White Balance, Digital NR, Smart IR, HLC, BLC, Digital Defog
Privacy Zone	Up to 4 areas
Camera Title (OSD)	Up to 40 characters * 4 lines
Analytics	Cross line, Intrusion (based on Human Body Detection), Motion Detection, Tampering Alarm, Audio Detection
ROI	Up to 8 areas for ensuring image quality
Video Compression	H.265, H.264, MJPEG
No. of Stream settings	2 Streams



Technical Specifications

DORI	
Detect (25ppm/8ppf)	63m {206.7ft.} (WIDE), 270.0m {885.8ft.} (TELE)
Observe (62.5ppm/19ppf)	25.2m {82.7ft.} (WIDE), 108.0m {354.3ft.} (TELE)
Recognize (125ppm/38ppf)	12.6m {41.3ft.} (WIDE), 54.0m {177.2ft.} (TELE)
Identify (250ppm/76ppf)	6.3m {20.7ft.} (WIDE), 27.0m {88.6ft.} (TELE)
Network	
Supported Protocol	IPv4, IGMP, ICMP, ARP, TCP, UDP, DHCP, RTP, RTSP, RTCP, RTMP, DNS, DDNS, NTP, FTP, UPnP, HTTP, HTTPS, SMTP, SSL/TLS, QoS, SNMP, 802.1X
Secure	Password protection, HTTPS, Operation logs, Digest authentication for RTSP, HTTP, TLS 1.2, WSSE and ONVIF, IP address filtering, ARP protection, MAC authentication, Illegal Login Lock, Session Timeout, Watermark
ONVIF® Profile	S / G / T
Interface	
Network Interface	10BASE-T/100BASE-TX, RJ45 connector
Audio Input	Built-in Microphone / Line Input: impedance 35kΩ; amplitude 2V [p-p]. Codec: G.711U, G.711A
Audio Output	impedance 600Ω; amplitude 2V [p-p]
External I/O Terminals	1/1
SD Memory Card Slot	microSD, up to 256GB
General	
Safety	UL (UL 62368-1), c-UL (CSA C22.2 No. 62368-1), CE, IEC62368-1
EMC	FCC (part15 Class A), EN55032, EN55035
Power Source	PoE (IEEE 802.3af) / DC 12V±25%, Ø 5.5mm coaxial power jack
Power Consumption	Max. 9.6W
Ambient Operating Conditions	Temperature: -30°C ~ 60°C (-22°F ~ 140°F), Humidity: ≤95% RH (non-condensing)
Water and Dust Resistance	IP67
Shock Resistance	–
Dimensions	206mm × 73mm × 73mm (8.1" × 2.9" × 2.9")
Mass (approx.)	0.51kg (1.12lb)
Finish	Main Body: Graphene and Metal
License	Videolnsight VMS Camera License Bundled
Optional Accessories	<div style="display: flex; justify-content: space-around; align-items: center;"> <div style="text-align: center;"> <p>M-JB-MINI-B</p>  </div> <div style="text-align: center;"> <p>M-PM-B</p>  </div> </div>