

OptiPlex 7490 All-In-One

Setup and Specifications



Notes, cautions, and warnings

 **NOTE:** A NOTE indicates important information that helps you make better use of your product.

 **CAUTION:** A CAUTION indicates either potential damage to hardware or loss of data and tells you how to avoid the problem.

 **WARNING:** A WARNING indicates a potential for property damage, personal injury, or death.

Contents

Chapter 1: Set up your OptiPlex 7490 All-in-One.....	4
Chapter 2: Views of OptiPlex 7490 All-in-One.....	12
Front.....	12
Retractable camera.....	13
Left.....	14
Right.....	15
Back.....	16
Bottom.....	17
Inside view of your computer.....	18
System board layout.....	20
Chapter 3: Specifications of OptiPlex 7490 All-in-One.....	21
Dimensions and weight.....	21
Processor.....	21
Chipset.....	22
Operating system.....	23
Memory.....	23
Memory configuration matrix.....	24
External ports.....	25
Internal slots.....	25
Ethernet.....	25
Wireless module.....	26
Audio.....	26
Storage.....	27
Intel Optane memory.....	27
Media-card reader.....	28
Camera.....	28
Power ratings.....	29
Power supply connectors.....	30
Display.....	30
GPU—Integrated.....	31
GPU—Discrete.....	32
Environmental.....	32
Regulatory.....	32
Operating and storage environment.....	33
Chapter 4: Getting help and contacting Dell.....	34

Set up your OptiPlex 7490 All-in-One

NOTE: The images in this document may differ from your computer depending on the configuration you ordered.

1. Set up the stand.



Figure 1. Articulating stand

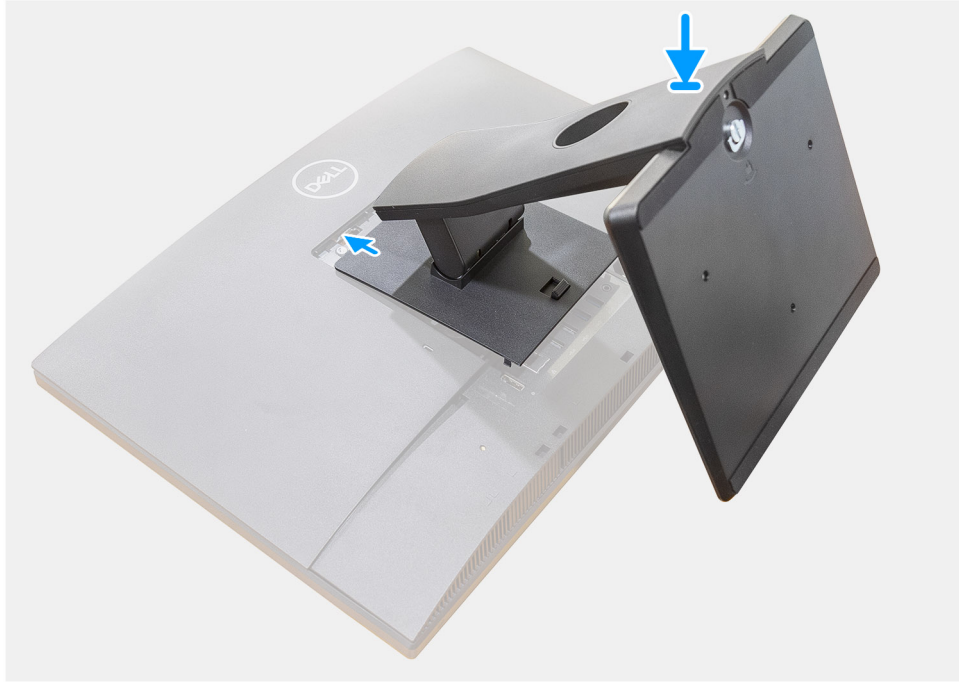

Figure 2. Fixed stand



Figure 3. Height Adjustable Stand

i **NOTE:** Follow the same procedure to install the Height Adjustable Stand with Optical Disk Drive.

2. Set up the keyboard and mouse.

i **NOTE:** For setup instructions, see the documentation shipped with the keyboard and mouse.



3. Route the power cable through the stand, then connect the power cable.

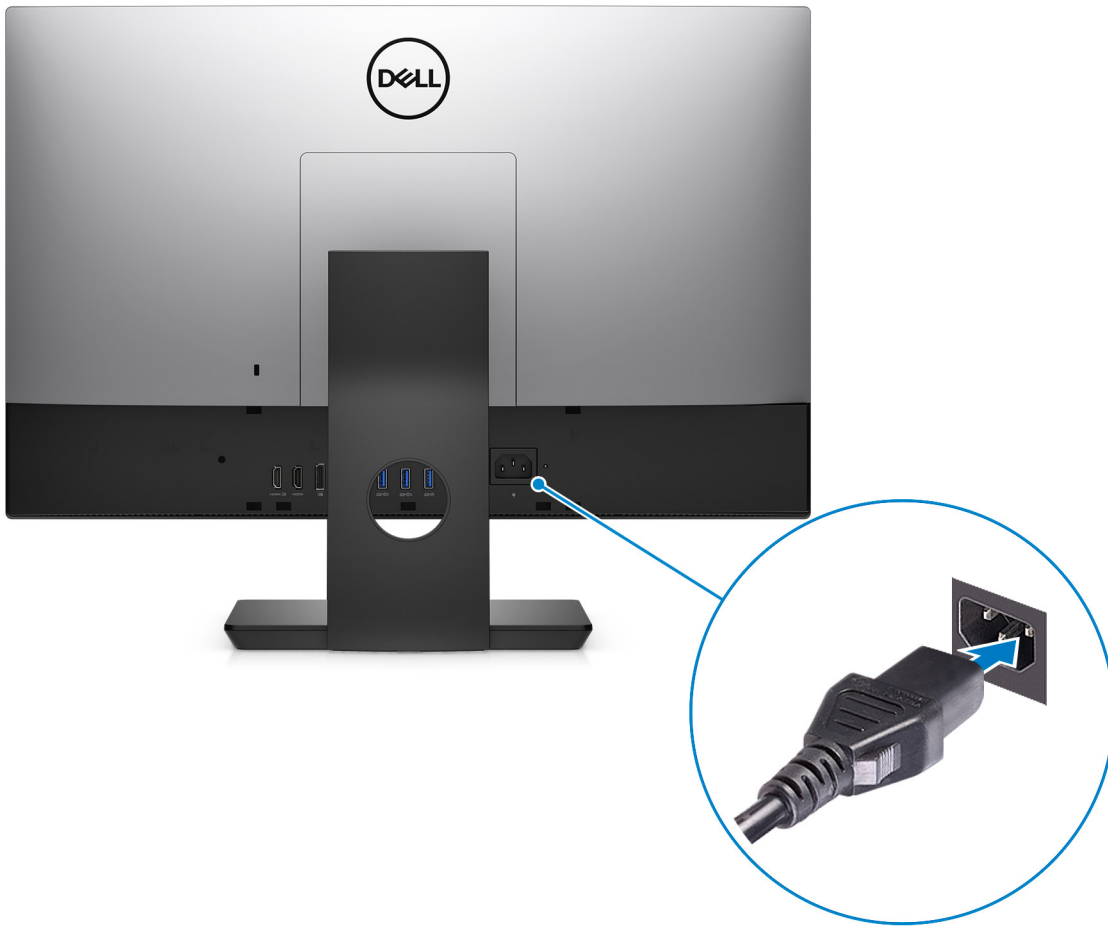

4. Press the power button.



5. Finish operating system setup.

For Ubuntu:

Follow the on-screen instructions to complete the setup. For more information about installing and configuring Ubuntu, see the knowledge base articles [SLN151664](#) and [SLN151748](#) at www.dell.com/support.

For Windows:

Follow the on-screen instructions to complete the setup. When setting up, Dell recommends that you:

- Connect to a network for Windows updates.

NOTE: If connecting to a secured wireless network, enter the password for the wireless network access when prompted.

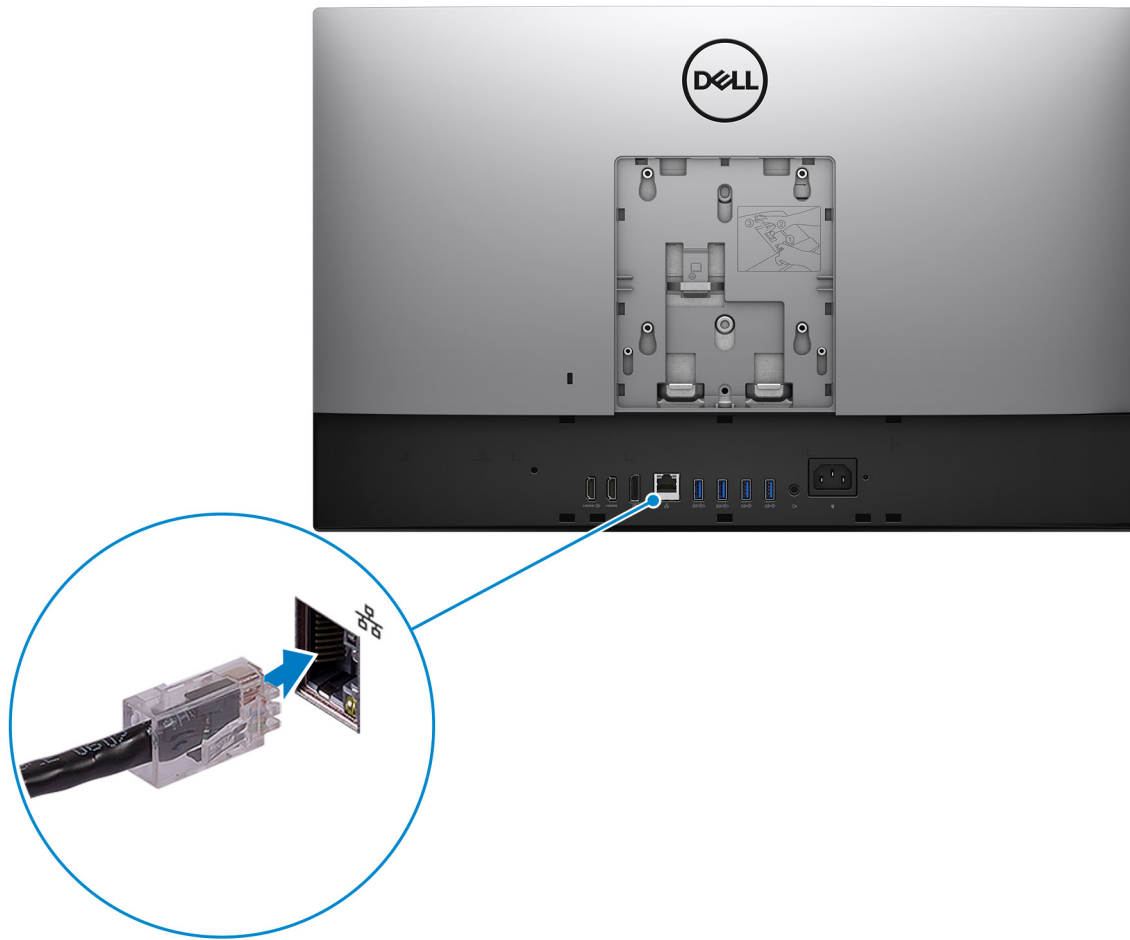

- If connected to the internet, sign-in with or create a Microsoft account. If not connected to the internet, create an offline account.
- On the **Support and Protection** screen, enter your contact details.

6. Locate and use Dell apps from the Windows Start menu—Recommended.

Table 1. Locate Dell apps







Resources	Description
	<p>Dell Product Registration</p> <p>Register your computer with Dell.</p>
	<p>Dell Help & Support</p> <p>Access help and support for your computer.</p>
	<p>SupportAssist</p> <p>SupportAssist is the smart technology that keeps your computer running at its best by optimizing settings, detecting issues, removing viruses and notifies when you need to make system updates. SupportAssist proactively checks the health of your system's hardware and software. When an issue is detected, the necessary system state information is sent to Dell to begin troubleshooting. SupportAssist is preinstalled on most of the Dell devices running Windows operating system. For more information, see SupportAssist for Home PCs User's Guide on www.dell.com/serviceabilitytools.</p> <p> NOTE: In SupportAssist, click the warranty expiry date to renew or upgrade your warranty.</p>

Table 1. Locate Dell apps (continued)

Resources	Description
	<p>Dell Update</p> <p>Updates your computer with critical fixes and latest device drivers as they become available. For more information about using Dell Update, see the knowledge base article SLN305843 at www.dell.com/support.</p>
	<p>Dell Digital Delivery</p> <p>Download software applications, which are purchased but not pre-installed on your computer. For more information about using Dell Digital Delivery, see the knowledge base article 153764 at www.dell.com/support.</p>

Views of OptiPlex 7490 All-in-One

Front

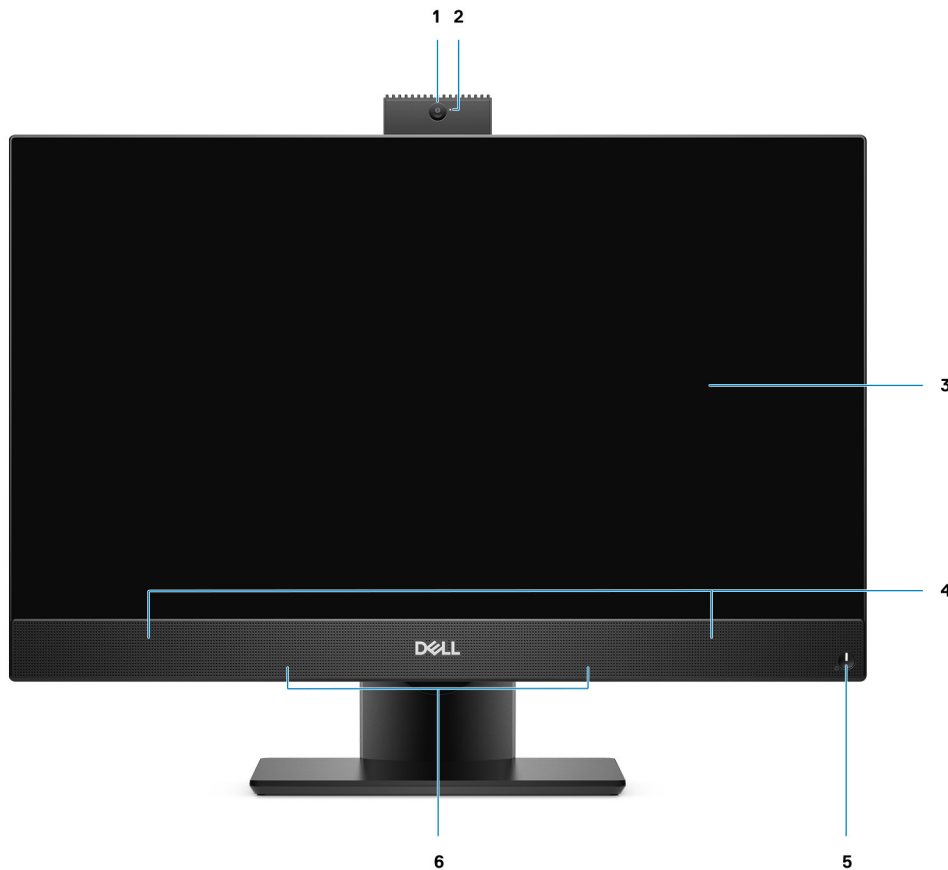

1. Full HD webcam
2. Camera-status light
3. Display
4. Speakers
5. Power button/power-status indicator
6. Array microphones

Retractable camera

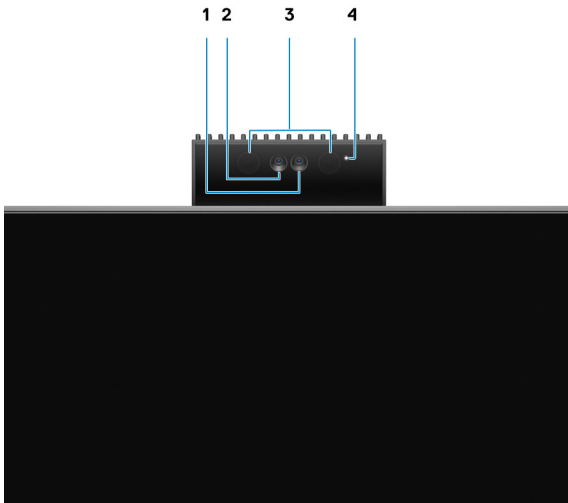

NOTE: Depending on the configuration ordered, your computer will have only RGB camera or both RGB camera and Infrared camera.

1. Full HD camera
2. Infrared camera
3. Infrared emitter
4. Camera-status light

Left

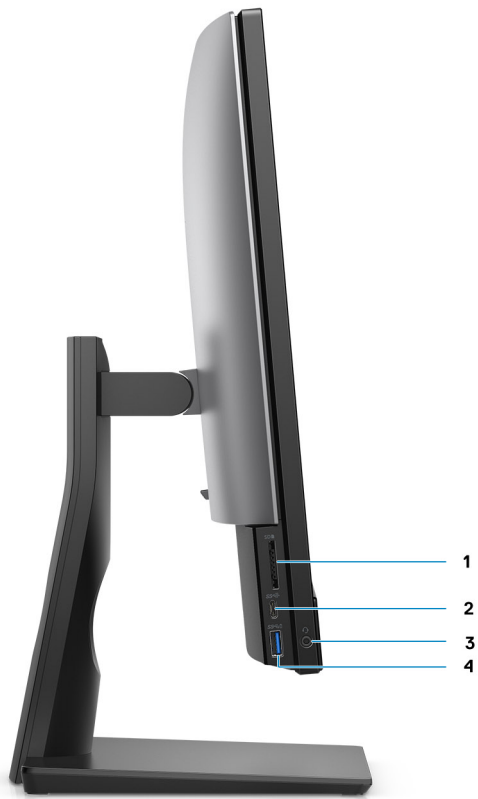

1. SD 4.0 card slot
2. USB 3.2 Gen 2x2 capable Type-C port
3. Universal audio port
4. USB 3.2 Gen 1 port with PowerShare

Right



1. Hard-drive status indicator

Back



1. Back cover
2. Stand cover
3. Kensington security-cable slot
4. Bottom cover
5. Stand

Bottom

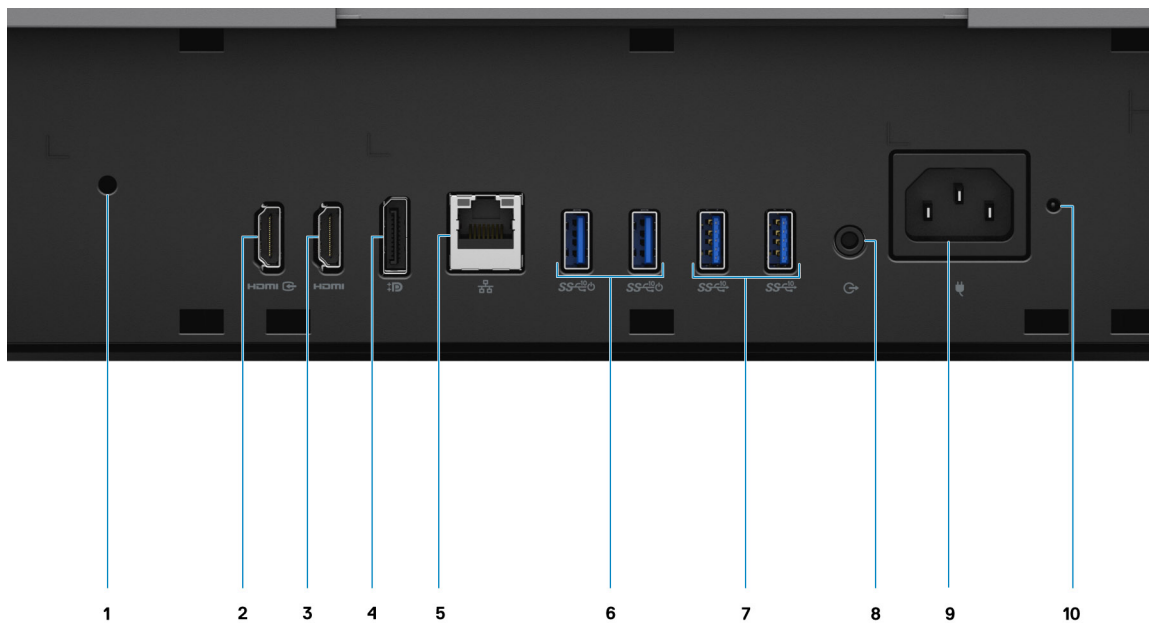

1. Cable cover screw hole
2. HDMI-IN—HDMI 1.4 port
3. HDMI-OUT—HDMI 2.0 port
4. DP++ 1.4a/HDCP 2.3 port
5. RJ-45 Ethernet port
6. USB 3.2 Gen 2 ports with Smart Power On
7. USB 3.2 Gen 2 ports
8. Line-out audio port
9. Power connector
10. PSU status indicator LED

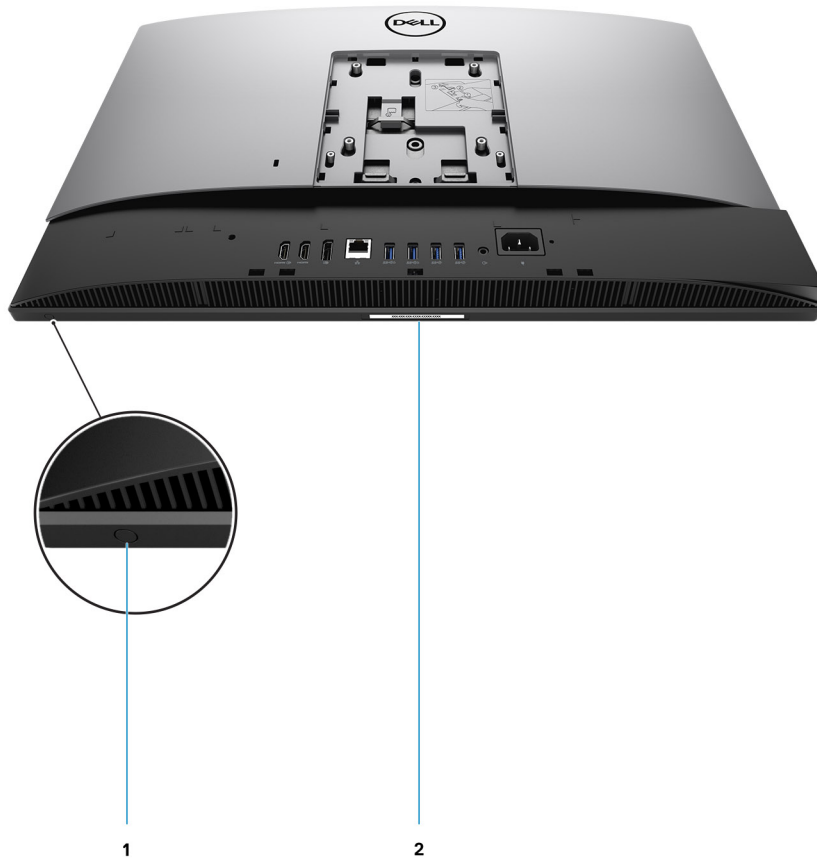

1. Display Built-in Self Test button

This button has two functions:

- When the computer is on, use this button to select the video input-source.
Press the button to switch the display between the internal system display and HDMI input.
- When the computer is off (there is no power; neither is it in sleep state nor hibernate state), use this button to run the built-in selftest for the display.

Press and hold down this button, and then press the power button to turn on the computer. The built-in color pattern for the LCD monitor will appear on the screen.

For more information, see the Troubleshooting section in the Service Manual at www.dell.com/support/manuals.

2. Service tag label

Inside view of your computer

NOTE: The appearance of heat sink differs depending on the graphics configuration you ordered.

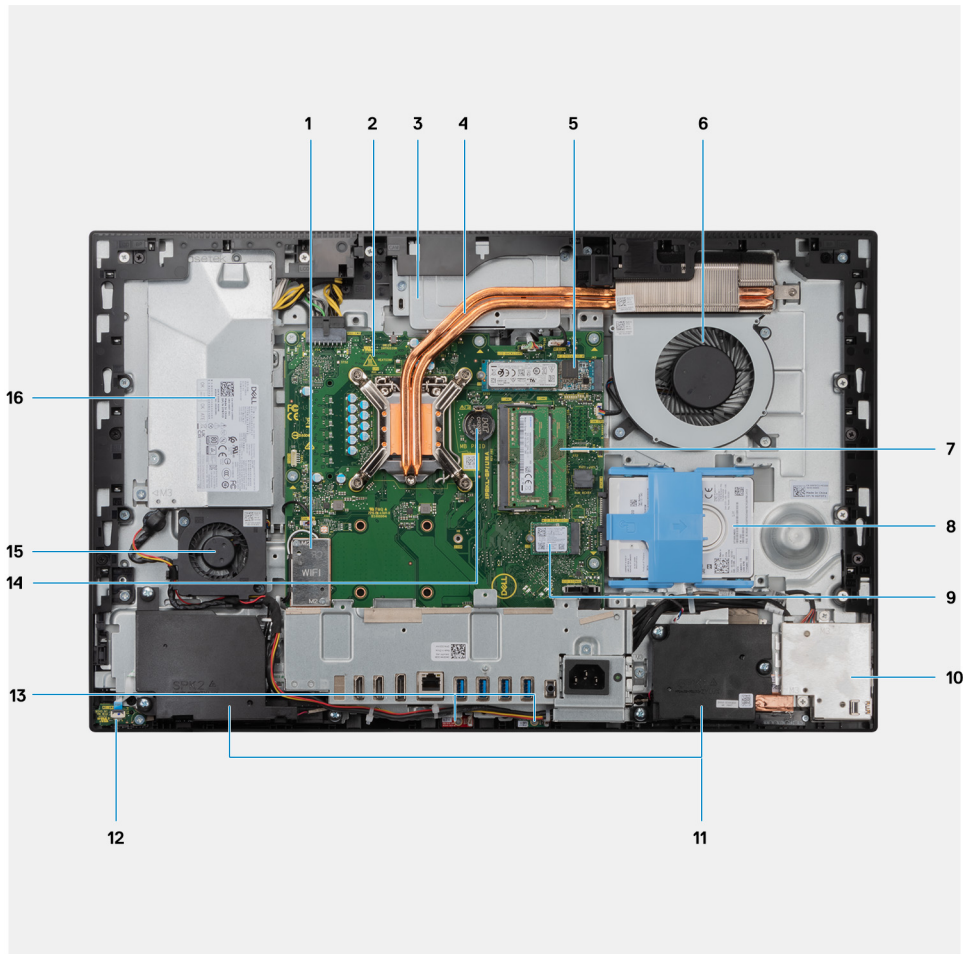

1. Wireless card
2. System board
3. Camera assembly
4. Heat sink
5. M.2 2230/2280 solid-state drive/Intel Optane PCIe connector
6. Processor fan
7. Memory modules
8. Hard drive
9. M.2 2230/2280 solid-state drive PCIe connector
10. Side-I/O board
11. Speakers
12. Power-button board
13. Microphones
14. Coin-cell battery
15. Power-supply fan
16. Power-supply unit

System board layout

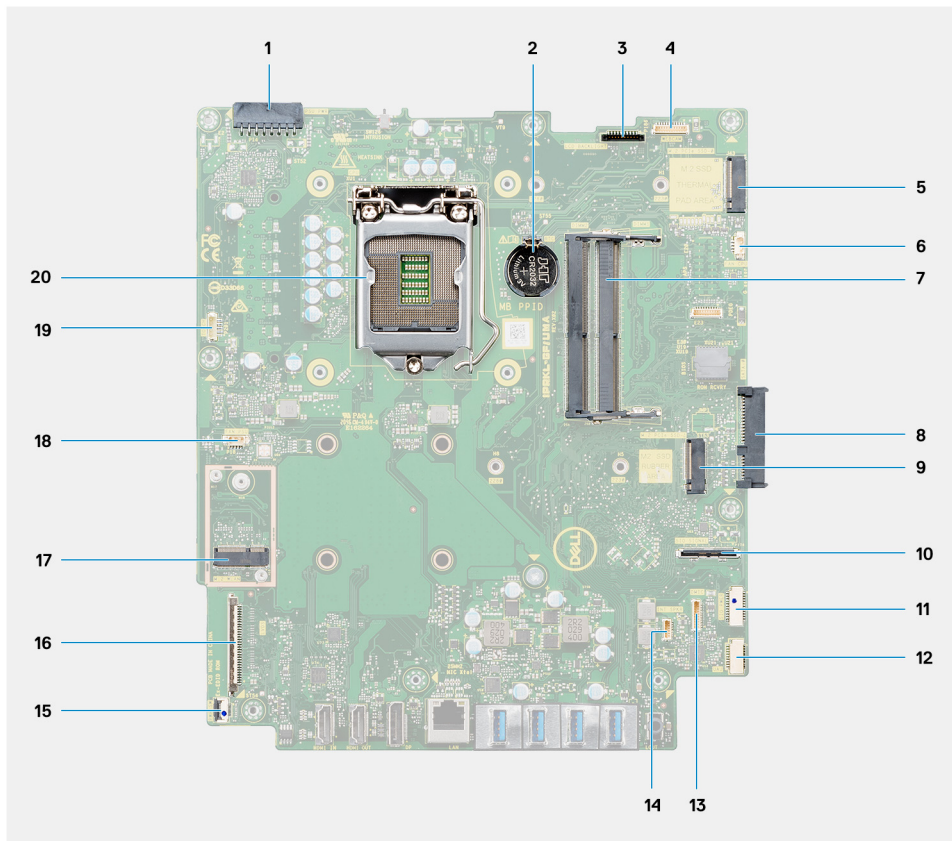

1. Power-supply unit (PSU) cable connector
2. Coin-cell battery
3. Display back-light cable connector
4. Camera cable connector
5. M.2 2230/2280 solid-state drive/Intel Optane PCIe connector
6. Processor-fan cable connector
7. Memory modules
8. Hard-drive connector
9. M.2 2230/2280 solid-state drive PCIe connector
10. Side IO-signal cable connector
11. Side IO-power cable connector
12. Audio-board cable connector
13. Microphone-module cable connector
14. Speaker cable connector
15. Power-button cable connector
16. Display cable connector
17. M.2 WLAN connector
18. PSU-fan cable connector
19. Touchscreen cable connector
20. Processor

Specifications of OptiPlex 7490 All-in-One

Dimensions and weight

The following table lists the height, width, depth, and weight of your OptiPlex 7490 All-in-One.

Table 2. Dimensions and weight

Description	Values for touch display	Values for non-touch display
Height	344.00 mm (13.54 in.)	344.00 mm (13.54 in.)
Width	540.20 mm (21.26 in.)	540.20 mm (21.26 in.)
Depth	52.60 mm (2.07 in.)	52.60 mm (2.07 in.)
Weight (maximum)	6.29 kg (13.87 lb)	6.56 kg (14.46 lb)
Weight (minimum)	5.88 kg (12.96 lb)	6.12 kg (13.49 lb)

NOTE: The weight of your computer depends on the configuration ordered and manufacturing variability.

Processor

The following table lists the height, width, depth, and weight of your OptiPlex 7490 All-in-One.

NOTE: Global Standard Products (GSP) are a subset of Dell's relationship products that are managed for availability and synchronized transitions on a worldwide basis. They ensure the same platform is available for purchase globally. This allows customers to reduce the number of configurations managed on a worldwide basis, thereby reducing their costs. They also enable companies to implement global IT standards by locking in specific product configurations worldwide.

Device Guard (DG) and Credential Guard (CG) are the new security features that only available on Windows 10 Enterprise today. Device Guard is a combination of enterprise-related hardware and software security features. When you configure together, it locks a device and it can only run trusted applications. Credential Guard uses virtualization-based security to isolate secrets (credentials) and only privileged system software can access the system. Unauthorized access to these secrets can lead to credential theft attacks. Credential Guard prevents these attacks by protecting NTLM password hashes and Kerberos Ticket Granting Tickets.

NOTE: Processor numbers are not a measure of performance. Processor availability subject to change and may vary by region/country.

Table 3. Processor

Processor type	Process or wattage	Process or core count	Processor thread count	Processor speed	Process or cache	Integrated graphics
10 th Generation Intel Core i3-10105	65 W	4	8	3.70 GHz to 4.40 GHz	6 MB	Intel UHD Graphics 630
10 th Generation Intel Core i3-10305	65 W	4	8	3.80 GHz to 4.50 GHz	8 MB	Intel UHD Graphics 630

Table 3. Processor (continued)

Processor type	Process or wattage	Process or core count	Processor thread count	Processor speed	Processor cache	Integrated graphics
10 th Generation Intel Core i5-10505	65 W	6	12	3.20 GHz to 4.60 GHz	12 MB	Intel UHD Graphics 630
10 th Generation Intel Core i3-10100	65 W	4	8	3.60 GHz to 4.30 GHz	6 MB	Intel UHD Graphics 630
10 th Generation Intel Core i3-10300	65 W	4	8	3.70 GHz to 4.40 GHz	8 MB	Intel UHD Graphics 630
10 th Generation Intel Core i5-10400	65 W	6	12	2.90 GHz to 4.30 GHz	12 MB	Intel UHD Graphics 630
10 th Generation Intel Core i5-10500	65 W	6	12	3.10 GHz to 4.50 GHz	12 MB	Intel UHD Graphics 630
10 th Generation Intel Core i5-10600	65 W	6	12	3.30 GHz to 4.80 GHz	12 MB	Intel UHD Graphics 630
10 th Generation Intel Core i7-10700	65 W	8	16	2.90 GHz to 4.80 GHz	16 MB	Intel UHD Graphics 630
10 th Generation Intel Core i9-10900	65 W	10	20	2.80 GHz to 5.20 GHz	16 MB	Intel UHD Graphics 630
11 th Generation Intel Core i5-11400	65 W	6	12	2.60 GHz to 4.40 GHz	12 MB	Intel UHD Graphics 730
11 th Generation Intel Core i5-11500	65 W	6	12	2.70 GHz to 4.60 GHz	12 MB	Intel UHD Graphics 750
11 th Generation Intel Core i5-11600	65 W	6	12	2.80 GHz to 4.80 GHz	12 MB	Intel UHD Graphics 750
11 th Generation Intel Core i7-11700	65 W	8	16	2.50 GHz to 4.90 GHz	16 MB	Intel UHD Graphics 750
11 th Generation Intel Core i9-11900	65 W	8	16	2.50 GHz to 5.20 GHz	16 MB	Intel UHD Graphics 750

Chipset

The following table lists the details of the chipset supported by your OptiPlex 7490 All-in-One.

Table 4. Chipset

Description	Values
Chipset	Intel Q570
Processor	<ul style="list-style-type: none"> 10th Generation Intel Core i3/i5/i7/i9 11th Generation Intel Core i5/i7/i9
DRAM bus width	<ul style="list-style-type: none"> 64-bit (for single-channel) 128-bit (for dual-channel)
Flash EPROM	32 MB
PCIe bus	Up to Gen 3.0

Table 4. Chipset (continued)

Description	Values
Non-volatile memory	Yes
BIOS configuration Serial Peripheral Interface (SPI)	256 Mbit (32 MB) located at SPI_FLASH
Trusted Platform Module (TPM) 2.0 (Discrete TPM Enabled)	24 KB located at TPM 2.0 on chipset
Firmware-TPM (Discrete TPM disabled)	By default the Platform Trust Technology feature is visible to the operating system.
NIC EEPROM	LOM configuration contained within SPI flash ROM instead of LOM e-fuse

Operating system

Your OptiPlex 7490 All-in-One supports the following operating systems:

- Windows 10 Home, 64-bit
- Windows 10 IoT Enterprise 2019 LTSC (OEM Only)
- Windows 10 Pro, 64-bit
- Windows 10 Pro Education, 64-bit
- Windows 10 CMIT Government Edition, 64-bit
- Kylin Linux Desktop version 10.1 (China only)
- Ubuntu Linux 20.04 LTS, 64-bit

For more information about Dell OS Recovery image, see How to Download and Use the Dell OS Recovery Image in Microsoft Windows, at [Dell support site](#).

Commercial platform Windows 10 N-2 and 5-year operating system supportability:

All newly introduced 2019 and later commercial platforms (Latitude, OptiPlex, and Dell Precision) will qualify and ship with the most current factory installed Semi-Annual Channel Windows 10 version (N) and qualify (but not ship) the previous two versions (N-1, N-2). The OptiPlex 7490 All-in-One will RTS with Windows 10 version v20H2 at time of launch, and this version will determine the N-2 versions that are initially qualified for this platform.

For future versions of Windows 10, Dell continues to test the commercial platform with coming Windows 10 releases during device production and for five years post-production, including both fall and spring releases from Microsoft.

For additional information about N-2 and 5-year Windows operating system supportability, see the Dell Windows as a Service (WaaS), at [Dell support site](#).

EOML 411

The OptiPlex 7490 All-in-One continues to test the coming Semi-Annual Channel Windows 10 version releases for five years post-production, including both fall and spring releases from Microsoft.

Memory

The following table lists the memory specifications of your OptiPlex 7490 All-in-One.

Table 5. Memory specifications

Description	Values
Memory slots	Two SO-DIMM slots
Memory type	DDR4, Non-ECC
Memory speed	2666 MHz/2933 MHz/3200 MHz
Maximum memory configuration	64 GB

Table 5. Memory specifications (continued)

Description	Values
Minimum memory configuration	4 GB
Memory size per slot	4 GB, 8 GB, 16 GB, 32 GB
Memory configurations supported	<ul style="list-style-type: none"> • 4 GB, 1 x 4 GB, 2666 MHz for 10th Generation i3/i5 processors, 2933 MHz for 10th Generation i7/i9 processors, 3200 MHz for 11th Generation processors • 8 GB, 1 x 8 GB, 2666 MHz for 10th Generation i3/i5 processors, 2933 MHz for 10th Generation i7/i9 processors, 3200 MHz for 11th Generation processors • 8 GB, 2 x 4 GB, 2666 MHz for 10th Generation i3/i5 processors, 2933 MHz for 10th Generation i7/i9 processors, 3200 MHz for 11th Generation processors • 16 GB, 1 x 16 GB, 2666 MHz for 10th Generation i3/i5 processors, 2933 MHz for 10th Generation i7/i9 processors, 3200 MHz for 11th Generation processors • 16 GB, 2 x 8 GB, 2666 MHz for 10th Generation i3/i5 processors, 2933 MHz for 10th Generation i7/i9 processors, 3200 MHz for 11th Generation processors • 32 GB, 1 x 32 GB, 2666 MHz for 10th Generation i3/i5 processors, 2933 MHz for 10th Generation i7/i9 processors, 3200 MHz for 11th Generation processors • 32 GB, 2 x 16 GB, 2666 MHz for 10th Generation i3/i5 processors, 2933 MHz for 10th Generation i7/i9 processors, 3200 MHz for 11th Generation processors • 64 GB, 2 x 32 GB, 2666 MHz for 10th Generation i3/i5 processors, 2933 MHz for 10th Generation i7/i9 processors, 3200 MHz for 11th Generation processors

Memory configuration matrix

The following table lists the memory configurations supported for your OptiPlex 7490 All-in-One.

Table 6. Memory configuration matrix

Configuration	Slot	
	SO-DIMM1	SO-DIMM2
4 GB DDR4	4 GB	NA
8 GB DDR4	8 GB	NA
8 GB DDR4	4 GB	4 GB
16 GB DDR4	16 GB	NA
16 GB DDR4	8 GB	8 GB
32 GB DDR4	32 GB	NA
32 GB DDR4	16 GB	16 GB
64 GB DDR4	32 GB	32 GB

External ports

The following table lists the external ports of your OptiPlex 7490 All-in-One.

Table 7. External ports

Description	Values
Network port	One RJ-45 port (rear)
USB ports	<ul style="list-style-type: none">• One USB 3.2 Gen 2x2 capable Type-C port (side)• One USB 3.2 Gen 1 port with PowerShare (side)• Two USB 3.2 Gen 2 ports with Smart Power On (rear)• Two USB 3.2 Gen 2 ports (rear)
Audio port	<ul style="list-style-type: none">• One Universal audio port (side)• One Line-out audio port (rear)
Video port	<ul style="list-style-type: none">• One DP++ 1.4a/HDCP 2.3 port (rear)• One HDMI-IN—HDMI 1.4 port (rear)• One HDMI-OUT—HDMI 2.0 port (rear)
Media-card reader	One SD 4.0 card slot (side)
Power-adaptor port	Not supported
Security-cable slot	One Kensington security-cable slot

Internal slots

The following table lists the internal slots of your OptiPlex 7490 All-in-One.

Table 8. Internal slots

Description	Values
M.2	<ul style="list-style-type: none">• One M.2 2230 slot for Wi-Fi and Bluetooth card• Two M.2 2230/2280 slots for solid-state drive/Intel Optane <p> NOTE: To learn more about the features of different types of M.2 cards, see the knowledge base article 000144170 at www.dell.com/support.</p>

Ethernet

The following table lists the wired Ethernet Local Area Network (LAN) specifications of your OptiPlex 7490 All-in-One.

Table 9. Ethernet specifications

Description	Values
Model number	Intel i219LM
Transfer rate	10/100/1000 Mbps

Wireless module

The following table lists the Wireless Local Area Network (WLAN) modules supported on your OptiPlex 7490 All-in-One.

Table 10. Wireless module specifications

Description	Option one	Option two
Model number	Intel Wi-Fi 6 AX201	Qualcomm QCA61x4a
Transfer rate	Up to 2400 Mbps	Up to 867 Mbps
Frequency bands supported	2.4 GHz/5 GHz	2.4 GHz/5 GHz
Wireless standards	<ul style="list-style-type: none"> • Wi-Fi 802.11 a/b/g • Wi-Fi 4 (WiFi 802.11n) • Wi-Fi 5 (WiFi 802.11ac) • Wi-Fi 6 (WiFi 802.11ax) 	<ul style="list-style-type: none"> • Wi-Fi 802.11 a/b/g • Wi-Fi 4 (WiFi 802.11n) • Wi-Fi 5 (WiFi 802.11ac)
Encryption	<ul style="list-style-type: none"> • 64-bit/128-bit WEP • AES-CCMP • TKIP 	<ul style="list-style-type: none"> • 64-bit/128-bit WEP • AES-CCMP • TKIP
Bluetooth	Bluetooth 5.1	Bluetooth 5.0

Audio

The following table lists the audio specifications of your OptiPlex 7490 All-in-One.

Table 11. Audio specifications

Description	Values
Audio controller	Realtek Codec ALC3289
Stereo conversion	Supported
Internal audio interface	High definition audio interface
External audio interface	Universal audio jack
Number of speakers	2
Internal-speaker amplifier	Realtek Amplifier ALC1302
External volume controls	Not supported
Speaker output:	
Average speaker output	5 W
Peak speaker output	6 W
Subwoofer output	Not supported
Microphone	2

Storage

This section lists the storage options on your OptiPlex 7490 All-in-One.

Your computer supports one of the following configurations:

Table 12. Storage matrix

Storage type	2.5-inch hard drive	1 st M.2 socket	2 nd M.2 socket
One 2.5-inch hard drive	Yes	No	No
One M.2 2230/2280 solid-state drive	No	Yes	No
One M.2 2230/2280 solid-state drive and one 2.5-inch hard-disk drive	Yes	Yes	No
Dual M.2 2230/2280 solid-state drives	No	Yes	Yes
Dual M.2 2230/2280 solid-state drives and one 2.5-inch hard-disk drive	Yes	Yes	Yes
One Intel Optane Memory H20 32GB with 512GB solid-state drive	No	No	Yes

The primary drive of your computer varies with the storage configuration. For computers:

- With a M.2 drive, the M.2 drive is the primary drive
- Without a M.2 drive, the 2.5-inch hard-disk drive is the primary drive

Table 13. Storage specifications

Storage type	Interface type	Capacity
2.5-inch, 5400 RPM, HDD	SATA	Up to 1 TB
2.5-inch, 7200 RPM, HDD	SATA	500 GB
2.5-inch, 7200 RPM, HDD, Self-Encrypting, Opal 2.0, FIPS	FIPS SATA	Up to 2 TB
M.2 2230, Class 35 SSD	PCIe NVMe Gen3 x4	Up to 512 GB
M.2 2280, Class 40 SSD	PCIe NVMe Gen3 x4	Up to 2 TB
M.2 2280, Class 40 SSD, self-encrypting drive	PCIe NVMe Gen3 x4	Up to 1 TB
M.2 2280, Class 40 SSD	PCIe NVMe Gen4 x4	2 TB

Intel Optane memory

Intel Optane memory functions only as a storage accelerator. It neither replaces nor adds to the memory (RAM) installed on your computer.

NOTE: Intel Optane memory is supported on computers that meet the following requirements:

- 7th Generation or higher Intel Core i3/i5/i7 processor
- Windows 10 64-bit version or higher (Anniversary Update)
- Latest version of Intel Rapid Storage Technology driver

Table 14. Intel Optane memory

Description	Values
Type	Memory
Interface	PCIe NVMe Gen3 x4
Connector	M.2 2280
Configurations supported	32GB + 512GB SSD
Capacity	Up to 512 GB

Media-card reader

The following table lists the media cards supported by your OptiPlex 7490 All-in-One.

Table 15. Media-card reader specifications

Description	Values
Media-card type	One Secure Digital (SD) 4.0 card
Media-cards supported	<ul style="list-style-type: none"> Secure Digital High Capacity (SDHC) Secure Digital Extended Capacity (SDXC) Secure Digital (SD) 4.0 SD UHS-I (UHS104) SD UHS-II
<p>NOTE: The maximum capacity supported by the media-card reader varies depending on the standard of the media card installed in your computer.</p>	

Camera

The following table lists the camera specifications of your OptiPlex 7490 All-in-One.

Table 16. Full HD RGB Infrared webcam specifications

Description	Values
Number of cameras	Two
Camera type	FHD RGB camera/VGA infrared camera
Camera location	Front camera
Camera sensor type	CMOS sensor technology
Camera resolution:	
Still image	2.07 megapixel
Video	1920 x 1080 (FHD) at 30 fps
Infrared camera resolution:	
Still image	0.30 megapixel
Video	640 x 480 (VGA) at 30 fps

Table 16. Full HD RGB Infrared webcam specifications (continued)

Description		Values
Diagonal viewing angle:		
	Camera	77.5 degrees
	Infrared camera	82.9 degrees

Table 17. Full HD RGB Webcam

Description		Values
Number of cameras		One
Camera type		FHD RGB camera
Camera location		Front camera
Camera sensor type		CMOS sensor technology
Camera resolution:		
	Still image	2.07 megapixels
	Video	1920 x 1080 (FHD) at 30 fps
Diagonal viewing angle		77.4 degrees

Power ratings

The following table lists the power rating specifications of OptiPlex 7490 All-in-One.

Table 18. Power ratings

Description	Option one	Option two
Type	220 W Platinum	160 W Bronze
Diameter (connector)	Not supported	Not supported
Input voltage	90 VAC–264 VAC	90 VAC–264 VAC
Input frequency	47 Hz–63 Hz	47 Hz–63 Hz
Input current (maximum)	3.6 A	3.6 A
Output current (continuous)	<ul style="list-style-type: none"> ● +19.5 VA/8.5 A ● +19.5 VB/9.2 A Standby mode: <ul style="list-style-type: none"> ● +19.5 VA/0.5 A ● +19.5 VB/1.75 A 	<ul style="list-style-type: none"> ● +19.5 VA/7.5 A ● +19.5 VB/7.0 A Standby mode: <ul style="list-style-type: none"> ● +19.5 VA/0.5 A ● +19.5 VB/1.75 A
Rated output voltage	<ul style="list-style-type: none"> ● +19.5 VA ● +19.5 VB 	<ul style="list-style-type: none"> ● +19.5 VA ● +19.5 VB
BTUs/h (based on PSU max wattage)	750	546
Typical Efficiency (Active PFC)	Not applicable  NOTE: The typical efficiency of Active PFC Power Supply is 70%. APFC Power Supply is not offered with OptiPlex 7490 AIO.	
Temperature range		
Operating	5°C to 42°C (41°F to 107°F)	5°C to 42°C (41°F to 107°F)

Table 18. Power ratings (continued)

Description	Option one	Option two
Storage	-40°C to 70°C (-40°F to 158°F)	-40°C to 70°C (-40°F to 158°F)
Compliance		
ErP Lot6 Tier 2 0.5 Watt requirement	Yes	Yes
Climate Savers/80Plus compliant	Yes	Yes
Energy Star 8.0 qualified	Yes	Yes
FEMP Standby Power compliant	Yes	Yes

Power supply connectors

The following table provides information about the power supply connectors of your OptiPlex 7490 All-in-One.

Table 19. Power supply connectors

Power supply unit	Connectors
160 W Bronze	<ul style="list-style-type: none"> • One 16 pin connector for system board • One 2 pin connector for LED
220 W Platinum	<ul style="list-style-type: none"> • One 16 pin connector for system board • One 2 pin connector for LED

Display

The following table lists the display specifications of your OptiPlex 7490 All-in-One.

Table 20. Display specifications

Description	Values for touch display	Values for non-touch display
Display type	Full High Definition (FHD)	Full High Definition (FHD)
Display panel technology	Wide-Viewing Angle (WVA)	Wide-Viewing Angle (WVA)
Luminance	<ul style="list-style-type: none"> • 250 Nits (typical) • 200 Nits (minimum) 	<ul style="list-style-type: none"> • 250 Nits (typical) • 200 Nits (minimum)
Display-panel dimensions (active area):		
	Height	296.46 mm (11.67 in.)
	Width	527.04 mm (20.75 in.)
	Diagonal	604.70 mm (23.81 in.)
Display-panel native resolution	1920 x 1080	1920 x 1080
Megapixels	2.07	2.07
Color gamut	72% NTSC typical	72% NTSC typical

Table 20. Display specifications (continued)

Description	Values for touch display	Values for non-touch display
Pixels per inch (PPI)	92	92
Contrast ratio	<ul style="list-style-type: none"> 700:1 (minimum) 1000:1 (typical) 	<ul style="list-style-type: none"> 700:1 (minimum) 1000:1 (typical)
Response time (max)	25 ms	25 ms
Refresh rate	60 Hz	60 Hz
Horizontal view angle	<ul style="list-style-type: none"> 170 degrees (minimum) 178 degrees (typical) 	<ul style="list-style-type: none"> 170 degrees (minimum) 178 degrees (typical)
Vertical view angle	<ul style="list-style-type: none"> 170 degrees (minimum) 178 degrees (typical) 	<ul style="list-style-type: none"> 170 degrees (minimum) 178 degrees (typical)
Pixel pitch	0.2745 x 0.2745 mm	0.2745 x 0.2745 mm
Power consumption (maximum)	13.48 W	12.50 W
Anti-glare vs glossy finish	Anti-glare	Anti-glare
Adaptive sync	Not applicable	Not applicable
Stylus support	Capacitive touch	Not applicable
Multi-touch feature supported	10-points multi-touch	Not applicable
Display surface	Anti-glare treatment of the front polarizer (Haze 25%, 3H)	Anti-glare treatment of the front polarizer (Haze 25%, 3H)

GPU—Integrated

The following table lists the specifications of the integrated Graphics Processing Unit (GPU) supported by your OptiPlex 7490 All-in-One.

Table 21. GPU—Integrated

Controller	External display support	Memory size	Processor
Intel UHD Graphics 630	<ul style="list-style-type: none"> DP++ 1.4a/HDCP 2.3 port HDMI-OUT—HDMI 2.0 port 	Shared system memory	10 th Generation Intel Core i3/i5/i7/i9 processors
Intel UHD Graphics 730	<ul style="list-style-type: none"> DP++ 1.4a/HDCP 2.3 port HDMI-OUT—HDMI 2.0 port 	Shared system memory	11 th Generation Intel Core i5-11400 processor
Intel UHD Graphics 750	<ul style="list-style-type: none"> DP++ 1.4a/HDCP 2.3 port HDMI-OUT—HDMI 2.0 port 	Shared system memory	11 th Generation Intel Core i5/i7/i9 processors

GPU—Discrete

The following table lists the specifications of the discrete Graphics Processing Unit (GPU) supported by your OptiPlex 7490 All-in-One.

Table 22. GPU—Discrete

Controller	External display support	Memory size	Memory type
NVIDIA GeForce GTX 1650 Ti	HDMI-OUT—HDMI 2.0 port	4 GB	GDDR6

Environmental

Table 23. Environmental specifications

Feature	Values
Recyclable packaging	Yes
BFR/PVC—free chassis	No
Vertical orientation packaging support	Yes
Multi-Pack packaging	No
Energy-Efficient Power Supply	Standard
ENV0424 compliant	Yes

i NOTE: Wood-based fiber packaging contains a minimum of 35% recycled content by total weight of wood-based fiber. Packaging that contains without wood-based fiber can be claimed as Not Applicable. The anticipated required criteria for EPEAT 2018.

Regulatory

Table 24. Regulatory

Regulatory compliance
EPEAT registered configurations available
ENERGY STAR compliant configurations available
TCO 8.0 certified configurations available
US CEC MEPS compliant configurations available
Australia and New Zealand MEPS compliant configurations available
CEL
WEEE
Japan Energy Law
South Korea E-standby
EU RoHS
China RoHS

Operating and storage environment

This table lists the operating and storage specifications of your OptiPlex 7490 All-in-One.

Airborne contaminant level: G1 as defined by ISA-S71.04-1985

Table 25. Computer environment

Description	Operating	Storage
Temperature range	10°C to 35°C (50°F to 95°F)	-40°C to 65°C (-40°F to 149°F)
Relative humidity (maximum)	20% to 80% (non-condensing)	5% to 95% (non-condensing)
Vibration (maximum)*	0.26 GRMS	1.37 GRMS
Shock (maximum)	40 G†	105 G†
Altitude range	0 m to 3048 m (0 ft to 10000 ft)	0 m to 10668 m (0 ft to 35000 ft)

⚠ CAUTION: Operating and storage temperature ranges may differ among components, so operating or storing the device outside these ranges may impact the performance of specific components.

* Measured using a random vibration spectrum that simulates user environment.

† Measured using a 2 ms half-sine pulse when the hard drive is in use.

Getting help and contacting Dell

Self-help resources

You can get information and help on Dell products and services using these self-help resources:

Table 26. Self-help resources

Self-help resources	Resource location
Information about Dell products and services	www.dell.com
Tips	
Contact Support	In Windows search, type <code>Contact Support</code> , and press Enter.
Online help for operating system	www.dell.com/support/windows www.dell.com/support/linux
Troubleshooting information, user manuals, setup instructions, product specifications, technical help blogs, drivers, software updates, and so on.	www.dell.com/support
Dell knowledge base articles for a variety of computer concerns.	<ol style="list-style-type: none"> 1. Go to https://www.dell.com/support/home/?app=knowledgebase. 2. Type the subject or keyword in the Search box. 3. Click Search to retrieve the related articles.

Contacting Dell

To contact Dell for sales, technical support, or customer service issues, see www.dell.com/contactdell.

 **NOTE:** Availability varies by country and product, and some services may not be available in your country.

 **NOTE:** If you do not have an active internet connection, you can find contact information on your purchase invoice, packing slip, bill, or Dell product catalog.