

BenQ



**MOUSE FOR
e-SPORTS**

Wireless Mouse
DW Version
User Manual

Copyright and disclaimer

Copyright

Copyright 2026 BenQ Corporation. All rights reserved. No part of this publication may be reproduced, transmitted, transcribed, stored in a retrieval system or translated into any language or computer language, in any form or by any means, electronic, mechanical, magnetic, optical, chemical, manual or otherwise, without the prior written permission of BenQ Corporation.

All other logos, products, or company names mentioned in this manual may be the registered trademarks or copyrights of their respective companies, and are used for informational purposes only.

Disclaimer

BenQ Corporation makes no representations or warranties, either expressed or implied, with respect to the contents of this document. BenQ Corporation reserves the right to revise this publication and to make changes from time to time in the contents thereof without obligation to notify any person of such revision or changes.

It is the sole responsibility of the user if problems (such as data loss and system failure) occurred due to non-factory installed software, parts, and/or non-original accessories.

The screenshots and illustrations in this document are for reference only and may differ from the actual design.

This document aims to provide the most updated and accurate information to customers, and thus all contents may be modified from time to time without prior notice. Please visit the [website](#) for the latest version of this document.

Servicing

Should you have any queries about the software after reading the document, visit the local website from ZOWIESupport.BenQ.com for more support and local customer service.



ZOWIE Support

Table of contents

Copyright and disclaimer.....	2
Compatible models.....	6
Package contents	7
Product overview	9
Connections	12
Wireless connections	12
Connecting via 4K enhanced receiver	12
Connecting via USB receiver.....	15
Wired connection.....	17
Power supply.....	18
Battery power check.....	18
Power LED indicators	18
Additional low battery indicator with high polling rate.....	19
Charging.....	20
Charing via 4K enhanced receiver	20
Charging via USB cable	20
Charging time and battery time	21
Saving power	22
Configurations.....	23
Changing DPI setting.....	23
Adjusting polling rate	24
Polling rate LED indicator on 4K enhanced receiver.....	24
Changing the Lift Off Distance (LOD)	26
Changing click response time	28

Enabling performance mode	30
Enabling motion sync	32
Updating firmware	34
Care and maintenance.....	35
Cleaning	35
Storage	35
Specifications.....	37

Compatible models

This user manual is for the following models:

- FK2-DW
- ZA13-DW
- S2-DW
- U2-DW
- EC1-DW
- EC2-DW
- EC3-DW

Package contents

When unpacking please check you have the following items. If any are missing or damaged, please contact the place of purchase for a replacement.

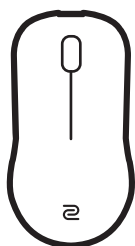

1



2



3



4



5



6



7

No.	Descriptions
-----	--------------

1.	Mouse
----	-------

2.	4K enhanced receiver
----	----------------------

3.	USB adapter
----	-------------

4.	USB receiver
----	--------------

5.	Spare skatez
----	--------------

6.	USB cable
----	-----------

No.	Descriptions
-----	--------------

User documents

- | | |
|----|---|
| 7. | <ul style="list-style-type: none">• Quick start guide• Regulatory statements• Warranty card |
|----|---|
-

ⓘ Note

- Consider keeping the box and packaging in storage for use in the future when you may need to transport the product.
- Always keep the product and accessories out of reach of small children.

Product overview

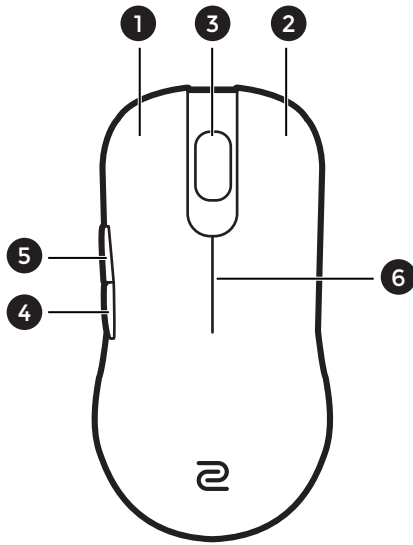

No.	Descriptions
1.	Left button
2.	Right button
3.	Scroll wheel
4.	Backward side button
5.	Front side button
6.	Power LED indicator

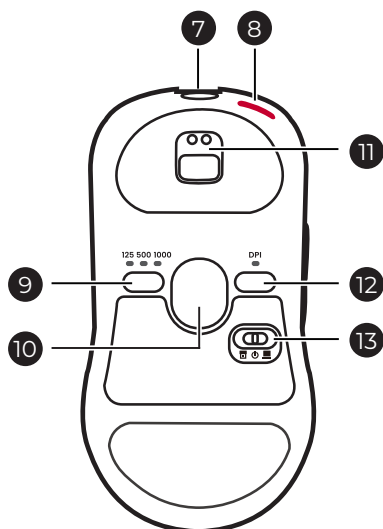

No.	Descriptions
7.	USB-C port <ul style="list-style-type: none"> • For charging • For connection with USB cable in wired operation
8.	Enhanced antenna
9.	Polling rate button
10.	Optical sensor
11.	Pogo pin (for charging)
12.	DPI button
13.	Mode switch <ul style="list-style-type: none"> •  Wireless mode via the USB receiver •  Power off mode •  Wireless mode via the 4K enhanced receiver

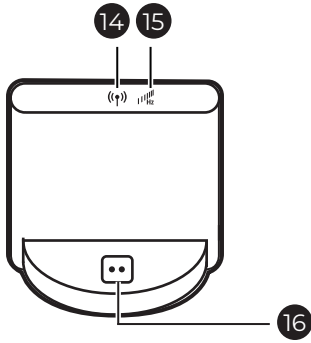

No.	Descriptions
-----	--------------

14.	Signal stability LED indicator (see page 13)
-----	---

15.	Polling rate LED indicator (see page 24)
-----	---

16.	Pogo pin (for charging)
-----	-------------------------

Connections

Wireless connections

You are provided with 2 ways of wireless connections.

Connecting via 4K enhanced receiver

1. Connect the 4K enhanced receiver to your computer by the supplied USB cable.

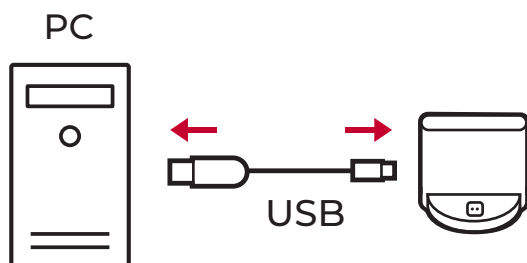



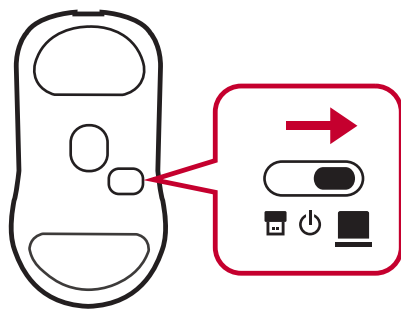

2. Switch to  mode from the bottom of the mouse.

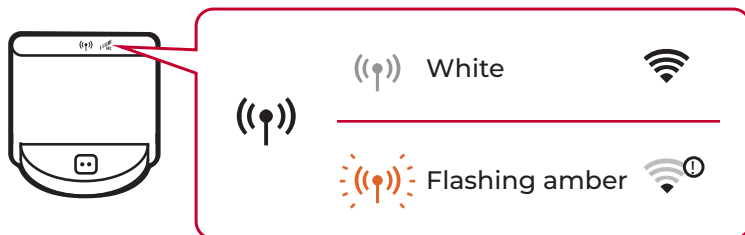

3. Check if the signal is stable by the LED indicator on the receiver. If the LED indicator is flashing amber, move the receiver or mouse within the effective range until the LED indicator turns white.



Signal stability (when using 4K enhanced receiver)

LED status	Connection status
 Dim white	The mouse is properly connected.
 Flashing amber	<ul style="list-style-type: none"> • (During mouse operation) The signal is not stable. • (When the mouse is inactive/off) The mouse is going to be disconnected.
 Solid white	The mouse is not connected.
 Off	The receiver is in standby mode as the mouse is not connected.

i Tips

- Keep the mouse and the receiver aligned in the center for optimal performance.
- For optimal performance, use the mouse approximately 20 cm away from the receiver at an angle of 50 degrees (left and right). This is for reference only. Check the LED indicator for signal stability.
- Keep the receiver at least 50 cm away from other possible signal interference such wireless routers.

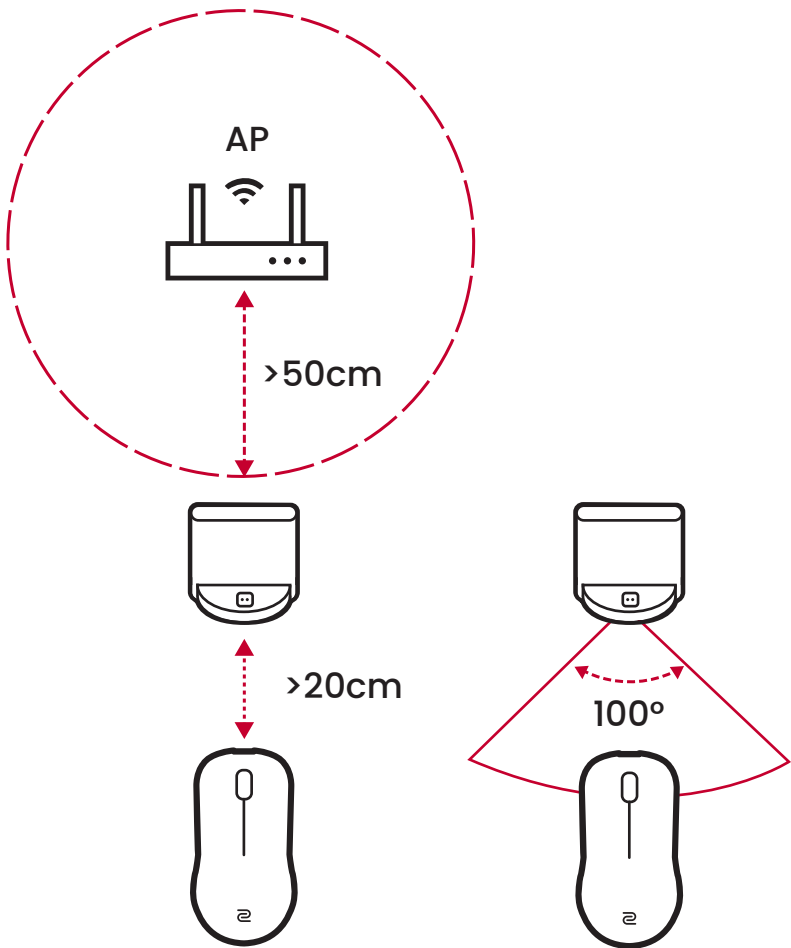

Connecting via USB receiver

1. Connect the USB receiver to your computer.

To ensure stable connectivity, use the supplied extension adapter (USB adapter) and USB cable to extend the distance of USB receiver.

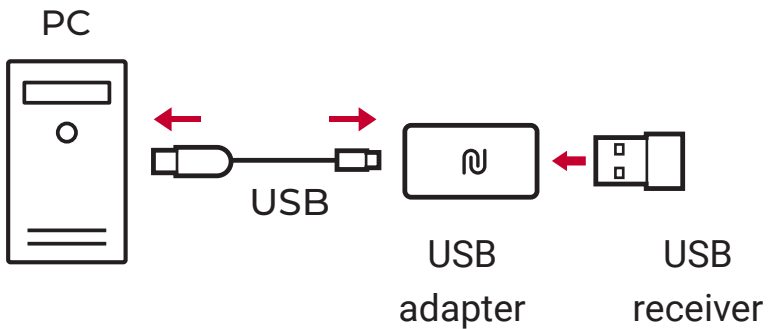

2. Switch to  mode from the bottom of the mouse.

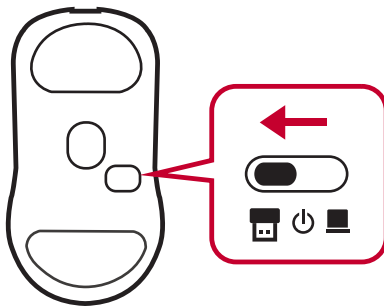

i Tips

- For optimal performance, use the mouse within a range of 20 cm of the USB receiver approximately. This is for reference only.
- Keep the receiver at least 2 meters away from other signal interference such wireless routers.

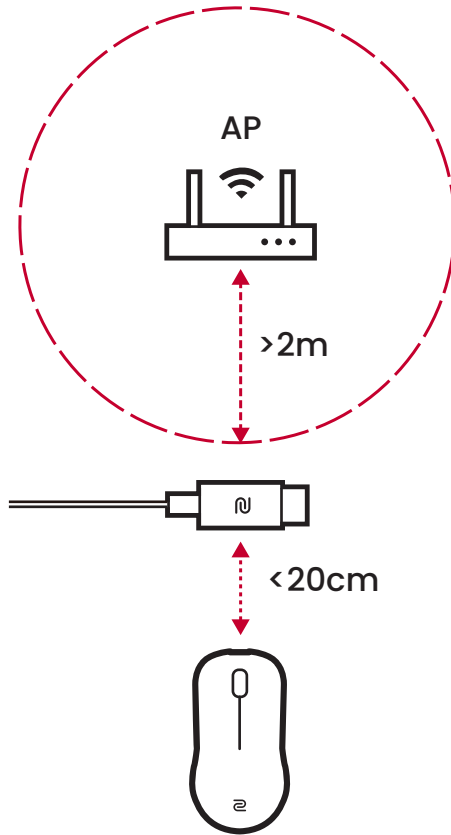

Wired connection

Connect the mouse to your computer using the supplied USB cable.

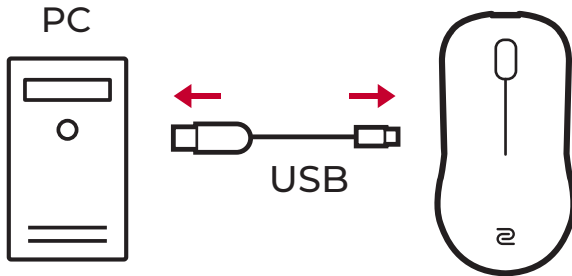



① Note

Regardless of the mode switched from the bottom of the mouse, the mouse is switched to wired operation and starts charging when it is connected to PC via the USB cable.

Power supply

Battery power check

To check the battery power level, switch to  or  mode from the bottom of the mouse. Alternatively, charge the mouse. The power LED indicators on the mouse will light up and show the battery power level.

Power LED indicators

Battery status at power on / during mouse charging

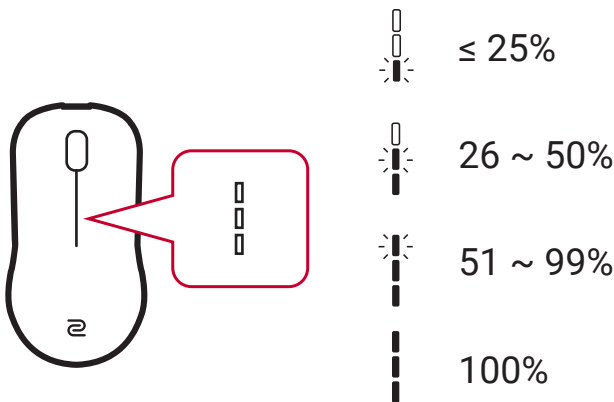

Battery status during mouse use

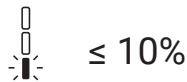

① Tips

The power LED indicators do not light up during mouse operation until the battery power is very low. To manually check power level, see [Battery power check on page 18](#).

Additional low battery indicator with high polling rate

When the mouse works with a high polling rate (2000 Hz or 4000 Hz) and the battery power is very low, you will be notified by a red light on the 4K enhanced receiver.

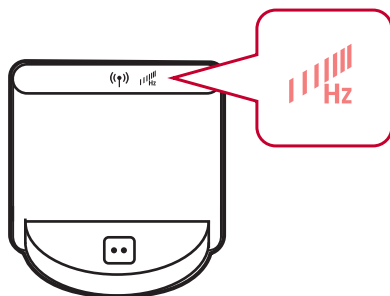

In this case, the battery will be drained in a few hours. You should charge the mouse soon or switch to a relatively low polling rate.

Charging

Charing via 4K enhanced receiver

When the 4K enhanced receiver is connected to PC via the supplied USB cable, place the mouse on the receiver with the pogo pin connectors attached.

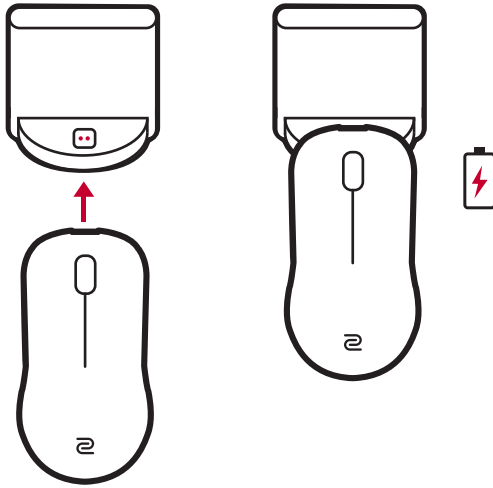

Charging via USB cable

Connect the mouse to PC via the supplied USB cable.

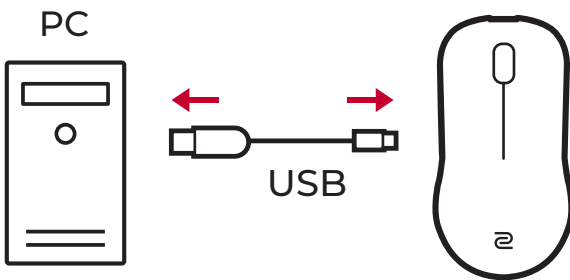

Charging time and battery time

It takes about 2 hours to fully charge the mouse. Battery time of a fully charged mouse varies by polling rate.

Polling rate	Battery time (with constant movement wirelessly)	
	Performance mode disabled	Performance mode enabled
1000 Hz	Up to 80 hours	Up to 30 hours
2000 Hz	Up to 30 hours	Up to 26 hours
4000 Hz	Up to 24 hours	Up to 21 hours

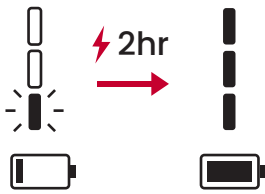
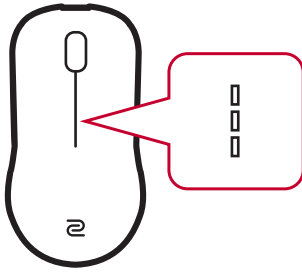

80hr

(with default polling rate)

Saving power

To save battery power, switch to  from the bottom of the mouse to power off.

As a moving mouse in a bag/suitcase keeps consuming power, you should switch power the mouse off before packing.

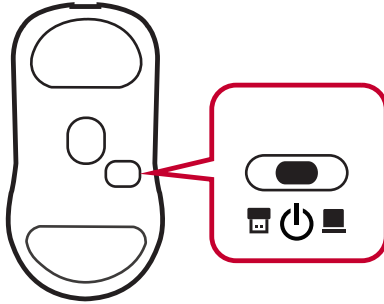

Configurations

Configure the sensitivity of your mouse to meet your preferences.

Changing DPI setting

Press DPI button from the bottom of the mouse repeatedly to cycle through different DPI options. You can tell the current setting by the LED indicator above the button.

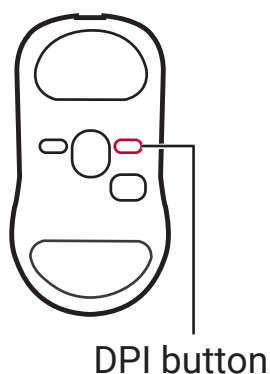

- 400 dpi
- 800 dpi
- 1000 dpi
- 1200 dpi
- 1600 dpi
- 3200 dpi

Adjusting polling rate

Press polling rate button from the bottom of the mouse repeatedly to cycle through different polling rates. You can tell the current setting by the LED indicator above the button.

Available polling rates vary according to the receiver (4K enhanced or USB) used. Note that more battery power is consumed with a higher polling rate.

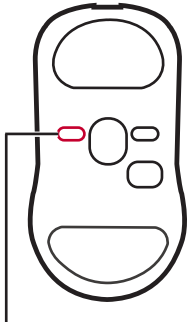

Polling rate button

● ○ ○	125 Hz
○ ● ○	500 Hz
○ ○ ●	1000 Hz
● ● ○	2000 Hz (4K enhanced receiver only)
○ ● ●	4000 Hz (4K enhanced receiver only)

Polling rate LED indicator on 4K enhanced receiver

When a high polling rate (either 2000 Hz or 4000 Hz) is set, the polling rate LED indicator lights up green.

High polling rates increase power consumption.

You can tell the exact setting by the LED indicator above polling rate button.

Polling rate LED indicator

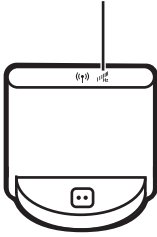

High polling rate (2000 Hz or 4000 Hz) is set.



Battery power is $\leq 10\%$ with high polling rate



A relatively lower polling rate is set.

① Note



If the polling rate is set to 2000 Hz / 4000 Hz yet the corresponding LED indicator remains off, check signal stability and make sure the wireless connection is working properly (with dim white signal stability LED indicator).

Changing the Lift Off Distance (LOD)

You might want to change the LOD to work with your preferences or mouse pad properly.

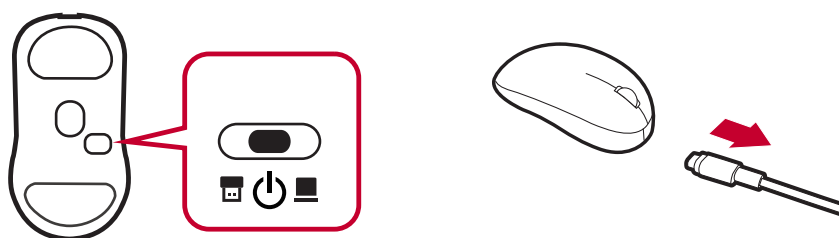
1. Switch to  from the bottom of the mouse to power off. Make sure the mouse is disconnected from PC.



2. While pressing and holding the following corresponding **combination buttons** together for the desired setting, power on the mouse by switching to  or  mode with another hand at the same time. The DPI indicator turns from the color of current DPI setting to white if the setup is completed.

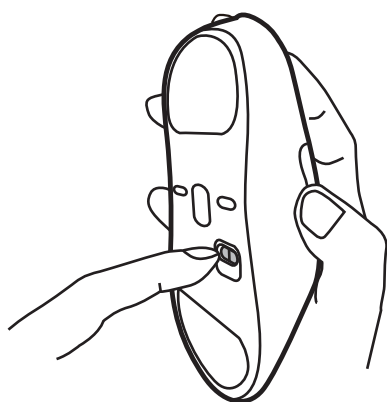

LOD settings and combination buttons

Lower LOD

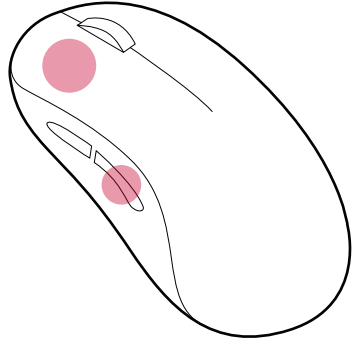

Medium LOD

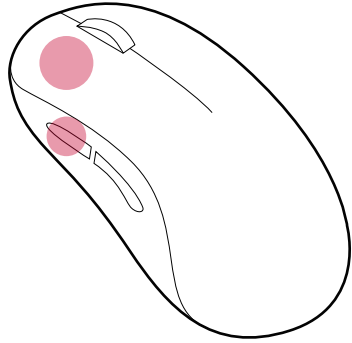

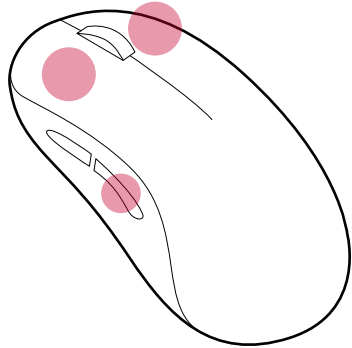

Higher LOD

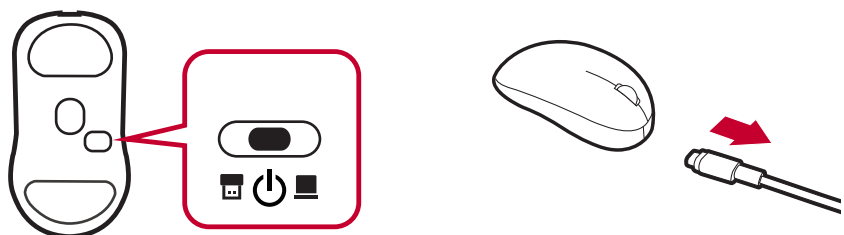

Changing click response time

1. Switch to  from the bottom of the mouse to power off. Make sure the mouse is disconnected from PC.



2. While pressing and holding the following **corresponding button** for the desired setting, power on the mouse by switching to  or  mode with another hand at the same time. The DPI indicator turns from the color of current DPI setting to blue (for fast) or green (for normal) when the setup is completed.

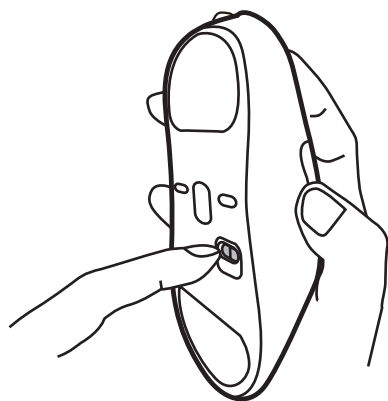

Click response time settings and corresponding buttons

Fast response time

LED status after setup

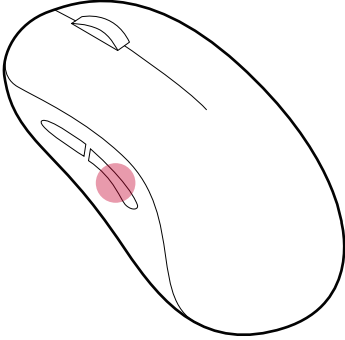

Normal response time

LED status after setup

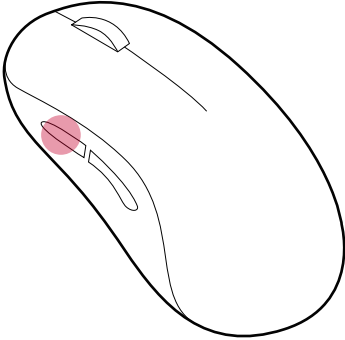

Enabling performance mode



Enabling performance mode delivers more responsive tracking experience. This feature is optional and can be enabled based on personal preferences.

i Note

- With performance mode enabled, the power consumption is increased. See [Charging time and battery time on page 21](#).
- Performance mode is supported in the latest firmware. Make sure your mouse has been updated to the latest firmware version. See [Updating firmware on page 34](#).

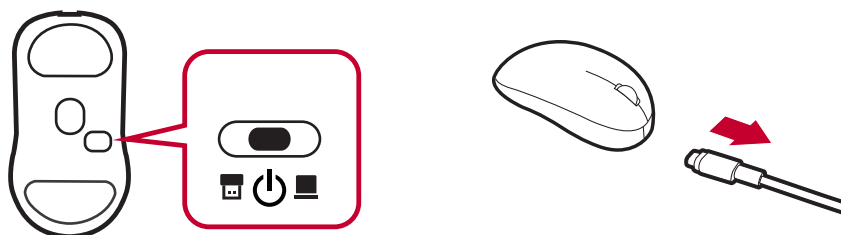
1. Switch to  from the bottom of the mouse to power off. Make sure the mouse is disconnected from PC.



2. While pressing and holding the corresponding buttons, power on the mouse by switching to  or  mode with another hand at the same time. The DPI indicator turns to yellow (function enabled) or blue (function disabled) when the setup is completed.

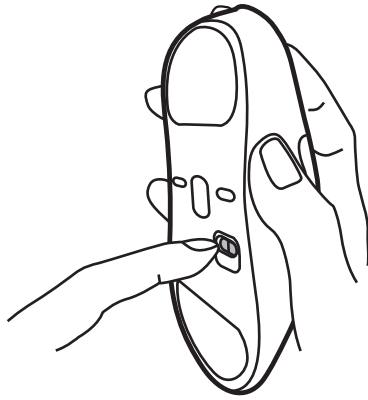

Performance mode settings and corresponding buttons

Performance mode on LED status after setup

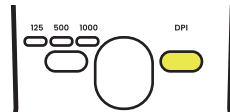
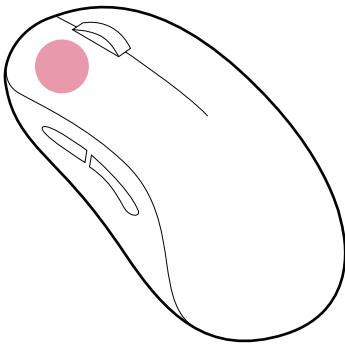

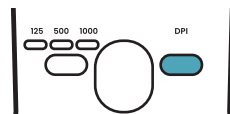
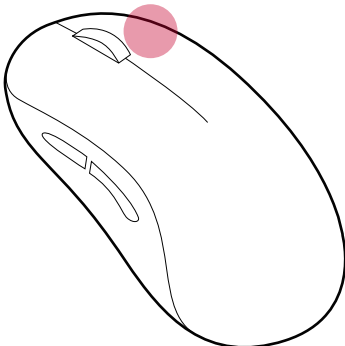

Performance mode off LED status after setup

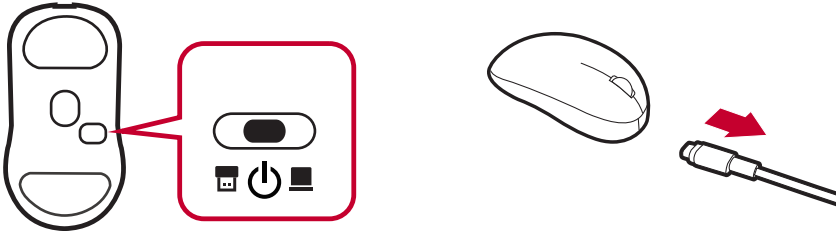

Enabling motion sync

1. Switch to  from the bottom of the mouse to power off. Make sure the mouse is disconnected from PC.



2. While pressing and holding the following corresponding **combination buttons** together for the desired setting, power on the mouse by switching to  or  mode with another hand at the same time. The polling rate indicators light up when the setup is completed.

Motion sync settings and combination buttons

Motion sync on

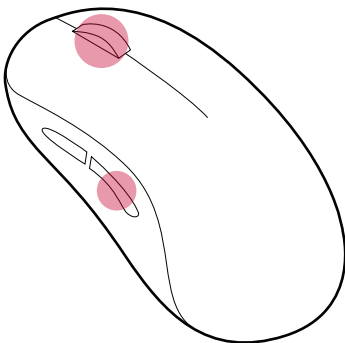

LED status after setup

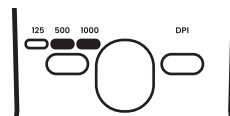

Motion sync off

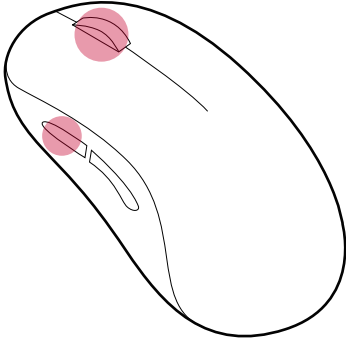

LED status after setup

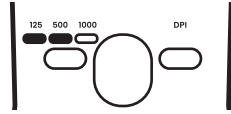

Updating firmware

Keep your mouse up to date to ensure optimal performance. Check [ZOWIESupport.BenQ.com](https://www.zowie.com/support) regularly for firmware updates, and read the included instructions before installation.

Care and maintenance

Cleaning

- Dusts on the optical sensor may keep the mouse from working properly. Use a clean and dry brush to clean the optical sensor.
- Clean the mouse by a clean and dry cleaning cloth.
- Water stains may keep the optical sensor from working properly. Avoid leaving water stains on the mouse.

Storage

A cable connector may be damaged if it is broken or bent. Pack and store the mouse properly for travel or if you will not use the mouse for a long period of time.

1. Switch to  from the bottom of the mouse to power off.
2. Before packing, remove the USB cable from your PC and mouse completely. Use a cable tie to organize the cable.



1

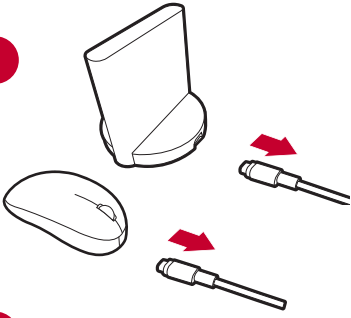

2



3

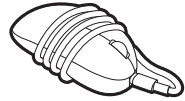
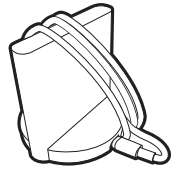

Specifications

Item	Description
Driver	No driver needed.
DPI	400 / 800 / 1000 / 1200 / 1600 / 3200
Polling rate	125 / 500 / 1000 / 2000 / 4000 Hz
USB	USB 2.0 / 3.0 plug & play
Buttons	7 buttons
Click response time	Fast / Normal
Connectivity	<ul style="list-style-type: none">• Wireless: 2.4G• Wired: USB Note: The mouse is switched to wired operation when it is connected to PC via the USB cable.
Connectors	<ul style="list-style-type: none">• USB-A on a PC• USB-C on a device
Battery life (performance mode disabled)	<ul style="list-style-type: none">• 80 hours when polling rate is 1000 Hz (constant movement)• 30 hours when polling rate is 2000 Hz (constant movement)• 24 hours when polling rate is 4000 Hz (constant movement)

Item	Description
Battery life (performance mode enabled)	<ul style="list-style-type: none"> • 30 hours when polling rate is 1000 Hz (constant movement) • 26 hours when polling rate is 2000 Hz (constant movement) • 21 hours when polling rate is 4000 Hz (constant movement)
Battery charging	Approximately 2 hours to reach a full charge
Switch	For power off / 4K enhanced receiver / USB receiver
Cable	USB-A to USB-C (2 meters/6.6 feet)

