

GCS1932M

2-Port 4K DisplayPort KVMP Switch with Dual Video Out and RS-232 (TAA Compliant)



- Turn a single video output to two monitors
- Up to Cinema 4K for one monitor or 4K UHD for two monitors
- Switch between 2 DisplayPort computers easily
- RS-232 Command Control
- Full cable set included for out-of-the-box setup

2-Port 4K DisplayPort KVMP Switch

Featuring a revolutionary combination of Cinema 4K resolution and enhanced user-friendly operation, IOGEAR's 2-Port 4K DisplayPort KVMP Switch with Dual Video Out and RS-232 provides the latest innovations in DisplayPort KVM technology. Connect your powerhouse computers and experience Cinema 4K resolution while switching between two computers and sharing two USB peripherals with the push of a button. Control two DisplayPort desktops or laptops with ease using a single keyboard, mouse, HDMI and/or DisplayPort monitors. Expand your USB 3.0 peripherals' connectivity with faster data transfer rates, and eliminate redundant hardware.

- Control and switch 2 computers with 1 keyboard, mouse, and monitor(s)
- Expand 1 DisplayPort input to 2 video outputs (DisplayPort/HDMI)
- With DisplayPort 1.1 Graphic Cards:
 - Dual 4K UHD (DisplayPort/HDMI) - mirrored screen only
- With DisplayPort 1.2 Graphic Cards:
 - 1 Monitor: Up to 5K Resolution
 - 2 Monitors: Up to 4K UHD (DisplayPort/HDMI)
 - 3 Monitors: Shared video bandwidth¹
- Convenient computer selection via front panel push-buttons, hotkeys, mouse², and RS-232 commands³
- 2-Port built-in USB 3.1 Gen 1 Hub for peripheral sharing with SuperSpeed 5 Gbps data transfer
- Independent switching of KVM, USB Peripherals, and 2.1 analog audio
- Supports Ultra Wide Monitors
- DisplayPort 1.2 and HDCP compliant
- DP++ (Dual-Mode DisplayPort) technology supports HDMI and DVI adapters⁴

- Support 7.1 HD audio through DisplayPort connection⁵
- Power on Detection - GCS1932M automatically switches to the next powered-on computer
- Hot pluggable - Add or remove computers without powering down the connection
- Mouse emulation supports most mouse drivers and multifunction mice
- Mac® keyboard support and emulation⁶
- Multilingual keyboard mapping supports English, French, and German keyboards
- Firmware upgradable
- All KVM and audio cables are included

Note:

¹ 3 Monitors setup example: Monitor #1 up to 3840 x 2160, Monitor #2 up to 2560 x 1600, Monitor #3 Up to 1920 x 1200

² Supported alongside mouse emulation mode using a USB 3-button mouse wheel

³ DB9 to RJ-11 cable not included

⁴ Dual-Mode DisplayPort (DP++) requires active HDMI and DVI adapters for most display setups

⁵ HD audio through DisplayPort cannot be switched independently

⁶ PC keyboard combinations emulate Mac® keyboards.



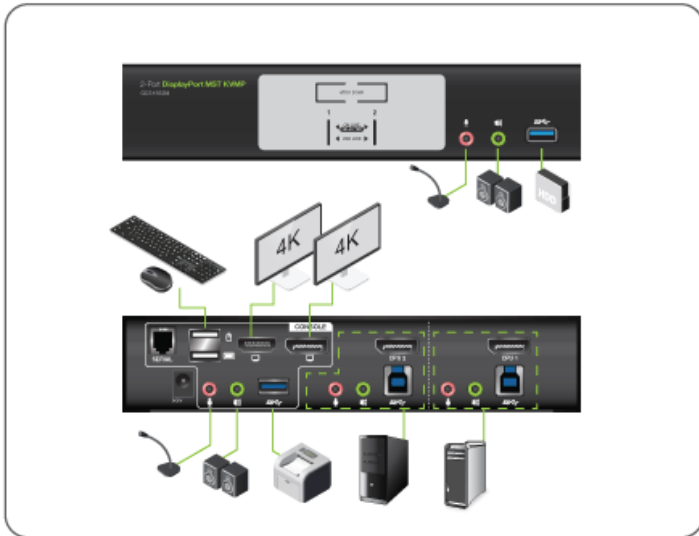

Requirements

Package Contents

- | | |
|--|---|
| <ul style="list-style-type: none"> • Console • DisplayPort or HDMI compatible monitor • Standard 104 key wired USB keyboard • Standard 2 or 3 button wired USB mouse • Microphone and speakers (optional) • • Computers • DisplayPort port • Type-A USB port • Audio ports (optional) • • Operating System • Windows® 7, Windows® 8.1, Windows® 10 • Mac OS® X 10.7 + | <ul style="list-style-type: none"> • 1 x GCS1932M 4K KVMP Dual Video Out Switch • 2 x DisplayPort Cables • 2 x USB 3.0 Cables • 2 x Audio Cable Sets • 1 x Power Adapter • 1 x Manual • 1 x Warranty |
|--|---|

*Use with video adapter may change performance

Specifications

Function	GCS1932M	Dimensions	GCS1932M
Computer Connections		Unit Dimensions	
Direct	2	Height	2.94" (7.47cm)
Port Selection	Pushbuttons, Hotkey, Mouse (mouse port switching only works with 3-key USB mouse wheel in emulation mode), RS-232 Commands	Depth	1.69" (4.29cm)
Console Connectors		Unit Package Dimensions	
Monitor	1 x DisplayPort (Black); 1 x HDMI (Black)	Width	11.25" (28.58cm)
Keyboard	1 x USB Type A (Black)	Height	6.81" (17.3cm)
Mouse	1 x USB Type A (Black)	Depth	4" (10.16cm)
Audio	2 x 3.5mm Mini Stereo Jack (Green; Front and Rear)	Master Carton	
Microphone	2 x 3.5mm Mini Stereo Jack (Pink; Front and Rear)	Width	12.5" (31.75cm)
CPU Connectors		Height	14.75" (37.47cm)
Monitor	2 x DisplayPort (Black)	Depth	12" (30.48cm)
Keyboard & Mouse	2 x USB 3.0 Type B (Blue)	Master Carton Qty.	6
Audio	2 x 3.5mm Mini Stereo Jack (Green)	Weight	
Microphone	2 x 3.5mm Mini Stereo Jack (Pink)	Master Carton Wt.	24.7lb (11.24kg)
Switches		Unit Pack Wt.	3.68lb (1.67kg)
F/W Upgrade	1 x USB Type B	Unit Wt.	1.45lb (0.66kg)
Port Selection	2 x Pushbutton		
Connectors			
USB	2 x USB 3.0 Type A (Blue; Front and Rear)		
Serial	1 x RJ-11 Female		
LEDs			
On Line	2 x Orange		
Selected	2 x Orange		
Audio	2 x Orange		
USB Peripherals	2 x Green		
Emulation			
Keyboard	USB		
Mouse	USB		
Video Resolution	up to 4096 x 2160 @60 Hz (4K DCI)		
Scan Interval	1-99 seconds (5 seconds default)		
Power Consumption	DC 5V		
Environment			
Operation Temperature	0-50 C		
Storage Temperature	-20-60 C		
Humidity	0-80% RH, Non-condensing		
Housing			
Case	Metal		