



Product guide

HP LaserJet Enterprise 6500 Monochrome Printers Series

The ultimate A4 enterprise printer for large teams

Built to simplify document workflows and handle high-volume printing with blazing-fast speeds and customizable features. It integrates effortlessly with your existing fleet, is future-ready with upgradable solutions, and is the world's most secure to protect your data.³



Get the power to be more productive



Simplify work with automated workflows



The world's most secure printing technology³



Save energy and help reduce waste



Secure. Scalable. Smart. Printing that evolves with your business.

Revolutionize document workflows with the ultimate A4 enterprise black-and-white MFPs and printers. Built for effortless integration, automated operation, and simplified management.

1. **The power to be more productive**

Maximize productivity with fast printer wake-up and speeds, tailor your workflows with customizable printer and software configurations, and keep your fleet future-ready with FutureSmart firmware upgrades.^{1,2}

2. **Simplify work with automated workflows**

Work smarter wherever you are in your digital transformation. Choose the perfect fit, on-prem or cloud, and seamlessly integrate your device into existing fleets and workflows with compatibility built for your environment.

3. **Protect your business**

HP Wolf Enterprise Security is the world's most secure printing technology, seamlessly integrating protection into every aspect of your business. Work and grow with confidence, keeping your data, workflows, and business safe from evolving threats.³

4. **Save energy and help reduce waste**

Help reduce waste and minimize your footprint through eco-labels, energy-efficient designs,⁴ and TerraJet Cartridges made from recycled plastic.⁵ All backed by an industry-leading recycling program.⁶

Get the power to be more productive



Save time with fast printer wake-up and print speeds up to 57 ppm¹ to power through your tasks.



Stay ahead with FutureSmart firmware updates, keeping your fleet always up to date.²



Customize workflows your way with printer and software configurations for your unique needs.

Simplify work with automated workflows



HP Workpath and HP Open Extensibility Platform

Wherever you are in your digital transformation, find the perfect fit—on-premises or cloud-based print solutions, tailored to your needs.



Fleet management

Easily integrate your device into your fleet and workflows with seamless compatibility.

Protect your business with the most secure printers³



Keep your work always protected—HP Wolf silently detects and recover your printer from cyberattacks.³



Simplify compliance—HP Security Manager enforces policies and monitors your fleet, so you're always audit-ready, effortlessly.⁷



Grant access only to verified users and devices with HP's Zero Trust Print Architecture ensuring your users and network stays secure from evolving cyber threats.⁸



Get peace of mind with future-ready security for your network with the world's first printers to protect against quantum computer attacks.⁹

Save energy and help reduce waste



Reduce costs and environmental impact with printers and toner cartridges that use less energy.¹⁰



Meet the rigorous criteria of EPEAT Gold, Energy Star, and Blue Angel with our energy-efficient designs.⁴



Help reduce plastic waste with TerraJet Toner Cartridges designed with recycled plastics.⁵



Easily recycle your used HP TerraJet Toner Cartridges for free through the HP Planet Partners Program.⁶

Exceptional performance, thoughtfully designed

The next generation of HP Toner and Cartridge technology, HP TerraJet Toner Cartridges and packaging are designed for efficient toner use with less waste,¹² outstanding quality printing, and built-in security.^{13,14}

- Original HP TerraJet Toner Cartridges and packaging are designed with less plastic and uses less energy when printing.^{10,15,16}
- Original HP TerraJet Toner, the next generation of toner, features efficient toner use¹¹ and outstanding quality printing with improved performance. Experience uniform clear, sharp black text and rich tones with accurate contrast and shading.
- HP takes security seriously. Original HP TerraJet Toner Cartridges are designed for security with tamper-resistant chips, firmware and packaging.¹²



HP LaserJet Enterprise 6500n Walkaround

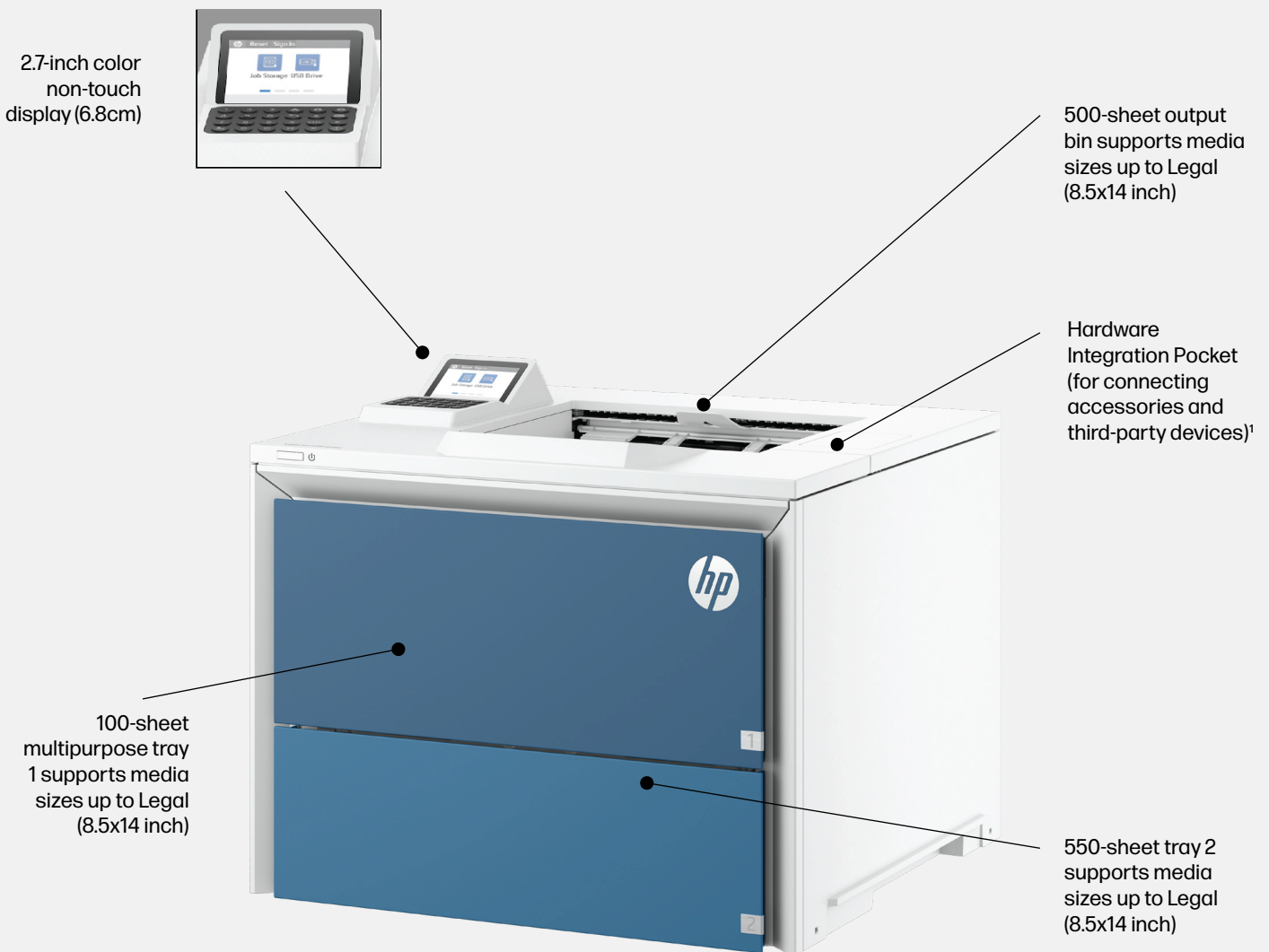

Product availability may differ per Market, please contact your HP representative for availability information.



HP LaserJet Enterprise 6500dn Walkaround

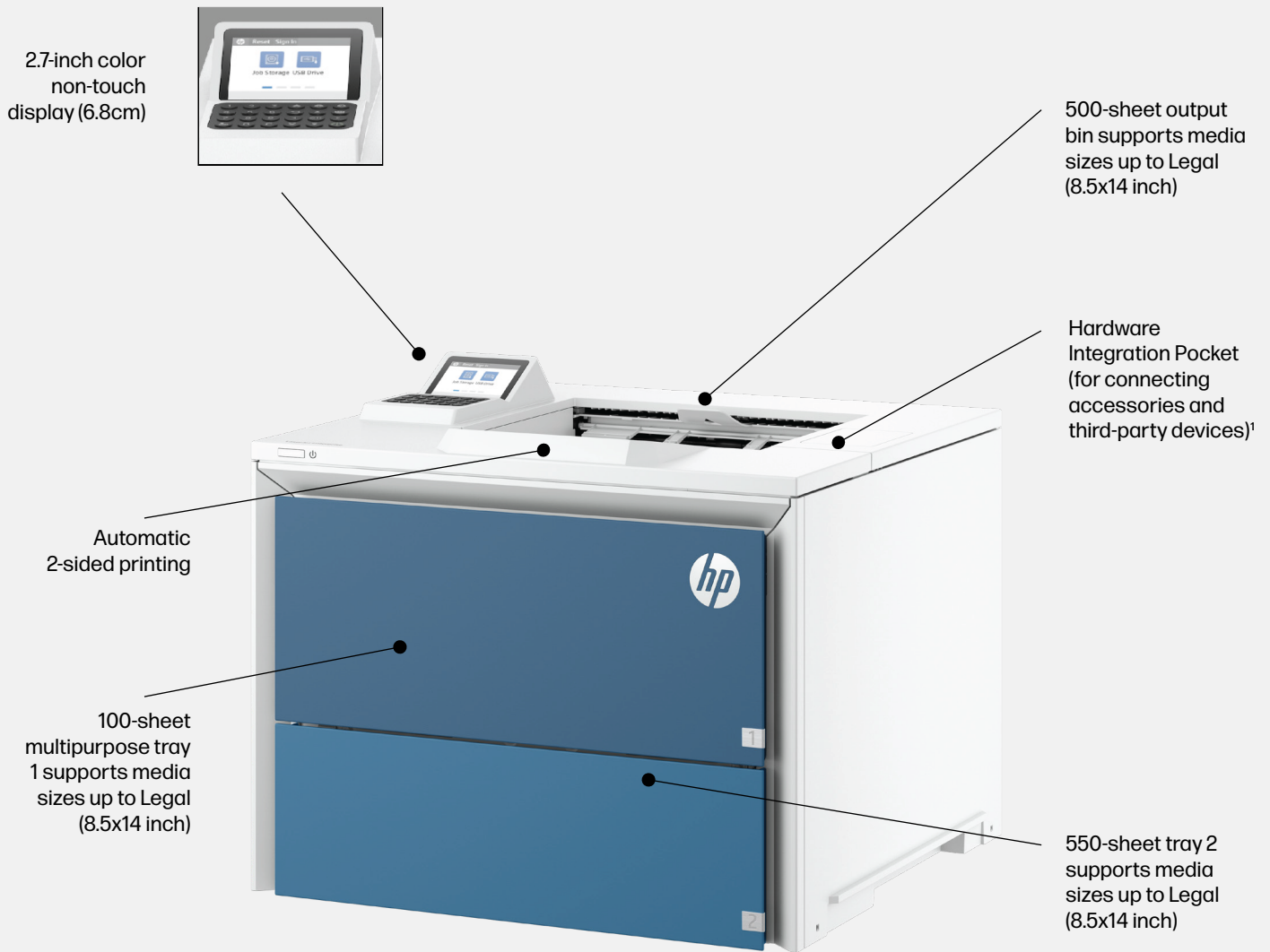

Gigabit Ethernet Port

Rear Hi-Speed USB 2.0 host port

Rear Hi-Speed USB 2.0 device port

Product availability may differ per Market, please contact your HP representative for availability information.



HP LaserJet Enterprise 6501dn Walkaround

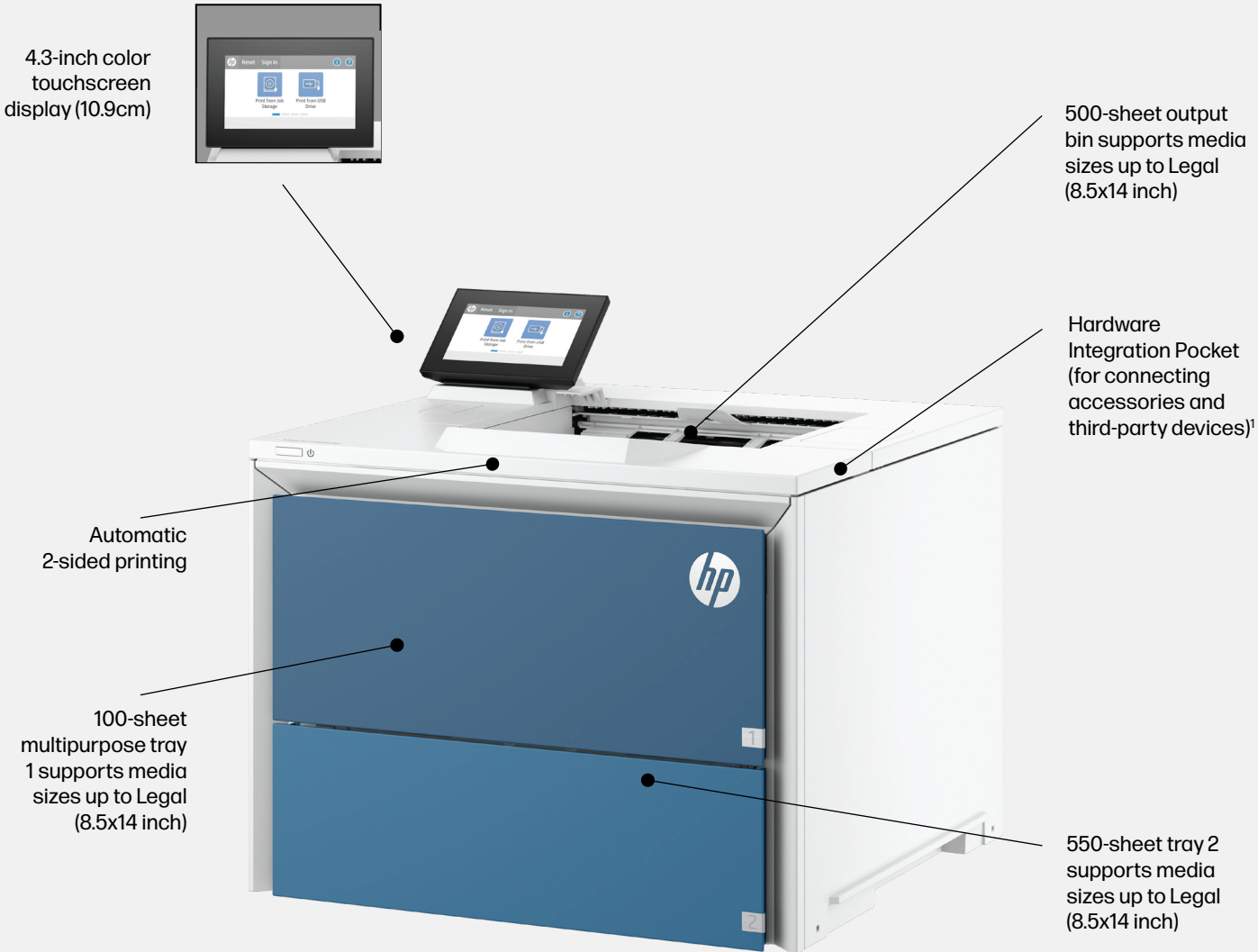

Gigabit Ethernet Port

Rear Super Speed USB 3.0 host port

Front Hi-Speed USB 2.0 host port

Rear Super Speed USB 3.0 device port

HP LaserJet Enterprise 6500 Series comparison



| Model | HP LaserJet Enterprise 6500n | HP LaserJet Enterprise 6500dn | HP LaserJet Enterprise 6501dn |
|----------------------------------|-----------------------------------|-----------------------------------|-----------------------------------|
| Product Number | A29ZBA | A29ZCA | 675T2A |
| Functions | Print | Print | Print |
| Print speed (up to) ² | 57/55 ppm (Letter/A4) | 57/55 ppm (Letter/A4) | 57/55 ppm (Letter/A4) |
| Auto 2-sided printing | No | Yes | Yes |
| Connectivity | USB, Ethernet | USB, Ethernet | USB, Ethernet |
| Walk-up USB | No | No | Yes |
| Control panel | 2.7" Non-touch | 2.7" Non-touch | 4.3" Color Touchscreen |
| Input capacity | 650/2,850 (std/max) | 650/2,850 (std/max) | 650/2,850 (std/max) |
| Memory and Storage* | 2GB RAM, 8GB eMMC | 2GB RAM, 8GB eMMC | 4GB RAM, 32GB eMMC |
| RMPV ⁴ | 3,750 to 18,750 | 3,750 to 18,750 | 3,750 to 18,750 |
| Workpath enabled | No | No | Yes |
| Extensibility | HP FutureSmart, ³ OXPd | HP FutureSmart, ³ OXPd | HP FutureSmart, ³ OXPd |

Product workarounds and series comparison footnotes:

1. Solutions deployed through the Hardware Integration Pocket (HIP) may require additional purchase.
2. Measured using ISO/IEC 24734, excludes first set of test documents. For more information, see <http://www.hp.com/go/printerclaims>. Exact speed varies depending on the system configuration, software application, driver, and document complexity.
3. Some features enabled by future HP FutureSmart firmware upgrades may not be available on older devices, if for example, physical product characteristics limit the functionality of the new feature.
4. HP recommends that the number of pages per month of imaged output be within a stated range for optimum device performance, based on factors including supplies replacement intervals and device life over an extended warranty period, the lowest monthly volume shown is based on 60-month usage and the highest 12-month usage.

*Optional storage options are available depending on configuration. Please contact your HP representative for details. Product availability may differ per Market, please contact your HP representative for availability information.

HP LaserJet Enterprise 6500n technical specifications

| | | | | |
|-----------------------------------|---|---|----------|--|
| Processor speed | Dual Core (1.4 Ghz) | | | |
| Orderable supplies | HP LaserJet Transfer Roller Kit C35T5A; HP LaserJet Tray Roller Kit C35T6A | | | |
| Printer smart software features | Print preview, print multiple pages per sheet (2, 4, 6, 9, 16), collation, watermarks, store print jobs | | | |
| Power consumption description | 760 watts (Printing), 7.5 watts (Ready), 0.93 watts (Sleep), 0.05 watts (Auto-Off), 0.05 watts (Off) | | | |
| Power supply | Type | Built-in 3-Pin 115V or 220V Internal Power Supply | Required | Input Voltage: 100V - 127V AC, 50 - 60Hz, 9.7A; or Input Voltage: 220V - 240V AC, 50 - 60Hz, 5.0A |
| What is in the box | HP LaserJet Enterprise Printer; HP Black Original LaserJet Toner Cartridge (~10,000 yield), Documentation (Hardware Install Guide); Power cord. | | | |
| Replacement cartridges | HP 160 Black Original LaserJet Toner Cartridge | | | |
| Supplies feature | HP TerraJet Cartridge | | | |
| Electromagnetic emission standard | CISPR 22:2008 (International) Class A, CISPR 32:2015 (International) Class A / EN 55032:2015 Class A + A11:2020; CISPR 35:2016 (International) / EN 55035:2017 + A11:2020, EN IEC 61000-3-2:2019 +A11:2020, EN IEC 61000-3-3:2013+A1:2019 + A2:2021, FCC 47 CFR Part 15 Class A, ICES-003, Issue 7 Class A. Other EMC approvals as required by individual countries. | | | |
| Safety approvals and requirements | IEC 62368-1:2014; EN 62368-1:2014 +A11:2017; IEC 62368-1:2018; EN 62368-1:2020 +A11:2020; EN 60825-1:2014 +A11:2021/IEC 60825-1:2014 (Class 1 Laser Product); EN 62479:2010/IEC 62479:2010; Low Voltage Directive 2014/35/EU with CE Mark (Europe); GS Certificate (Germany, Europe); UL/ cUL Listed and UC CoC (US/Canada); UL62368-1 3rd Ed. 2021-10-22, CSA C22.2 No. 62368-1-19, 3rd Ed.; Compliance with Laser safety standards 21 CFR 1040.10 and 1040.11 except for deviations pursuant to Laser notice No. 56, Dated May 8, 2019; Other safety approvals as required by individual countries. | | | |
| ENERGY STAR® certified | Yes | | | |
| Ecolabels | CECP; IT ECO Declaration; Blue Angel; EPEAT® Gold India; EPEAT® Gold Australia; EPEAT® Gold Canada; EPEAT® Gold US; SEPA; KOECO; ENERGY STAR® certified; Korea MEPS; Vietnam MEPS | | | |
| Blue Angel compliance | Blue Angel DE-UZ 219—only ensured when using Original HP supplies | | | |
| Sustainable impact specifications | Recyclable through HP Planet Partners; Contains at least 5% post-consumer recycled plastic | | | |
| Network capabilities | Via HP Jetdirect Ethernet embedded print server (standard) which supports: 10Base-T, 100Base-Tx, 1000Base-T; 802.3az (EEE) support on Fast Ethernet and Gig Links; IPsec (standard); WiFi 2.4/5 GHz wireless networking (optional); Second Ethernet port (optional). | | | |

HP LaserJet Enterprise 6500n

technical specifications

| | | | | |
|---|--|---|--------------------------------------|--|
| Supported network protocols | Via built-in networking solution: TCP/IP, IPv4, IPv6; Print: TCP-IP port 9100 Direct Mode, LPD (raw queue support only), Web Services Printing, IPP 2.0, Apple AirPrint™, HP ePrint, FTP Print, Google Cloud Print; Discovery: SLP, Bonjour, Web Services Discovery; IP Config: IPv4 (BootP, DHCP, AutoIP, Manual, TFTP Config, ARP-Ping), IPv6 (Stateless Link-Local and via Router, Statefull via DHCPv6); Management: SNMPv2/v3, HTTP/HTTPs, Telnet, TFTP Config, FTP FW Download, Syslog; Security: SNMPv3, SSL Cert Management, Firewall, ACL, 802.1x | | | |
| Mobile printing capability | Apple AirPrint™; Mopria™ certified | | | |
| Package dimensions Metric | Metric | 493 x 565 x 442 mm | Imperial | 19.41 x 22.24 x 17.4 in |
| Max. dimensions Metric | Metric | 400 x 725 x 340 mm (control panel fully upright, rear jam access door open, front cartridge door open, all feeders open and extended) | Imperial | 15.7 x 28.5 x 13.4 in (control panel fully upright, rear jam access door open, front cartridge door open, all feeders open and extended) |
| Product dimensions Metric | Metric | 400 x 400 x 340 mm | Imperial | 15.7 x 15.7 x 13.4 in |
| Display description | 400 x 400 x 340 mm | | | |
| Acoustic power emissions (active, printing) | 6.8 B(A) | | | |
| Acoustic pressure emissions bystander (ready) | 3.2 B(A) | | | |
| Operating humidity range | 10 to 80% RH | | | |
| Operating humidity (recommended) | 30 to 70% RH | | | |
| Operating temperature range | Celsius: 15 to 30°C | | Fahrenheit: 59 to 86°F | |
| | Recommended Celsius: 17.5 to 25°C | | Recommended Fahrenheit: 63.5 to 77°F | |
| Storage Temperature Range | Celsius: 20 to 40°C | | Fahrenheit: 4 to 104°F | |
| Memory | 2 GB | | | |
| Print Resolution Technologies | Normal (600x600 dpi with FastRes), Fine Lines (1200x1200 dpi), Quickview (300x300 dpi) | | | |
| Print speed | A4 | 55 ppm | Letter | 57 ppm |
| First Page Out | Black (A4, ready), 3.9 seconds | | Black (Letter, ready), 3.7 seconds | |
| Monthly duty cycle | A4 | Up to 225,000 pages | Letter | Up to 225,000 pages |
| Recommended Monthly Page Volume | Up to 3,750 to 18,750 pages | | | |
| Fonts and typefaces | 105 internal TrueType fonts scalable in HP PCL, 92 internal scalable fonts in HP postscript level 3 emulation (Euro symbol built-in); 1 internal Unicode Fonts (Andale Mono WorldType); 2 Internal Windows Vista 8 Fonts (Calibri, Cambria); Additional font solutions available via third-party flash memory cards; HP LaserJet Fonts and IPDS Emulation available at http://www.hp.com/go/laserjetfonts | | | |

HP LaserJet Enterprise 6500n

technical specifications

| | |
|--|--|
| Hard disk | Standard, 8 GB eMMC |
| Print languages, standard | HP PCL 6, HP PostScript level 3 emulation, native PDF printing (v 1.7), Apple AirPrint™ |
| Printer management | HP Printer Assistant, HP Device Toolbox, HP Web JetAdmin Software, HP JetAdvantage Security Manager, HP SNMP Proxy Agent, HP WS Pro Proxy Agent, Printer Administrator Resource Kit for HP Universal Print Driver (Driver Configuration Utility - Driver Deployment Utility - Managed Printing Administrator) |
| Top key features | TerraJet cartridge |
| Target number of users and print volume | For teams over 25 users; Prints up to 18,750 pages/month |
| AIO functions | Print |
| Print technology | Laser |
| Paper Handling Optional/input | Optional: 1 x 550-sheet paper feeder, 1 x 550-sheet feeder with cabinet, 3 x 550-sheet feeder, envelope feeder kit |
| Paper Handling Standard/input | 100-sheet multipurpose feeder, 550-sheet input feeder |
| Paper Handling Standard/output | 500-sheet output feeder |
| Input Capacity, Max | Up to 2850 sheets |
| Product Short Name | 6500n |
| Typical Electricity Consumption (TEC) number | 0.528 kWh/Week (Blue Angel); 0.621 kWh/Week (ENERGY STAR 3.0) |
| Number of Simultaneous Users (local + network) | 10-30 Users |
| Security management | Identity management: Kerberos authentication; LDAP authentication; 1000 user PIN codes; optional HP and 3rd party advanced authentication solutions (e.g.; badge readers); Network: IPsec/ firewall with Certificate; Pre-Shared Key; and Kerberos authentication; Supports WJA-10 IPsec configuration Plug-in; 802.1X authentication (EAP-PEAP; EAP-TLS); SNMPv3; HTTPS; Certificates; Access Control List; Data: Storage Encryption; Encrypted PDF & Email (uses FIPS 140 validated cryptographic libraries from Microsoft); Secure Erase; SSL/TLS (HTTPS); Encrypted Credentials; Device: Security lock slot; USB port disablement; hardware integration pocket for security solutions; Hardware-based Memory Shield™ with Control Flow Integrity (CFI) in-device monitoring for attacks; SureStart Secure Boot - BIOS Integrity Checking with self-healing capability; Whitelisting - loads only known good code (DLLs, EXEs, ...); Security management: Compatible with Device Security Syslog Messages processed and accessible in Arcsight and Splunk SIEMs |
| Mac compatible | Yes |
| Software included | No software solutions are included in the Box, only on http://hp.com ; |
| Media Types | Paper (plain, light, bond, recycled, heavy, extra heavy, cardstock, pre-printed, pre-punched, colored, rough, heavy rough), mono transparency, labels, letterhead, envelope, heavy envelope |

HP LaserJet Enterprise 6500n

technical specifications

| | | |
|--|---|---|
| Standard Media Sizes | Metric: Tray 1: A4, A5, A6, RA4, B5 (JIS), B6 (JIS), 10 x 15 cm, Oficio (216 x 340), 16K, postcards (JIS single and double), envelopes (B5, C5, C6, DL); Tray 2: A4, A5, A6, RA4, B5 (JIS), B6 (JIS), Oficio (216 x 340), 16K, postcards (JIS double); Optional 550-sheet Tray: A4, A5, A6, RA4, B5 (JIS), B6 (JIS), Oficio (216 x 340), 16K, postcards (JIS double); Optional Automatic Duplexer: A4, RA4, Oficio (216 x 340); Envelope Feeder Accessory: B5, C5, C6, DL | Imperial: Tray 1: Letter, Legal, Executive, Statement, 3 x 5 in, 4 x 6 in, 5 x 7 in, 5 x 8 in, 8.5 x 13 in, Envelopes (No. 9, No. 10, Monarch); Tray 2: Letter, Legal, Executive, Statement, 5 x 7 in, 5 x 8 in, 8.5 x 13 in; Optional 550-Sheet Tray: Letter, Legal, Executive, Statement, 5 x 7 in, 5 x 8 in, 8.5 x 13 in; Optional Automatic Duplexer: Letter, Legal, 8.5 x 13 in; Envelope Feeder Accessory: No. 9, No. 10, Monarch |
| Media sizes custom | Metric: Standard Optional Paper Feeder: A4; A5; A6; RA4; B5 (JIS); B6 (JIS); Oficio (216 x 340); 16K; postcards (JIS double); 105 x 148 to 216 x 356 mm; Envelope Feeder Accessory: Envelopes; 98 x 162 to 178 x 254 mm | Imperial: Tray 1: 3 x 5 to 8.5 x 14 in; Tray 2: 4.14 x 5.83 to 8.5 x 14 in; Optional 550-sheet Tray: 4.14 x 5.83 to 8.5 x 14 in; Envelope Feeder Accessory: 3.86 x 6.38 to 7 x 10 in |
| Media Size, Tray 1 (metric) | A4; A5; A6; RA4; B5 (JIS); B6 (JIS); 10 x 15 cm; Oficio (216 x 340); 16K; postcards (JIS single and double); envelopes (B5, C5, C6, DL); 76 x 127 to 216 x 356 mm | |
| Media weights supported, by paper path | Metric: Feeder 1: 60 to 200 g/m ² ; Feeder 2: 60 to 120 g/m ² | Imperial: Feeder 1: 16 to 53 lb bond (plain), 16 to 24 lb (envelopes); Feeder 2: 16 to 32 lb bond (plain) |
| Media Weights Supported, Tray 1 (metric) | 60 to 200 g/m ² | |
| Key media sizes supported | Metric: A4; Envelopes; A5 | Imperial: 4 x 6 in; Letter; Legal; Envelopes; 3 x 5 in |
| Control Panel | 2.7-in (6.86 cm) Non-touch QVGA LCD (color graphics) display with 24-key pad | |
| System Requirements | Minimum - 2 GB available hard disk space, Internet connection, USB port, Internet browser. For additional OS hardware requirements see microsoft.com | |
| Manufacturer Warranty | One-year, onsite warranty. Warranty and support options vary by product, country and local legal requirements. Contact your Contractual Vendor or go to hp.com/support to learn about HP award winning service and support options in your region. (warranty code 4G; warranty ID A001) | |
| Weight Metric | Metric: 26.5 Kg | |
| Package weight | Metric: 39 Kg | |

HP LaserJet Enterprise 6500dn technical specifications

| | | | | |
|-----------------------------------|---|---|----------|--|
| Processor speed | Dual Core (1.4 Ghz) | | | |
| Orderable supplies | HP LaserJet Transfer Roller Kit C35T5A; HP LaserJet Tray Roller Kit C35T6A | | | |
| Printer smart software features | Print preview, duplex printing, print multiple pages per sheet (2, 4, 6, 9, 16), collation, watermarks, store print jobs | | | |
| Power consumption description | 760 watts (Printing), 7.5 watts (Ready), 0.93 watts (Sleep), 0.05 watts (Auto-Off), 0.05 watts (Off) | | | |
| Power supply | Type | Built-in 3-Pin 115V or 220V Internal Power Supply | Required | Input Voltage: 100V - 127V AC, 50 - 60Hz, 9.7A; or Input Voltage: 220V - 240V AC, 50 - 60Hz, 5.0A |
| What is in the box | HP LaserJet Enterprise PRINTER; HP Original LaserJet Toner Cartridge (~10k page yield); Documentation (Hardware Install Guide, regulatory flyer); Power cord | | | |
| Replacement cartridges | HP 160 Black Original LaserJet Toner Cartridge | | | |
| Supplies feature | HP TerraJet Cartridge | | | |
| Electromagnetic emission standard | CISPR 22:2008 (International) Class A, CISPR 32:2015 (International) Class A / EN 55032:2015 Class A + A11:2020; CISPR 35:2016 (International) / EN 55035:2017 + A11:2020, EN IEC 61000-3-2:2019 + A11:2020, EN IEC 61000-3-3:2013+A1:2019 + A2:2021, FCC 47 CFR Part 15 Class A, ICES-003, Issue 7 Class A. Other EMC approvals as required by individual countries. | | | |
| Safety approvals and requirements | IEC 62368-1:2014; EN 62368-1:2014 +A11:2017; IEC 62368-1:2018; EN 62368-1:2020 +A11:2020; EN 60825-1:2014 +A11:2021/IEC 60825-1:2014 (Class 1 Laser Product); EN 62479:2010/IEC 62479:2010; Low Voltage Directive 2014/35/EU with CE Mark (Europe); GS Certificate (Germany, Europe); UL/ cUL Listed and UC CoC (US/Canada); UL62368-1 3rd Ed. 2021-10-22, CSA C22.2 No. 62368-1-19, 3rd Ed.; Compliance with Laser safety standards 21 CFR 1040.10 and 1040.11 except for deviations pursuant to Laser notice No. 56, Dated May 8, 2019; Other safety approvals as required by individual countries. | | | |
| ENERGY STAR® certified | Yes | | | |
| Ecolabels | CECP; IT ECO Declaration; Blue Angel; EPEAT® Gold India; EPEAT® Gold Australia; EPEAT® Gold Canada; EPEAT® Gold US; SEPA; KOECO; ENERGY STAR® certified; Korea MEPS; Vietnam MEPS | | | |
| Blue Angel compliance | Blue Angel DE-UZ 219—only ensured when using Original HP supplies | | | |
| Sustainable impact specifications | Recyclable through HP Planet Partners; Contains at least 5% post-consumer recycled plastic | | | |
| Network capabilities | Via HP Jetdirect Ethernet embedded print server (standard) which supports: 10Base-T, 100Base-Tx, 1000Base-T; 802.3az (EEE) support on Fast Ethernet and Gig Links; IPsec (standard); WiFi 2.4/5 GHz wireless networking (optional); Second Ethernet port (optional). | | | |

HP LaserJet Enterprise 6500dn

technical specifications

| | | | | |
|---|--|---|--------------------------------------|--|
| Supported network protocols | Via built-in networking solution: TCP/IP, IPv4, IPv6; Print: TCP-IP port 9100 Direct Mode, LPD (raw queue support only), Web Services Printing, IPP 2.0, Apple AirPrint™, HP ePrint, FTP Print, Google Cloud Print; Discovery: SLP, Bonjour, Web Services Discovery; IP Config: IPv4 (BootP, DHCP, AutoIP, Manual, TFTP Config, ARP-Ping), IPv6 (Stateless Link-Local and via Router, Statefull via DHCPv6); Management: SNMPv2/v3, HTTP/HTTPS, Telnet, TFTP Config, FTP FW Download, Syslog; Security: SNMPv3, SSL Cert Management, Firewall, ACL, 802.1x | | | |
| Mobile printing capability | Apple AirPrint™; Mopria™ certified | | | |
| Package dimensions Metric | Metric | 493 x 565 x 442 mm | Imperial | 19.41 x 22.24 x 17.4 in |
| Max. dimensions Metric | Metric | 400 x 725 x 340 mm (control panel fully upright, rear jam access door open, front cartridge door open, all feeders open and extended) | Imperial | 15.7 x 28.5 x 13.4 in (control panel fully upright, rear jam access door open, front cartridge door open, all feeders open and extended) |
| Product dimensions Metric | Metric | 400 x 400 x 340 mm | Imperial | 15.7 x 15.7 x 13.4 in |
| Display description | 400 x 400 x 340 mm | | | |
| Acoustic power emissions (active, printing) | 6.8 B(A) | | | |
| Acoustic pressure emissions bystander (ready) | 3.2 B(A) | | | |
| Operating humidity range | 10 to 80% RH | | | |
| Operating humidity (recommended) | 30 to 70% RH | | | |
| Operating temperature range | Celsius: 15 to 30°C | | Fahrenheit: 59 to 86°F | |
| | Recommended Celsius: 17.5 to 25°C | | Recommended Fahrenheit: 63.5 to 77°F | |
| Storage Temperature Range | Celsius: 20 to 40°C | | Fahrenheit: 4 to 104°F | |
| Memory | 2 GB | | | |
| Print Resolution Technologies | Normal (600x600 dpi with FastRes), Fine Lines (1200x1200 dpi), Quickview (300x300 dpi) | | | |
| Print speed | A4 | 55 ppm | Letter | 57 ppm |
| First Page Out | Black (A4, ready), 3.9 seconds | | Black (Letter, ready), 3.7 seconds | |
| Monthly duty cycle | A4 | Up to 225,000 pages | Letter | Up to 225,000 pages |
| Recommended Monthly Page Volume | Up to 3,750 to 18,750 pages | | | |
| Fonts and typefaces | 105 internal TrueType fonts scalable in HP PCL, 92 internal scalable fonts in HP postscript level 3 emulation (Euro symbol built-in); 1 internal Unicode Fonts (Andale Mono WorldType); 2 Internal Windows Vista 8 Fonts (Calibri, Cambria); Additional font solutions available via third-party flash memory cards; HP LaserJet Fonts and IPDS Emulation available at http://www.hp.com/go/laserjetfonts | | | |

HP LaserJet Enterprise 6500dn technical specifications

| | |
|--|--|
| Hard disk | Standard, 8 GB eMMC |
| Print languages, standard | HP PCL 6, HP PostScript level 3 emulation, native PDF printing (v 1.7), Apple AirPrint™ |
| Printer management | HP Printer Assistant, HP Device Toolbox, HP Web JetAdmin Software, HP JetAdvantage Security Manager, HP SNMP Proxy Agent, HP WS Pro Proxy Agent, Printer Administrator Resource Kit for HP Universal Print Driver (Driver Configuration Utility - Driver Deployment Utility - Managed Printing Administrator) |
| Top key features | Two-sided printing; TerraJet cartridge |
| Target number of users and print volume | For teams over 25 users; Prints up to 18,750 pages/month |
| AIO functions | Print |
| Duplex print options | Automatic (standard) |
| Print technology | Laser |
| Paper Handling Optional/input | Optional: 1 x 550-sheet paper feeder, 1 x 550-sheet feeder with cabinet, 3 x 550-sheet feeder, envelope feeder kit |
| Paper Handling Standard/input | 100-sheet multipurpose feeder, 550-sheet input feeder |
| Paper Handling Standard/output | 500-sheet output feeder |
| Input Capacity, Max | Up to 2850 sheets |
| Product Short Name | 6500dn |
| Typical Electricity Consumption (TEC) number | 0.528 kWh/Week (Blue Angel); 0.621 kWh/Week (ENERGY STAR 3.0) |
| Number of Simultaneous Users (local + network) | 10-30 Users |
| Security management | Identity management: Kerberos authentication; LDAP authentication; 1000 user PIN codes; optional HP and 3rd party advanced authentication solutions (e.g.; badge readers); Network: IPsec/ firewall with Certificate; Pre-Shared Key; and Kerberos authentication; Supports WJA-10 IPsec configuration Plug-in; 802.1X authentication (EAP-PEAP; EAP-TLS); SNMPv3; HTTPS; Certificates; Access Control List; Data: Storage Encryption; Encrypted PDF & Email (uses FIPS 140 validated cryptographic libraries from Microsoft); Secure Erase; SSL/TLS (HTTPS); Encrypted Credentials; Device: Security lock slot; USB port disablement; hardware integration pocket for security solutions; Hardware-based Memory Shield™ with Control Flow Integrity (CFI) in-device monitoring for attacks; SureStart Secure Boot - BIOS Integrity Checking with self-healing capability; Whitelisting - loads only known good code (DLLs, EXEs, ...); Security management: Compatible with Device Security Syslog Messages processed and accessible in Arcsight and Splunk SIEMs |
| Mac compatible | Yes |
| Software included | No software solutions are included in the Box, only on http://hp.com ; |
| Media Types | Paper (plain, light, bond, recycled, heavy, extra heavy, cardstock, pre-printed, pre-punched, colored, rough, heavy rough), mono transparency, labels, letterhead, envelope, heavy envelope |

HP LaserJet Enterprise 6500dn technical specifications

| | | |
|--|---|---|
| Standard Media Sizes | Metric: Tray 1: A4, A5, A6, RA4, B5 (JIS), B6 (JIS), 10 x 15 cm, Oficio (216 x 340), 16K, postcards (JIS single and double), envelopes (B5, C5, C6, DL); Tray 2: A4, A5, A6, RA4, B5 (JIS), B6 (JIS), Oficio (216 x 340), 16K, postcards (JIS double); Optional 550-sheet Tray: A4, A5, A6, RA4, B5 (JIS), B6 (JIS), Oficio (216 x 340), 16K, postcards (JIS double); Optional Automatic Duplexer: A4, RA4, Oficio (216 x 340); Envelope Feeder Accessory: B5, C5, C6, DL | Imperial: Tray 1: Letter, Legal, Executive, Statement, 3 x 5 in, 4 x 6 in, 5 x 7 in, 5 x 8 in, 8.5 x 13 in, Envelopes (No. 9, No. 10, Monarch); Tray 2: Letter, Legal, Executive, Statement, 5 x 7 in, 5 x 8 in, 8.5 x 13 in; Optional 550-Sheet Tray: Letter, Legal, Executive, Statement, 5 x 7 in, 5 x 8 in, 8.5 x 13 in; Optional Automatic Duplexer: Letter, Legal, 8.5 x 13 in; Envelope Feeder Accessory: No. 9, No. 10, Monarch |
| Media sizes custom | Metric: Standard Optional Paper Feeder: A4; A5; A6; RA4; B5 (JIS); B6 (JIS); Oficio (216 x 340); 16K; postcards (JIS double); 105 x 148 to 216 x 356 mm; Envelope Feeder Accessory: Envelopes; 98 x 162 to 178 x 254 mm | Imperial: Tray 1: 3 x 5 to 8.5 x 14 in; Tray 2: 4.14 x 5.83 to 8.5 x 14 in; Optional 550-sheet Tray: 4.14 x 5.83 to 8.5 x 14 in; Envelope Feeder Accessory: 3.86 x 6.38 to 7 x 10 in |
| Media Size, Tray 1 (metric) | A4; A5; A6; RA4; B5 (JIS); B6 (JIS); 10 x 15 cm; Oficio (216 x 340); 16K; postcards (JIS single and double); envelopes (B5, C5, C6, DL); 76 x 127 to 216 x 356 mm | |
| Media weights supported, by paper path | Metric: Feeder 1: 60 to 200 g/m ² ; Feeder 2: 60 to 120 g/m ² ; Automatic Duplexer: 60 to 120 g/m ² | Imperial: Feeder 1: 16 to 53 lb bond (plain), 16 to 24 lb (envelopes); Feeder 2: 16 to 32 lb bond (plain); Automatic Duplexer: 16 to 32 lb |
| Media Weights Supported, Tray 1 (metric) | 60 to 200 g/m ² | |
| Key media sizes supported | Metric: A4; Envelopes; A5 | Imperial: 4 x 6 in; Letter; Legal; Envelopes; 3 x 5 in |
| Control Panel | 2.7-in (6.86 cm) Non-touch QVGA LCD (color graphics) display with 24-key pad | |
| System Requirements | Minimum - 2 GB available hard disk space, Internet connection, USB port, Internet browser. For additional OS hardware requirements see microsoft.com | |
| Manufacturer Warranty | One-year, onsite warranty. Warranty and support options vary by product, country and local legal requirements. Contact your Contractual Vendor or go to hp.com/support to learn about HP award winning service and support options in your region. (warranty code 4G; warranty ID A001) | |
| Weight Metric | Metric: 26.5 Kg | |
| Package weight | Metric: 39 Kg | |

HP LaserJet Enterprise 6501dn technical specifications

| | | | | |
|-----------------------------------|--|---|----------|--|
| Processor speed | Dual Core (1.4 Ghz) | | | |
| Orderable supplies | HP LaserJet Transfer Roller Kit C35T5A; HP LaserJet Tray Roller Kit C35T6A | | | |
| Printer smart software features | Print preview, duplex printing, print multiple pages per sheet (2, 4, 6, 9, 16), collation, watermarks, store print jobs, easy-access USB | | | |
| Power consumption description | 760 watts (Printing), 7.5 watts (Ready), 0.93 watts (Sleep), 0.05 watts (Auto-Off), 0.05 watts (Off) | | | |
| Power supply | Type | Built-in 3-Pin 115V or 220V Internal Power Supply | Required | Input Voltage: 100V - 127V AC, 50 - 60Hz, 9.7A; or Input Voltage: 220V - 240V AC, 50 - 60Hz, 5.0A |
| What is in the box | HP LaserJet Enterprise PRINTER; HP Original LaserJet Toner Cartridge (~10k page yield); Documentation (Hardware Install Guide, regulatory flyer); Power cord | | | |
| Replacement cartridges | HP 160 Black Original LaserJet Toner Cartridge | | | |
| Supplies feature | HP TerraJet Cartridge | | | |
| Electromagnetic emission standard | CISPR 22:2008 (International) Class A, CISPR 32:2015 (International) Class A / EN 55032:2015 Class A + A11:2020; CISPR 35:2016 (International) / EN 55035:2017 + A11:2020, EN IEC 61000-32:2019 + A11:2020, EN IEC 61000-3-3:2013+A1:2019 + A2:2021, FCC 47 CFR Part 15 Class A, ICES-003, Issue 7 Class A. Other EMC approvals as required by individual countries. | | | |
| Safety approvals and requirements | IEC 62368-1:2014; EN 62368-1:2014 +A11:2017; IEC 62368-1:2018; EN 62368-1:2020 +A11:2020; EN 60825-1:2014 +A11:2021/IEC 60825-1:2014 (Class 1 Laser Product); EN 62479:2010/IEC 62479:2010; Low Voltage Directive 2014/35/EU with CE Mark (Europe); GS Certificate (Germany, Europe); UL/cUL Listed and UC CoC (US/Canada); UL62368-1 3rd Ed. 2021-10-22, CSA C22.2 No. 62368-1-19, 3rd Ed.; Compliance with Laser safety standards 21 CFR 1040.10 and 1040.11 except for deviations pursuant to Laser notice No. 56, Dated May 8, 2019; Other safety approvals as required by individual countries. | | | |
| ENERGY STAR® certified | Yes | | | |
| Ecolabels | CECP; IT ECO Declaration; Blue Angel; EPEAT® Gold India; EPEAT® Gold Australia; EPEAT® Gold Canada; EPEAT® Gold US; SEPA; KOECO; ENERGY STAR® certified; Korea MEPS; Vietnam MEPS | | | |
| Blue Angel compliance | Blue Angel DE-UZ 219—only ensured when using Original HP supplies | | | |
| Sustainable impact specifications | Recyclable through HP Planet Partners; Contains at least 5% post-consumer recycled plastic | | | |
| Network capabilities | Via HP Jetdirect Ethernet embedded print server (standard) which supports: 10Base-T, 100Base Tx, 1000Base-T; 802.3az (EEE) support on Fast Ethernet and Gig Links; IPsec (standard); WiFi 2.4/5 GHz wireless networking (optional); Second Ethernet port (optional). | | | |

HP LaserJet Enterprise 6501dn

technical specifications

| | | | | |
|---|--|---|--------------------------------------|--|
| Supported network protocols | Via built-in networking solution: TCP/IP, IPv4, IPv6; Print: TCP-IP port 9100 Direct Mode, LPD (raw queue support only), Web Services Printing, IPP 2.0, Apple AirPrint™, HP ePrint, FTP Print, Google Cloud Print; Discovery: SLP, Bonjour, Web Services Discovery; IP Config: IPv4 (BootP, DHCP, AutoIP, Manual, TFTP Config, ARP-Ping), IPv6 (Stateless Link-Local and via Router, Statefull via DHCPv6); Management: SNMPv2/v3, HTTP/HTTps, Telnet, TFTP Config, FTP FW Download, Syslog; Security: SNMPv3, SSL Cert Management, Firewall, ACL, 802.1x | | | |
| Mobile printing capability | Apple AirPrint™; Mopria™ certified | | | |
| Package dimensions Metric | Metric | 493 x 565 x 442 mm | Imperial | 19.41 x 22.24 x 17.4 in |
| Max. dimensions Metric | Metric | 400 x 725 x 340 mm (control panel fully upright, rear jam access door open, front cartridge door open, all feeders open and extended) | Imperial | 15.7 x 28.5 x 13.4 in (control panel fully upright, rear jam access door open, front cartridge door open, all feeders open and extended) |
| Product dimensions Metric | Metric | 400 x 400 x 340 mm | Imperial | 15.7 x 15.7 x 13.4 in |
| Display description | 400 x 400 x 340 mm | | | |
| Acoustic power emissions (active, printing) | 6.8 B(A) | | | |
| Acoustic pressure emissions bystander (ready) | 3.2 B(A) | | | |
| Operating humidity range | 10 to 80% RH | | | |
| Operating humidity (recommended) | 30 to 70% RH | | | |
| Operating temperature range | Celsius: 15 to 30°C | | Fahrenheit: 59 to 86°F | |
| | Recommended Celsius: 17.5 to 25°C | | Recommended Fahrenheit: 63.5 to 77°F | |
| Storage Temperature Range | Celsius: 20 to 40°C | | Fahrenheit: 4 to 104°F | |
| Memory | 4 GB | | | |
| Print Resolution Technologies | Normal (600x600 dpi with FastRes), Fine Lines (1200x1200 dpi), Quickview (300x300 dpi) | | | |
| Print speed | A4 | 55 ppm | Letter | 57 ppm |
| First Page Out | Black (A4, ready), 3.9 seconds | | Black (Letter, ready), 3.7 seconds | |
| Monthly duty cycle | A4 | Up to 225,000 pages | Letter | Up to 225,000 pages |
| Recommended Monthly Page Volume | 18,750 | | | |
| Fonts and typefaces | 105 internal TrueType fonts scalable in HP PCL, 92 internal scalable fonts in HP postscript level 3 emulation (Euro symbol built-in); 1 internal Unicode Fonts (Andale Mono WorldType); 2 Internal Windows Vista 8 Fonts (Calibri, Cambria); Additional font solutions available via third-party flash memory cards; HP LaserJet Fonts and IPDS Emulation available at http://www.hp.com/go/laserjetfonts | | | |

HP LaserJet Enterprise 6501dn technical specifications

| | |
|--|---|
| Hard disk | Standard, 32 GB eMMC |
| Print languages, standard | HP PCL 6, HP PostScript level 3 emulation, native PDF printing (v 1.7), Apple AirPrint™ |
| Printer management | HP Printer Assistant, HP Device Toolbox, HP Web JetAdmin Software, HP JetAdvantage Security Manager, HP SNMP Proxy Agent, HP WS Pro Proxy Agent, Printer Administrator Resource Kit for HP Universal Print Driver (Driver Configuration Utility - Driver Deployment Utility - Managed Printing Administrator) |
| Top key features | Two-sided printing; TerraJet cartridge; Front USB flash drive port |
| Target number of users and print volume | For teams over 25 users; Prints up to 18,750 pages/month |
| AIO functions | Print |
| Duplex print options | Automatic (standard) |
| Print technology | Laser |
| Paper Handling Optional/input | Optional: 1 x 550-sheet paper feeder, 1 x 550-sheet feeder with cabinet, 3 x 550-sheet feeder, envelope feeder kit |
| Paper Handling Standard/input | 100-sheet multipurpose feeder, 550-sheet input feeder |
| Paper Handling Standard/output | 500-sheet output feeder |
| Input Capacity, Max | Up to 2850 sheets |
| Product Short Name | 6501dn |
| Typical Electricity Consumption (TEC) number | 0.528 kWh/Week (Blue Angel); 0.621 kWh/Week (ENERGY STAR 3.0) |
| Number of Simultaneous Users (local + network) | 10-30 Users |
| Security management | Identity management: Kerberos authentication; LDAP authentication; 1000 user PIN codes; optional HP and 3rd party advanced authentication solutions (e.g.; badge readers); Network: IPsec/firewall with Certificate; Pre-Shared Key; and Kerberos authentication; Supports WJA-10 IPsec configuration Plug-in; 802.1X authentication (EAP-PEAP; EAP-TLS); SNMPv3; HTTPS; Certificates; Access Control List; Data: Storage Encryption; Encrypted PDF & Email (uses FIPS 140 validated cryptographic libraries from Microsoft); Secure Erase; SSL/TLS (HTTPS); Encrypted Credentials; Device: Security lock slot; USB port disablement; hardware integration pocket for security solutions; Hardware-based Memory Shield™ with Control Flow Integrity (CFI) in-device monitoring for attacks; SureStart Secure Boot - BIOS Integrity Checking with self-healing capability; Whitelisting - loads only known good code (DLLs, EXEs, ...); Security management: Compatible with Device Security Syslog Messages processed and accessible in Arcsight and Splunk SIEMs |
| Mac compatible | Yes |
| Software included | No software solutions are included in the Box, only on http://hp.com ; |
| Media Types | Paper (plain, light, bond, recycled, heavy, extra heavy, cardstock, pre-printed, pre-punched, colored, rough, heavy rough), mono transparency, labels, letterhead, envelope, heavy envelope |



HP LaserJet Enterprise 6501dn

technical specifications

| | | |
|--|---|---|
| Standard Media Sizes | Metric: Tray 1: A4, A5, A6, RA4, B5 (JIS), B6 (JIS), 10 x 15 cm, Oficio (216 x 340), 16K, postcards (JIS single and double), envelopes (B5, C5, C6, DL); Tray 2: A4, A5, A6, RA4, B5 (JIS), B6 (JIS), Oficio (216 x 340), 16K, postcards (JIS double); Optional 550-sheet Tray: A4, A5, A6, RA4, B5 (JIS), B6 (JIS), Oficio (216 x 340), 16K, postcards (JIS double); Optional Automatic Duplexer: A4, RA4, Oficio (216 x 340); Envelope Feeder Accessory: B5, C5, C6, DL | Imperial: Tray 1: Letter, Legal, Executive, Statement, 3 x 5 in, 4 x 6 in, 5 x 7 in, 5 x 8 in, 8.5 x 13 in, Envelopes (No. 9, No. 10, Monarch); Tray 2: Letter, Legal, Executive, Statement, 5 x 7 in, 5 x 8 in, 8.5 x 13 in; Optional 550-Sheet Tray: Letter, Legal, Executive, Statement, 5 x 7 in, 5 x 8 in, 8.5 x 13 in; Optional Automatic Duplexer: Letter, Legal, 8.5 x 13 in; Envelope Feeder Accessory: No. 9, No. 10, Monarch |
| Media sizes custom | Metric: Standard Optional Paper Feeder: A4; A5; A6; RA4; B5 (JIS); B6 (JIS); Oficio (216 x 340); 16K; postcards (JIS double); 105 x 148 to 216 x 356 mm; Envelope Feeder Accessory: Envelopes; 98 x 162 to 178 x 254 mm | Imperial: Tray 1: 3 x 5 to 8.5 x 14 in; Tray 2: 4.14 x 5.83 to 8.5 x 14 in; Optional 550-sheet Tray: 4.14 x 5.83 to 8.5 x 14 in; Envelope Feeder Accessory: 3.86 x 6.38 to 7 x 10 in |
| Media Size, Tray 1 (metric) | A4; A5; A6; RA4; B5 (JIS); B6 (JIS); 10 x 15 cm; Oficio (216 x 340); 16K; postcards (JIS single and double); envelopes (B5, C5, C6, DL); 76 x 127 to 216 x 356 mm | |
| Media weights supported, by paper path | Metric: Feeder 1: 60 to 200 g/m ² ; Feeder 2: 60 to 120 g/m ² ; Automatic Duplexer: 60 to 120 g/m ² | Imperial: Feeder 1: 16 to 53 lb bond (plain), 16 to 24 lb (envelopes); Feeder 2: 16 to 32 lb bond (plain); Automatic Duplexer: 16 to 32 lb |
| Media Weights Supported, Tray 1 (metric) | 60 to 200 g/m ² | |
| Key media sizes supported | Metric: A4; Envelopes; A5 | Imperial: 4 x 6 in; Letter; Legal; Envelopes; 3 x 5 in |
| Control Panel | 4.3" Display (Touch) | |
| System Requirements | Minimum - 2 GB available hard disk space, Internet connection, USB port, Internet browser. For additional OS hardware requirements see microsoft.com | |
| Manufacturer Warranty | One-year, onsite warranty. Warranty and support options vary by product, country and local legal requirements. Contact your Contractual Vendor or go to hp.com/support to learn about HP award winning service and support options in your region. (warranty code 4G; warranty ID A001) | |
| Weight Metric | Metric: 26.5 Kg | |
| Package weight | Metric: 39 Kg | |

6500 Series Accessories

| Accessory Discription | Accessory SKU# |
|--|----------------|
| HP LaserJet 550 sheet Paper Tray | 6C7M6A |
| HP LaserJet 550 Sheet Paper Constellation Yellow Tray | B8GR1A |
| HP LaserJet 550 sheet Paper Cosmic Green Tray | B8GR2A |
| HP LaserJet 550 sheet Paper Aurora Purple Tray | B8GR3A |
| HP LaserJet 550 sheet Paper Comet Red Tray | B8GR4A |
| HP LaserJet 550 sheet Paper Lunar Gray Tray | B8GR5A |
| HP LaserJet 3x550 Sheet Paper Tray with Stand | B01KLA |
| HP LaserJet Lunar Gray 3x550 Sheet Paper Tray with Stand | B01KMA |
| HP LaserJet Comet Red 3x550 Sheet Paper Tray with Stand | B01KNA |
| HP LaserJet Cosmic Green 3x550 Sheet Paper Tray with Stand | B01KPA |
| HP LaserJet Aurora Purple 3x550 Sheet Paper Tray with Stand | B01KQA |
| HP LaserJet Constellation Yellow 3x550 Sheet Paper Tray with Stand | B01KRA |
| HP LaserJet 550 Sheet Paper Tray with Storage Stand | B01KTA |
| HP LaserJet Lunar Gray 550 Sheet Tray with Storage Stand | B01KVA |
| HP LaserJet Comet Red 550 Sheet Tray Strorage Stand | B01KWA |
| HP LaserJet Cosmic Green 550 Sheet Tray with Storage Stnd | B01KXA |
| HP LaserJet Aurora Purple 550 Sheet Tray with Storage Stand | B01KYA |
| HP LaserJet Constellation Yellow 550 Sheet Tray with Storage Stand | B01KZA |
| HP LaserJet Envelope Feeder Kit (if tray 3 is present) | B01KSA |
| HP Accessibility Kit V2 | C0XX4A |
| HP Foreign Interface Harness | B5L31A |
| HP HID Mob Acc Mifare DES Fire Keystroking Reader | 35H11A |
| HP Keystroke Card Reader | Y7C05B |
| HP Internal USB Expansion Kit* | 4XN67A* |
| HP Jetdirect LAN Accessory | 8FP31A |
| HP Legic Secure USB Reader | 4QL32A |
| HP Printing Voice Assistant | 478C2A |
| HP LaserJet 512GB 2.5 inch SATA CCC/FIPS/TAA Solid State Drive* | B18J0A* |
| HP SmartCard NIPRNet Solution for US Government | CC543B |
| HP SmartCard SIPRNet Solution for US Government | F8B30A |
| HP LaserJet 512 GB SED-TAA Solid State Drive | 766R7A* |
| HP JetDirect 3200w Wifi 6 Bluetooth Wireless Accessory | 9R1U0A |
| HP Universal Card Reader | X3D03B |
| HP LaserJet 512GB M.2 2280 NVMe CCC/FIPS/TAA Solid State Drive | B18J1A |

*Available only for 6501dn

Configuration

HP LaserJet Enterprise 6501dn shown



Paper handling accessories

Stand and input devices



| | | | | |
|---------------------|--|---|--|---------------------------------|
| Product number | 6C7M6A | B01KLA | B01KTA | B01KSA |
| Product description | HP LaserJet 550 sheet paper tray | HP LaserJet 3x550 Sheet Paper Tray with Stand | HP LaserJet 550 Sheet Paper Tray with Storage Stand | HP LaserJet Envelope Feeder Kit |
| | Available as optional accessory | | | |
| Stacking | Desktop configuration • 2 trays max Floor standing configuration • varies | Floorstanding configuration Max of 1 additional 1 x 550 sheet paper tray allowed | Floorstanding configuration Max of 2 additional 1 x 550 sheet paper trays allowed | If tray 3 is available |

Disclaimers

1. Measured using ISO/IEC 24734, excludes first set of test documents. For more information, see <http://www.hp.com/go/printerclaims>. Exact speed varies depending on the system configuration, software application, driver, and document complexity.
2. Some features enabled by future HP FutureSmart firmware upgrades may not be available on older devices, if for example, physical product characteristics limit the functionality of the new feature.
3. HP's most advanced embedded security features are available on HP Managed and Enterprise devices with HP FutureSmart firmware 4.5 or above. Claim based on HP review of published features as of June 2025 of competitive in-class printers. Only HP offers a combination of security features to automatically detect, isolate, stop, and recover from attacks with a self-healing reboot, in alignment with NIST SP 800-193 guidelines for device cyber resiliency. Printers are most vulnerable to attack when they are booting up and during runtime (when the printer is in sleep mode and in use). Only HP Enterprise printers protect the device during 100% of the printer's life with Sure Start BIOS protection, Memory Shield with hardware-based Runtime Intrusion Detection and Control Flow Integrity to detect and recover from zero-day threats in addition to Connection Inspector network behavioral anomaly detection all with self-healing recovery. For a list of compatible products, visit hp.com/go/PrintersThatProtect. For more information, visit hp.com/go/PrinterSecurityClaims.
4. HP voluntarily designs and tests its printing systems to prevent emissions that exceed Blue Angel and EPEAT eco-label guidelines. Based on US, Canada, India, and Australia EPEAT® registration according to IEEE 1680.1-2018 EPEAT®. EPEAT® status varies by country. Visit www.energystar.gov/productfinder for more information on models of the HP LaserJet Enterprise 5500/6500/MFP 5600/MFP 6600 series that are ENERGY STAR certified in North America. ENERGY STAR and the ENERGY STAR logo are registered U.S. marks. HP printer, HP paper and Original HP supply - Blue Angel DE-UZ 219 Emissions Criteria.
5. Recycled plastic is expressed as a percentage of total weight of plastic. See www.hp.com/tonerrecycledcontent for more information.
6. Program availability varies. For more information, visit hp.com/hprecycle.
7. HP Security Manager must be purchased separately. For details, see hp.com/go/securitymanager.
8. Delivered through implementation of HP Authentication Suite for Workpath-enabled devices and devices with embedded Protected Access both providing passwordless multifactor authentication for Microsoft Entra ID environments. Device identity provided by deployment of device certificates using HP Security Manager software, sold separately.
9. Based on HP's internal analysis of business Printers with preinstalled encryption, authentication, malware protection, postquantum digital signature, and initial BIOS firmware integrity protection with automatic self-healing recovery finding that no other in-class Printers implement a quantum-resistant cryptographic scheme to protect the integrity of the BIOS and firmware as of March 2025.
10. HP calculations based on normalized Energy Star® TEC data of HP LaserJet Enterprise 5501-5502, 5601-5602, 6500-6501 and 6600 with HP TerraJet Cartridges compared to HP LaserJet Enterprise M507, M528, M610 and HP M634. See [hp.com/ TerraJet/energysaving](http://hp.com/TerraJet/energysaving).
11. Toner efficiency of Original HP 159 and 160 TerraJet Toner Cartridges compared to HP Original 89 and 147 Toner Cartridges. Calculated in 2026 using pages printed per gram of toner. See hp.com/TerraJet/tonersaving for more information.
12. HP office-class printing systems are select Enterprise and Managed devices with FutureSmart firmware 4.5 and up, Pro devices, LaserJet models 200 and up, with respective Original HP Toner, PageWide and Ink Cartridges. Does not include HP integrated printhead cartridges. Digital supply-chain tracking, hardware, chips and packaging security features vary locally by SKU. See hp.com/cartridgesecurity.
13. See ISO/IEC 20243:2018 Open Trusted Technology Provider™ Standard Certification Register. See certification.opengroup.org/register/ottps-certification.
14. Virgin plastic reduction in Original HP 159 and 160 TerraJet Toner Cartridges compared to predecessor Original HP 89 and 147 Toner Cartridges Toner Cartridges is based on comparing grams of virgin plastic and is expressed as a percentage of total weight of plastic. Accurate as of 2026 for the products listed only.
15. Reduction of plastic packaging in Original HP 159 and 160 TerraJet Toner Cartridges compared to predecessor Original HP 89 and 147 Toner Cartridges is based on comparing grams of plastic packaging mass. Accurate as of 2026 for the products listed only.

16. Speed of HP LaserJet Enterprise 5501-5502 and 5601-5602 compared to HP LaserJet Enterprise M507 and M528 and of HP LaserJet Enterprise 6500-6501 and 6600 compared to HP LaserJet Enterprise M610 and M634. Measured in 2026 using ISO/IEC 24734, excludes first set of test documents. Exact speed varies depending on the system configuration, software application, driver, and document complexity.

