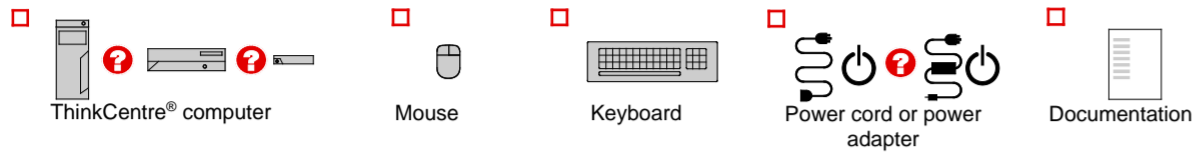

ThinkCentre.**Safety, Warranty, and Setup Guide**Brief user notices
ThinkCentre M83<http://www.lenovo.com/support>

Lenovo® electronic manuals... for a greener planet!

Refer to the electronic *User Guide* for detailed product information:
<http://www.lenovo.com/UserManuals>**lenovo.** FOR
THOSE
WHO DO.**Unpack**

Note: Recovery discs are not provided. Instead, everything needed for recovering factory-installed files and applications is provided in the Lenovo_Recovery partition on your hard disk drive. If you decide to remove the Lenovo_Recovery partition, be sure to create a recovery disc first. For more information, see "Recovery information" in the *User Guide*. See "Accessing your *User Guide*" for instructions on opening the electronic *User Guide* provided on your computer.

Connector locations**Notes:**

- The locations of the connectors, controls, and indicators on your computer might be slightly different from the illustrations.
- For tiny desktop:** If you use the optional port for installing a serial port, the serial port and the adjacent VGA connector might interfere with each other when you connect cables. To avoid the interference, ensure that you use the serial port convert cable that comes with the computer when you connect a device to the serial port.
- For tiny desktop:** The Video Electronics Standards Association (VESA®) mount bracket and the vertical stand are optional parts. If your computer comes with the VESA mount bracket installed, ensure that you remove the VESA mount bracket before you install the vertical stand. For more information, see "Installing or replacing hardware" in the *User Guide*.

Tower and small desktop, rear view

- Power cord connector
- Serial connector (Serial connector 1)
- VGA connector
- DisplayPort® connectors (2)
- USB 3.0 connectors (USB connectors 5 and 6)
- USB 2.0 connectors (USB connectors 7 and 8)
- USB 2.0 connectors (USB connectors 3 and 4)
- Microphone connector
- Audio line-out connector
- Audio line-in connector
- PCI Express x16 graphics card slot
- PCI Express x1 card slot
- PCI Express card slot (physical link width x16; negotiable link width x4, x1)
- Optional serial connector (Serial connector 2)
- Ethernet connector
- PS/2 keyboard and mouse connectors (optional)
- Security-lock slot

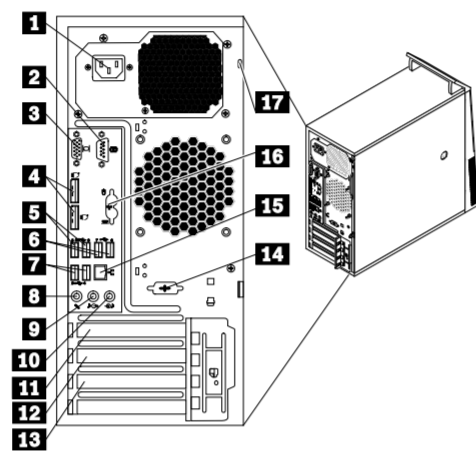
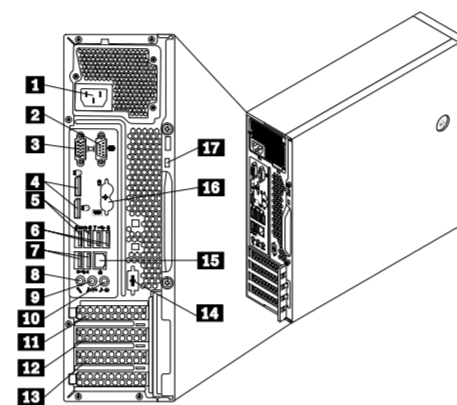
Tower**Small desktop****Tiny desktop, rear view**

- Wi-Fi antenna slot
- ac power adapter cable loop
- Optional connector
- Security-lock slot
- ac power adapter connector
- DisplayPort connector
- USB 3.0 connector (USB connector 4)
- USB 3.0 connector (USB connector 3)
- VGA connector
- Ethernet connector
- USB 3.0 connector (USB connector 5)

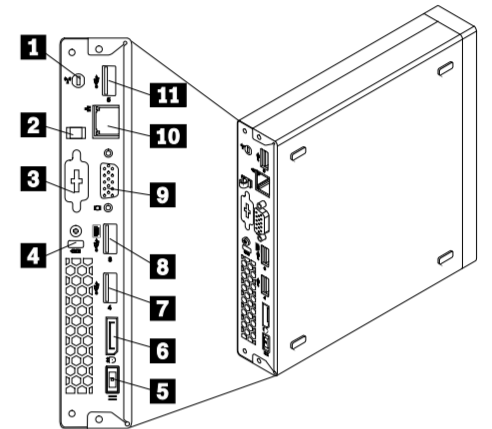
Tiny desktop**Initial setup instructions**

Note: Depending on the model type, your computer might not have all of the connectors that are described in this section.

- Connect the keyboard cable to an appropriate keyboard connector.

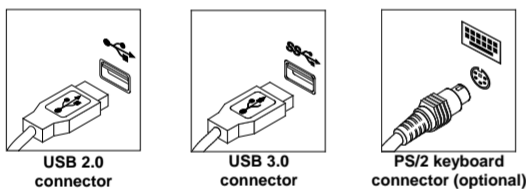

- Connect the mouse cable to an appropriate mouse connector.

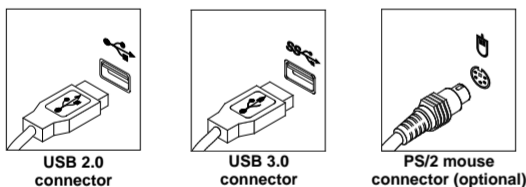

- Connect the display cable to an appropriate video connector.

Note: If your computer is installed with a graphics card, ensure that you use the monitor connectors on the graphics card.

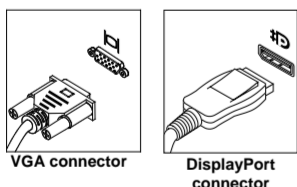

- If you have audio devices, attach them using the following instructions.

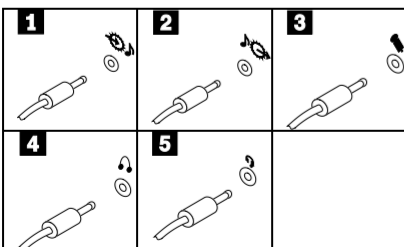

- Audio line-in connector: Used to receive audio signals from an

external audio device, such as a stereo system.

- Audio line-out connector:** Used to send audio signals from the computer to external devices, such as powered stereo speakers.
 - Microphone connector:** Used to attach a microphone to your computer to record sound or use speech-recognition software.
 - Headphone connector:** Used to attach headphones to your computer to listen to music or other sounds without disturbing anyone.
 - Headset connector:** Used to attach a supported headset to your computer to record sound, use speech-recognition software, listen to music, or other sounds without disturbing anyone. The headset connector is also known as audio jack.
- If you have powered speakers with an ac power adapter, do the following:
 - Connect the cable that runs between the speakers, if necessary. On some speakers, this cable is permanently attached.
 - Connect the ac power adapter cable to the speakers.
 - Connect the speakers to the audio line-out connector or the headphone connector on the computer.
 - Connect the ac power adapter to an ac power source.
 - If you have unpowered speakers with no ac power adapter, do the following:
 - Connect the cable that runs between the speakers, if necessary. On some speakers, this cable is permanently attached.
 - Connect the speakers to the audio line-out connector or the headphone connector on the computer.

- If you have any additional devices, connect them to the appropriate connectors. Your computer might not have all connectors that are shown.

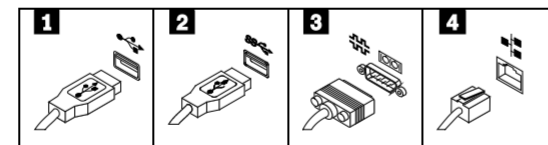

- USB 2.0 connector:** Used to attach a device that requires a USB 2.0 connector, such as a keyboard, a mouse, a scanner, a printer, or a personal digital assistant (PDA).
- USB 3.0 connector:** Used to attach a device that requires a USB 2.0 or 3.0 connector, such as a keyboard, a mouse, a scanner, a printer, or a personal digital assistant (PDA). A USB 3.0 connector provides high transmission speeds to reduce the time that is required for data transmission.
- Serial connector:** Used to attach an external modem, a serial printer, or other devices that use a 9-pin serial connector.
- Ethernet connector:** Used to attach the computer to an Ethernet-type local area network or to a cable modem. Important: To operate the computer within FCC limits when it is connected to an Ethernet network, use a Category 5 Ethernet

cable.

- Connect the power cord or the power adapter to the computer first and then to a properly-grounded electrical outlet. Ensure that all power cord connectors are securely and completely plugged into receptacles.

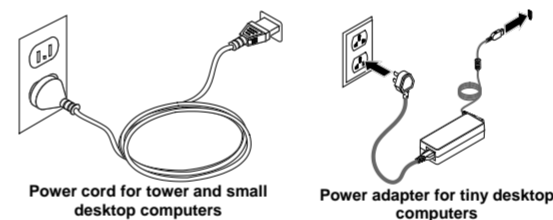

- Press the power button on the front of the computer.

- Follow the on-screen instructions to complete the setup.

Note: If your tiny desktop computer comes with an external optical drive, an external hard disk drive, an external battery, or an I/O box, ensure that you install the cable that connects your computer and the external device. If your computer comes with the Wi-Fi feature, ensure that you install the Wi-Fi antenna stick to your computer.

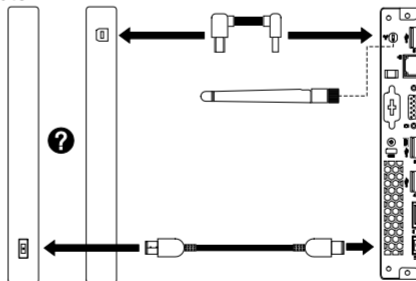
**Accessing your user guide**

Your *User Guide* contains detailed information about your computer. To access your *User Guide*, do the following:

Microsoft® Windows® 8.1:

- Method 1**
 - Go to the Start screen.
 - Click the arrow icon in the bottom-left corner of the screen to go to the Apps screen. If you are using a touch screen, swipe up to go to the Apps screen.
 - Scroll to the right side of the screen, and click or tap **Help and Support**. The Windows Help and Support window opens.
 - Click or tap **Lenovo User Guide**.

Method 2

- Go to the Start screen.
- Click or tap **Lenovo Support**. The Lenovo Support window opens.
- Click or tap **User Guide**.

Microsoft Windows 8:

- From the desktop or the Start screen**
 - Move the pointer to the top-right or bottom-right corner of the screen to display the charms, and then click **Search**. If you are using a touch screen, swipe in from the right edge of the screen to display the charms, and then tap **Search**.
 - On the Apps screen, scroll to the right side, and click or tap **Help and Support**. The Windows Help and Support window opens.
 - Click or tap **Lenovo User Guide**.

From the Start screen

- Click or tap **Lenovo Support**. The Lenovo Support window opens.
- Click or tap **User Guide**.

Microsoft Windows 7:

- From the Windows desktop, click **Start** and then click **Help and Support**. The Help and Support application opens.
- Click **Lenovo User Guide**.
- In the Lenovo User Guide window, click the link for your model and the *User Guide* opens.

Models without preinstalled operating systems and Virtual Desktop Infrastructure (VDI) clients:
Go to the Lenovo Support Web site to access your *User Guide*. See "Downloading publications" for additional information.

User Guides are available in additional languages from the Lenovo Web site. See "Downloading publications" for additional information.

Read this flyer before using your computer

This flyer provides critical safety and regulatory information for Lenovo computers and instructions on how to access electronic versions of the publications developed for your computer.

Read first — regulatory information

Reduce | Reuse | Recycle



Computer models equipped with wireless communications comply with the radio frequency and safety standards of any country or region in which it has been approved for wireless use.

Be sure to read the Regulatory Notice for your country or region before using the wireless devices contained in your computer. To obtain a PDF version of the Regulatory Notice, refer to the "Downloading publications" section below.

Brazil regulatory notice

Ouvir sons com mais de 85 decibéis por longos períodos pode provocar danos ao sistema auditivo.

Mexico regulatory notice

Advertencia: En México la operación de este equipo está sujeta a las siguientes dos condiciones: (1) es posible que este equipo o dispositivo no cause interferencia perjudicial y (2) este equipo o dispositivo debe aceptar cualquier interferencia, incluyendo la que pueda causar su operación no deseada.

Downloading publications

Electronic versions of your computer publications are available from the Lenovo Support Web site. To download the publications for your computer, go to <http://www.lenovo.com/UserManuals> and follow the instructions on the screen.

Third Edition (October 2014)

© Copyright Lenovo 2013, 2014.

LIMITED AND RESTRICTED RIGHTS NOTICE: If data or software is delivered pursuant a General Services Administration "GSA" contract, use, reproduction, or disclosure is subject to restrictions set forth in Contract No. GS-35F-05925.

Service and Support information

The following information describes the technical support that is available for your product, during the warranty period or throughout the life of your product. Refer to the Lenovo Limited Warranty for a full explanation of Lenovo warranty terms. See "Lenovo Limited Warranty notice" later in this document for details on accessing the full warranty.

If you purchased Lenovo services, refer to the following terms and conditions for detailed information:

- For **Lenovo Warranty Service Upgrades or Extensions**, go to:

- http://support.lenovo.com/wsu
- For **Lenovo Accidental Damage Protection Services**, go to: <http://support.lenovo.com/ladps>

Online technical support

Online technical support is available during the lifetime of a product at: <http://www.lenovo.com/support>

Telephone technical support

Where applicable, you can get help and information from the Customer Support Center by telephone. Before contacting a Lenovo technical support representative, please have the following information available: model and serial number, the exact wording of any error message, and a description of the problem. Your technical support representative might want to walk you through the problem while you are at your computer during the call.

Worldwide Lenovo support telephone list

Important: Telephone numbers are subject to change without notice. The most up-to-date telephone list for the Customer Support Center is always available at: <http://www.lenovo.com/support/phone>

If the telephone number for your country or region is not listed, contact your Lenovo reseller or Lenovo marketing representative.

Country or region	Telephone number
Africa	South Africa: 0800110756 (English, Afrikaans) Central Africa: Contact the nearest Lenovo Business Partner
Algeria	+33 6 7348 1739 (French, English)
Argentina	0800-666-0011 (Spanish)
Australia	1800 041 267 (English)
Austria	01 24592 5901 (German)
Bahrain	Kanoo IT: 00 973 1771 1722 Bahrain Business Machine LLC: 00 973 1758 4302
Belgium	02-210-9820 +32 (0)2 339 3611 (Warranty service and support) (Dutch) 02-210-9800 (French)
Bolivia	0800-10-0189 (Spanish)
Brazil	Calls made from within the Sao Paulo region: (11) 3889-8986 Calls made from outside the Sao Paulo region: 0800-701-4815 (Brazilian Portuguese)
Brunei	Dial 800-1111, and then dial 866-273-5446 (English, Bahasa Melayu)
Canada	+1-800-565-3344 (English, French)
Caribbean (Bermuda, Jamaica, Tortola)	1-800 426 7378 (English)
Chile	800-361-213 (Spanish)
China	Technical Support Line: 400-100-6000 (Mandarin) 1-800-912-3021 (Spanish)
Colombia	1-800-011-1029 (Spanish)
Croatia	0800-0426
Cyprus	80029537 (Greek)
Czech Republic	+420-2-7213-1316
Denmark	4520-8200 7010-5150 (Warranty service and support) (Danish)
Dominican Republic	+1-800-434-2080 (Spanish)
Ecuador	1-800-426911 OPCION 4 (Spanish)
Egypt	800-0000-418 (Toll free) 002-02-2594-8500 (Standard charges apply) (English, Arabic)
El Salvador	800-6264 (Spanish)
Estonia	+372 66 00 800 +372 6776793
Finland	09-459-6960 +358-800-1-4260 (Warranty service and support) (Finnish)
France	0238-657-450 Hardware: 0810-631-213 (Warranty service and support) Software: 0810-631-020 (Warranty service and support) (French)
Germany	01805-00 46 18 (Warranty service and support)
Greece	Contact the nearest Lenovo Business Partner
Guatemala	1800-524-0051 (Spanish)
Honduras	Tegucigalpa: 232-4222 San Pedro Sula: 552-2234 (Spanish)
Hong Kong	(852) 3071-3661 (Cantonese, English, Mandarin)
Hungary	+36 1 3825716 +36 1 3825720 (English, Hungarian)
India	1800 3000 THINK, 1800 3070 8465 (Reliance) 1800-419-4666 (Toll Free) Email: Commercialts@lenovo.com (English, Hindi)
Indonesia	+6221 2992 5823 001-803-606-282 (Local number only) +603 8315 6859 (DID) (English, Bahasa Indonesia)
Ireland	01-815-9202 01-881-1444 (Warranty service and support) (English)
Israel	Givat Shmuel Service Center: +972-3-531-3900
Italy	02-7031-6101 +39-800-820094 (Warranty service and support) (Italian)
Japan	0120-000-817
Jordan	Jordan Business Systems: 00 962 6 5000999 Ext 713/127 General Computer & Electronic (GCE): 00 962 6 551 3879
Kazakhstan	+77273231427 (Standard charges apply) (Russian, English)
Korea	080-513-0880 (Toll Free) 0234834817 (Standard charges apply) (Korean)
Kuwait	Easa Hussain Al Youssi: 00 965 2244 5280 AM, KHORAFI: 00 965 2200 1100 1127 Khorafi Business Machines (KBM): 00 965 2259 4611 Diyar United Company: 00 965 4378 383 Redington Kuwait: 00 965 2433 3203; 25456250 / 25456251
Latvia	+371 70703621
Lebanon	Quantech: 00 961 1999 500 Computer Business Machine (CBM): 00 961 1680 180 El Hacee S.A.L.: 00 961 1771 300
Lithuania	+370 5 278 66 00
Libya	+33 6 7348 1739 (French, English)
Luxembourg	+352 360 385 222 (French)
Macao	0800-807 / (852) 3071-3559 (Cantonese, English, Mandarin)
Macedonia	+389 23090625 (Macedonia)
Malaysia	1800-88-0013 (English, Bahasa Melayu)
Mexico	+36621445566
Mexico	001-866-434-2080 (Spanish)
Middle East	+44 (0)1475-555-055
Morocco	+212 5 22 509035 +212 5 22 509017
Netherlands	+31 (0)20 513 3839 (Dutch)
New Zealand	0508 770 508 (English)
Nicaragua	001-800-220-1830 (Spanish)
Norway	6681-1100 8152-1550 (Warranty service and support) (Norwegian)
Oman	Khimi Ramdas Computer Communication Systems: 00 968 2469 6255 Overseas Business Machines (OBM): 00 968 2460 1072; 2460 5018 Gulf Business Machines Services (GBMS): 00 968 2455 9831
Pakistan	INFO TECH (pvt) Ltd.: 00 924 2111 427 427 International Office Products (pvt) Ltd.: 00 92 212 422 869; 00 92 213 241 2023 Selling Business Systems: 00 92 21 568 9823
Panama	206-6047

Country or region	Telephone number
Paraguay	001-865-434-2080 (Lenovo Customer Support Center- toll free) (Spanish)
Peru	009-800-52-10026 (Spanish)
Peru	0-800-50-866 OPCION 2 (Spanish)
Philippines	18008986454 (Domestic Toll Free) 18004410719 (International Toll Free) (Tagalog, English)
Poland	+48 22 760 7300 (Polish)
Portugal	+351 21 892 7046 (Portuguese)
Qatar	Al Mana Computer Services: 00 974 4489 966 (ext. 1992) Qatar Computer Services W.L.L.: 00 974 4441 212 Gulf Business Machines: 00-974 462 1395
Romania	+4-021-224-4015
Russia	8-800-555-0317 (Toll free number) (Russian)
Saudi Arabia	800 85 000 52 (Standard charges apply) (English, Arabic)
Singapore	800 6011 343 (Local number only) +603 8315 6856 (DID) (English)
Slovakia	+421 2 4974 8888
Slovenia	+386-1-200-50-60 (Slovenian)
Spain	0901-100-000 (Spanish)
Sri Lanka	+9411 2493547 02493548 (English)
Sweden	08-477-4420 077-117-1040 (Warranty service and support) (Swedish)
Switzerland	069-333-9900 0800-55-54-54 (Warranty service and support) (German, French, Italian)
Taiwan	0800-000-702 (Mandarin)
Thailand	001 800 4416 734 (Thai, English)
Turkey	0212 336 03 66 08000 448 825 165 (Turkish)
Ukraine	044 362 42 81 (Ukrainian, Russian, English)
United Arab Emirates	800035702810 (Standard charges apply) (English, Arabic)
United Kingdom	01475-897-163 08705-500-900 (Standard warranty support) (English)
United States	1-800-426-7378 (Select "Option #1") (English)
Uruguay	000-411-005-6649 (Spanish)
Venezuela	0-800-100-2011 (Spanish)
Vietnam	120-11072 (Toll Free) (84) 8 3521 8000 (Standard charges apply) (Vietnamese, English)
Yemen	Al Khirbash and Agencies: 00 967 1209 8278 Yemen Business Machines (YBM): 00-967 3 213324 00-967 3 214655 00-967 3 213909

Lenovo product service information for Taiwan

台灣 Lenovo 產品服務資訊如下:
荷蘭商聯想股份有限公司台灣分公司
台北市內湖區堤頂大道二段89號5樓
服務電話: 0800-000-702

Safety information



This section contains important safety information for Lenovo products. Additional safety information is provided in the *User Guide* for your product. See "Accessing your *User Guide*" for additional information.

Laser compliance statement

CAUTION:

When laser products (such as CD-ROMs, DVD drives, fiber optic devices, or transmitters) are installed, note the following:

- Do not remove the covers. Removing the covers of the laser product could result in exposure to hazardous laser radiation. There are no serviceable parts inside the device.
- Use of controls or adjustments or performance of procedures other than those specified herein might result in hazardous radiation exposure.

DANGER
Some laser products contain an embedded Class 3A or Class 3B laser diode. Note the following:
Laser radiation when open. Do not stare into the beam, do not view directly with optical instruments, and avoid direct exposure to the beam.

Plastic bag notice

DANGER
Plastic bags can be dangerous. Keep plastic bags away from babies and children to avoid danger of suffocation.

Lithium coin cell battery notice

DANGER
Danger of explosion if battery is incorrectly replaced.

When replacing the lithium coin cell battery, use only the same type or equivalent type that is recommended by the manufacturer. The battery contains lithium and can explode if not properly used, handled, or disposed of.

Do not:

- Throw or immerse into water
- Heat to more than 100°C (212°F)
- Repair or disassemble

Dispose of the battery as required by local ordinances or regulations.

The following statement applies to users in the state of California, U.S.A.

California Perchlorate Information:

Products containing manganese dioxide lithium coin cell batteries may contain perchlorate.

Perchlorate Material - special handling may apply, See www.dtsc.ca.gov/hazardouswaste/perchlorate

Polyvinyl Chloride (PVC) cable and cord notice

Warning: Handling the cord on this product or cords associated with accessories sold with this product will expose you to lead, a chemical known to the State of California to cause cancer, and birth defects or other reproductive harm. Wash hands after handling.

Using headphones or earphones

If your computer has both a headphone connector and an audio line-out connector, always use the headphone connector for headphones (also called a headset) or earphones.

CAUTION:

Excessive sound pressure from earphones and headphones can cause hearing loss. Adjustment of the equalizer to maximum increases the earphone and headphone output voltage and the sound pressure level. Therefore, to protect your hearing, adjust the equalizer to an appropriate level.

Excessive use of headphones or earphones for a long period of time at high volume can be dangerous if the output of the headphone or earphone connectors do not comply with specifications of EN 50332-2. The headphone output connector of your

computer complies with EN 50332-2 Sub clause 7. This specification limits the computer's maximum wide band true RMS output voltage to 150 mV. To help protect against hearing loss, ensure that the headphones or earphones you use also comply with EN 50332-2 (Clause 7 Limits) or a wide band characteristic voltage of 75 mV. Using headphones that do not comply with EN 50332-2 can be dangerous due to excessive sound pressure levels.

If your Lenovo computer came with headphones or earphones in the package, as a set, the combination of the headphones or earphones and the computer already complies with the specifications of EN 50332-1. If different headphones or earphones are used, ensure that they comply with EN 50332-1 (Clause 6.5 Limitation Values). Using headphones that do not comply with EN 50332-1 can be dangerous due to excessive sound pressure levels.

Lenovo Limited Warranty notice

This product is covered by the terms of the Lenovo Limited Warranty, version L505-0010-02 08/2011. Read the Lenovo Limited Warranty (LLW) at http://www.lenovo.com/warranty/llw_02. You can view the LLW in a number of languages from this Web site. The LLW also is displayed on your computer during the initial setup. After the initial setup has completed, you can view the warranty on your computer by doing the following:

Windows 8.1:

- Method 1**
 - Go to the Start screen.
 - Click the arrow icon in the bottom-left corner of the screen to go to the Apps screen. If you are using a touch screen, swipe up to go to the Apps screen.
 - Click or tap **Warranty Information**.
- Method 2**
 - Go to the Start screen.
 - Click or tap **Lenovo Support**. The Lenovo Support window opens.
 - Click or tap **Service and Warranty**.

Windows 8:

- From the desktop or the Start screen**
 - Move the pointer to the top-right or bottom-right corner of the screen to display the charms, and then click **Search**. If you are using a touch screen, swipe in from the right edge of the screen to display the charms, and then tap **Search**.
 - From the Apps screen, click or tap **Warranty Information**.
- From the Start screen**
 - Click or tap **Lenovo Support**. The Lenovo Support window opens.
 - Click or tap **Service & Warranty**.

Windows 7:

From the Windows desktop, click **Start** → **All Programs** → **Lenovo Device Experience** → **Lenovo Warranty**.

If you cannot view the LLW either from the Web site or from your computer, contact your local Lenovo office or reseller to obtain a printed version of the LLW.

Warranty information

To check the warranty status of your computer, go to <http://www.lenovo.com/warranty-status>, and then follow the instructions on the screen.

Customer Replaceable Units

Customer Replaceable Units (CRUs) are parts that can be upgraded or replaced by the customer. If a CRU is determined to be defective during the warranty period, a replacement CRU will be provided to the customer. Customers are responsible for installing the self-service CRUs for this product. Customers also can install optional-service CRUs, which might require some technical skills or tools, or request that a technician install the optional-service CRU under the terms of the applicable warranty service type for your country or region. The following tables list CRUs for your computer and tell where to find the replacement instructions.

Machine types 10AG, 10AK, 10AL, and 10BE.

Self-service CRUs	Optional-service CRUs
<ul style="list-style-type: none"> Coin cell battery Cover presence switch (intrusion switch) Hard disk drive Internal speaker Keyboard Memory module Mouse Optical drive Peripheral Component Interconnect (PCI) card* Rear Wi-Fi antenna* 	<ul style="list-style-type: none"> Front audio and USB assembly Front USB assembly* Front Wi-Fi antenna* Heat sink and fan assembly Microprocessor mSATA solid state drive* mSATA solid state drive converter* Power supply assembly Rear fan assembly Thermal sensor* Wi-Fi adapter card* Wi-Fi card module*

Machine types 10AH, 10AJ, 10AM, and 10AN.

Self-service CRUs	Optional-service CRUs
<ul style="list-style-type: none"> Coin cell battery Cover presence switch (intrusion switch) Hard disk drive Keyboard Memory module Mouse mSATA solid state drive* Optical drive PCI card* Secondary hard disk drive* 	<ul style="list-style-type: none"> Card reader* Front audio and USB assembly Front fan assembly Front USB assembly* Front Wi-Fi antenna* Heat sink and fan assembly Internal speaker Microprocessor mSATA solid state drive converter* Power supply assembly Rear Wi-Fi antenna* Thermal sensor* Wi-Fi adapter card* Wi-Fi card module*

Machine types 10E8, 10E9, 10EA, and 10EB.

Self-service CRUs	Optional-service CRUs
<ul style="list-style-type: none"> ac power adapter Coin cell battery Front Wi-Fi antenna* Keyboard Memory module Mouse Power adapter bracket* Power cord Vertical stand* Rear Wi-Fi antenna* 	<ul style="list-style-type: none"> External hard disk drive* External I/O box External optical drive* Thermal module Internal speaker Microprocessor Power switch board System fan VESA mount bracket* Wi-Fi card module*

Note: * denotes optional parts, which are available in some models.

CRU installation instructions are in the *User Guide* for the respective product. See "Accessing your *User Guide*" for additional information.

Electronic emission notices

This device has been tested and found to comply with the limits for a Class B digital device. The *User Guide* for this product provides the complete Class B compliance statements that are applicable for this device. See "Accessing your *User Guide*" for additional information.

Korean Class B compliance statement

본급 기기(가정용 방송통신기자재)
이 기기는 가정용(본급) 전자파해방기로서 주로 가정에서 사용하는 것을 목적으로 하며, 모든 지역에서 사용할 수 있습니다

European Union conformity



Radio and Telecommunications Terminal Equipment Directive

This product is in compliance with the essential requirements and other relevant provisions of the Radio and Telecommunications Terminal Equipment Directive, 1999/5/EC. The Declaration of Conformity information is located in the *Regulatory Notice*, which you can download from the Lenovo Support Web site. See "Downloading publications" for additional information.

Recycling and environmental information

Lenovo encourages owners of information technology (IT) equipment to responsibly recycle their equipment when it is no longer needed. Lenovo offers a variety of programs and services to assist equipment owners in recycling their IT products. For information on recycling Lenovo products, go to: <http://www.lenovo.com/recycling>

Important WEEE information



Recycling information for Japan

Recycling and disposal information for Japan is available at: <http://www.lenovo.com/recycling/japan>

Recycling information for China

《废弃电器电子产品回收处理管理条例》提示性说明

联想鼓励拥有联想品牌产品的用户当不再需要此类产品时，遵守国家废弃电器电子产品回收处理相关法律法规，将其交给当地具有国家认可的回收处理资质的厂商进行回收处理。更多回收服务信息，请点击进入 <http://support.lenovo.com/act/iv13y/551.htm>。

Additional recycling statements

Additional information about recycling computer components and batteries is in your *User Guide*. See "Accessing your *User Guide*" for details.

Restriction of Hazardous Substances Directive (RoHS)

European Union RoHS

Lenovo products sold in the European Union, on or after 3 January 2013 meet the requirements of Directive 2011/65/EU on the restriction of the use of certain hazardous substances in electrical and electronic equipment ("RoHS recast" or "RoHS 2").

For more information about Lenovo progress on RoHS, go to: http://www.lenovo.com/social_responsibility/us/en/RoHS_Communication.pdf

China RoHS

The information in the following table is applicable for products manufactured on or after March 1, 2007 for sale in the People's Republic of China.

产品中有害物质或元素名称及含量																																				
<table border="1"> <thead> <tr> <th>有害物质或元素</th> <th>六价铬 (Cr(VI))</th> <th>多溴联苯 (PBB)</th> <th>多溴二苯醚 (PBDE)</th> </tr> </thead> <tbody> <tr> <td>印刷电路板组件*</td> <td>X</td> <td>0</td> <td>0</td> </tr> <tr> <td>硬盘</td> <td>X</td> <td>0</td> <td>0</td> </tr> <tr> <td>光驱</td> <td>X</td> <td>0</td> <td>0</td> </tr> <tr> <td>内存</td> <td>X</td> <td>0</td> <td>0</td> </tr> <tr> <td>电源/IO 附件</td> <td>X</td> <td>0</td> <td>0</td> </tr> <tr> <td>鼠标</td> <td>X</td> <td>0</td> <td>0</td> </tr> <tr> <td>显示器</td> <td>X</td> <td>0</td> <td>0</td> </tr> <tr> <td>机箱/附件</td> <td>X</td> <td>0</td> <td>0</td> </tr> </tbody> </table>	有害物质或元素	六价铬 (Cr(VI))	多溴联苯 (PBB)	多溴二苯醚 (PBDE)	印刷电路板组件*	X	0	0	硬盘	X	0	0	光驱	X	0	0	内存	X	0	0	电源/IO 附件	X	0	0	鼠标	X	0	0	显示器	X	0	0	机箱/附件	X	0	0
有害物质或元素	六价铬 (Cr(VI))	多溴联苯 (PBB)	多溴二苯醚 (PBDE)																																	
印刷电路板组件*	X	0	0																																	
硬盘	X	0	0																																	
光驱	X	0	0																																	
内存	X	0	0																																	
电源/IO 附件	X	0	0																																	
鼠标	X	0	0																																	
显示器	X	0	0																																	
机箱/附件	X	0	0																																	

0:表示该有害物质在该部件所有均质材料中的含量均在SJ/T11363-2006标准规定的限量要求以下
X:表示该有害物质在该部件的某一均质材料中的含量超出SJ/T11363-2006标准规定的限量要求

表中标有“X”的所有部件都符合欧盟RoHS法规

印刷电路板组件*: 包括印刷电路板及其零部件、电容和连接器
根据型号的不同, 可能不会含有以上的所有部件, 请以实际购买机型为准

在中华人民共和国境内销售的电子信息产品必须标识此标志, 标志内的数字代表在正常使用状态下的产品的环保使用期限

