

CART

Vertical Lift 22" (559 mm)

MONITOR

Lift 5" (127 mm)
 Extension 4" (102 mm)
 Tilt 65°
 Pan 180°
 P/L Rotation 360°
 (can be locked at 0°)

KEYBOARD

Extension 7.5" (191 mm)
 Tilt 10°
 Pan 170°
 Tray slides side-to-side
 for right / left mousing
 Tray removes for cleaning

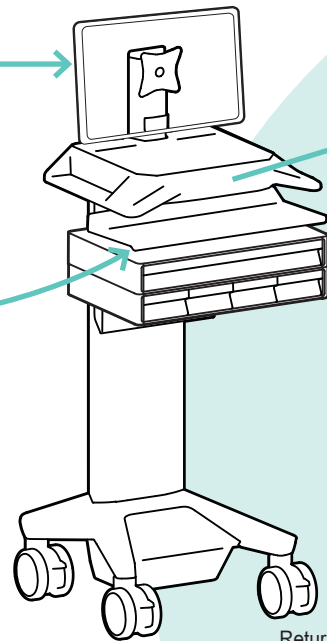

TOUCH SCREEN CONTROL PANEL

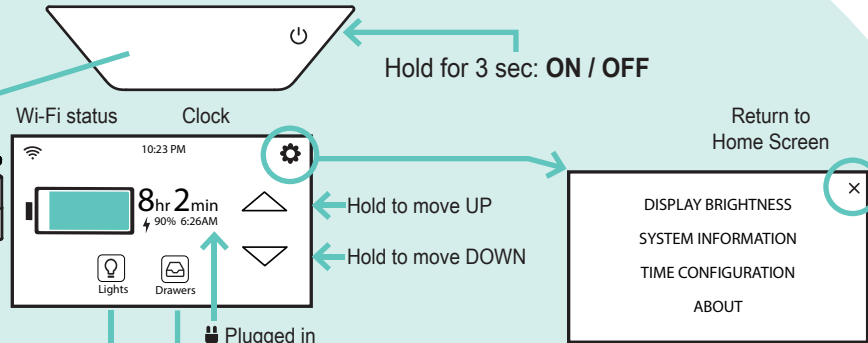

Plugged in
 Unplugged / Discharging
 Plugged in / Charging
 Time remaining on battery.
 Percent of battery charge and the time the battery will be fully discharged.

Note: Carts do not charge when turned off. To Charge cart, plug in and cart will turn itself on and charge.

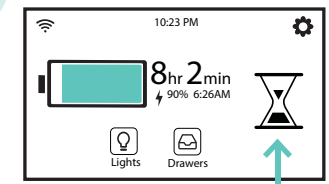
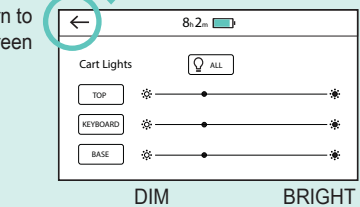
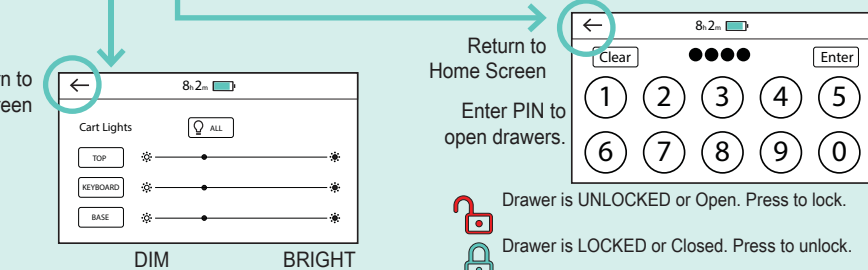

This symbol means the lift engine has been moving too much and needs time to cool down.

For complete and up-to-date touch screen instructions visit the 'DOWLOADS' on the product page at www.ergotron.com

For cleaning instructions visit the 'DOWLOADS' on the product page at www.ergotron.com

For information about eKinnex, visit: www.ergotron.com/ekinnex

For the latest User Installation Guide please visit: www.ergotron.com | English, Español, Français, Deutsch, Nederlands, Italiano, Svenska, 日本語, 汉语

