



ScanSnap

ScanSnap S1300i

ScanSnap S1300i

ScanSnap
S1300i



- Impressive scanning speed (12 ppm / 24 ipm)
- Supports capturing documents for e-mail, printing and for use with Microsoft® Word and Excel
- Business Card scanning software
- Top-class OCR engine
- Seamlessly sync to iPad® and iPhone®, Android™ and Kindle™ devices
- Scan your documents to a variety of popular cloud services via the intuitive QuickMenu



iOS

shaping tomorrow with you

FUJITSU

ScanSnap S1300i

Portable and intuitive scanner for enhanced productivity

The portable ScanSnap S1300i provides Windows and Mac users the tools to be productive and paperless... anywhere – anytime.

Simple, Speedy & Compact!

The ScanSnap S1300i is a document scanner for the PC or Mac user capable of scanning up to 12 pages per minute / 24 images per minute. The 10 page ADF can cope with a mixed variety of single or double sided documents ranging in different size and thickness as well as colour or black and white.

Auto deskew and auto orientation



Auto-size detection



Automatic resolution function

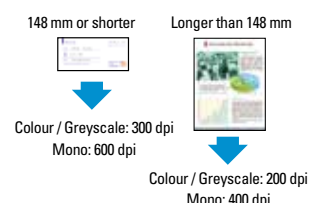

Intelligent auto colour detection



Efficiently manages scanned documents

- S1300i users can easily locate specific ScanSnap generated PDF and JPEG files by viewing displayed thumbnail images
- Keyword searches can be performed on S1300i generated PDF file text
- The S1300i creates searchable PDF files by performing OCR functions when the linked computer CPU is idling

Intelligent cropping (PC users only)

This feature enables users to easily “cut out” digitised copies of newspaper and magazine articles that they have outlined on the original paper document with a highlight pen.

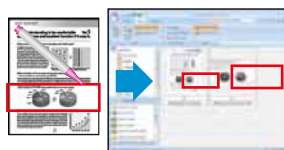

Intelligent indexing

This feature extracts text from sections of scanned images that have been highlighted. This index information can then be attached to PDF files as so called Meta Data.

The S1300i “Quick Menu” facilitates intuitive use

Users just choose what they want to do from the Quick Menu, which appears after a document has been scanned. The S1300i Quick Menu is perfect for everyone, even the complete novice!

Quick Menu for Windows® OS Users



Quick Menu for Mac OS Users



PDF Management and search software

Bundled

For PC users: **ScanSnap Organizer**



Document received



Document scanned



Now make your paper productive



Generates Microsoft® Word, Excel® and PowerPoint® files*

Editable images can be created by scanning directly to Microsoft Word, Excel and PowerPoint**

*For Mac OS, scanning to Microsoft Word and Excel is available
** Generated images and text may vary from the original

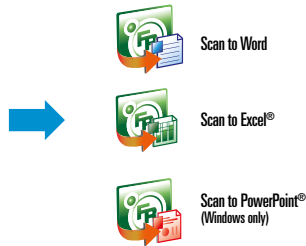

Efficiently organises Business Card information

- Scans large volumes of business cards into digital business card holders
- Enables users to export scanned data into Excel, Outlook, Salesforce and other contact management tools for future reference



ScanSnap S1300i Deluxe includes Rack2-File® Smart and Magic Desktop



Rack2-File Smart allows you to save your scanned and existing digital data in realistic looking bookcases and files that can then be easily retrieved and flipped through the way you may with regular files.

Access and utilise this data anywhere whether through your cloud services or if via a smart device, you can edit, add a comment and then save or redistribute.

Magic Desktop enables you to organise / edit image files or scan data imported from ScanSnap in a workspace simulating an actual desktop. You can seamlessly organise your work by categorising data per group and you can also share information with a group with the communication function that links with Facebook.

Scans to a greater range of mobile devices

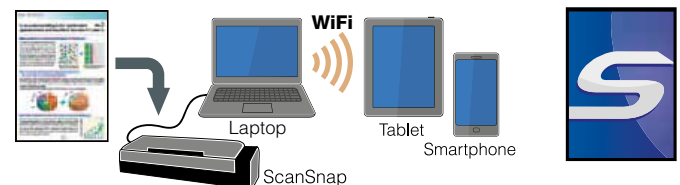

Like all scanners of the ScanSnap series, the S1300i supports wireless scanning to iPad® and iPhone® devices for convenient mobile viewing via the ScanSnap Connect Application*, which now comes in a version for Android™ smartphones and tablets and also for Kindle™ devices.

* ScanSnap Connect Application is available as a free download from the official application distribution service of the device (Google Play, Apple App Store and Amazon App Store). The Wi-Fi of the ScanSnap installed computer must be turned on to use this feature.

Top-class OCR engine

Bundled

ABBYY FineReader for ScanSnap™

Seamless linking to Cloud services

The ScanSnap series scanners come with a standard array of functions for near effortless scanning to Evernote, Google Docs, Salesforce, SugarSync and Dropbox.

ScanSnap Folder (Windows OS only)

You can now easily scan into your preferred application or cloud service even when no scan interface is available, through the import capability. Browse to the new ScanSnap Folder and hit the blue scan button. The documents are now imported into your application and automatically deleted from the ScanSnap Folder on your local computer!

ScanSnap welcomes Dropbox

Dropbox is a free service that lets you bring all your photos, docs and videos anywhere. This means that any file you save to your Dropbox will automatically save to all your computers, phones and even the Dropbox website.

With more cloud services to choose from, ScanSnap customers are sure to find the right application for their documents.

ScanSnap S1300i Specifications

Model		ScanSnap S1300i
Supported operating systems		Supports Windows and Mac OS, see http://www.scansnap.fujitsu.com/g-support/en for further information
Scanner type		ADF (automatic document feeder)
Scanning modes		Simplex / Duplex scanning, Colour / Greyscale / Mono / Automatic (colour / greyscale / mono detection)
Image sensor		CIS (contact image sensor) x 2
Light source		3 Colour LED (red / green / blue)
Optical resolution		600 dpi
Scanning speed ^{*1} (A4 Portrait) AC Adapter	Auto mode ^{*2}	Simplex: 6 ppm, Duplex: 12 ipm
	Normal mode	Simplex (colour / greyscale 150 dpi) (mono 300 dpi): 12 ppm, Duplex (colour / greyscale 150 dpi) (mono 300 dpi): 24 ipm
	Better mode	Simplex (colour / greyscale 200 dpi) (mono 400 dpi): 9 ppm, Duplex (colour / greyscale 200 dpi) (mono 400 dpi): 18 ipm
	Best mode	Simplex (colour / greyscale 300 dpi) (mono 600 dpi): 6 ppm, Duplex (colour / greyscale 300 dpi) (mono 600 dpi): 12 ipm
	Excellent mode	Simplex (colour / greyscale 600 dpi) (mono 1,200 dpi): 1 ppm, Duplex (colour / greyscale 600 dpi) (mono 1,200 dpi): 2 ipm
Scanning speed ^{*1} (A4 Portrait) USB bus powered ^{*3}	Auto mode ^{*2}	Simplex: 2 ppm, Duplex: 4 ipm
	Normal mode	Simplex (colour / greyscale 150 dpi) (mono 300 dpi): 4 ppm, Duplex (colour / greyscale 150 dpi) (mono 300 dpi): 8 ipm
	Better mode	Simplex (colour / greyscale 200 dpi) (mono 400 dpi): 3 ppm, Duplex (colour / greyscale 200 dpi) (mono 400 dpi): 6 ipm
	Best mode	Simplex (colour / greyscale 300 dpi) (mono 600 dpi): 2 ppm, Duplex (colour / greyscale 300 dpi) (mono 600 dpi): 4 ipm
	Excellent mode	Simplex (colour / greyscale 600 dpi) (mono 1,200 dpi): 1 ppm, Duplex (colour / greyscale 600 dpi) (mono 1,200 dpi): 2 ipm
Document size	Normal mode	A4, A5, A6, B5, B6, business card, postcard, letter, legal and custom sizes Minimum : 50.8 x 50.8 mm / Maximum : 216 x 360 mm / Automatically recognises document size
	Long paper scanning ^{*4}	863 mm in length
Recommended paper weight		64 to 104.7 g/m ²
Paper chute capacity ^{*5}		10 sheets (A4: 80 g/m ²)
Interface		USB 2.0 (USB 1.1 Supported)
Power requirements	AC connection	AC 100 to 240V, 50 / 60Hz
	USB connection	AC 5V / 1A (0.5A x 2 port)
Power consumption	AC connection	Operating: 9W or less (Sleep mode: 2.6W or less)
	USB connection	Operating: 5W or less (Sleep mode: 2W or less)
Operating environment		Temperature : 5 to 35°C / Relative humidity: 20 to 80% (Non-condensing)
Dimensions (W x D x H) ^{*6} / Weight		284 x 99 x 77 mm / 1.4kg
Environmental compliance		ENERGY STAR [®] / RoHS ^{†7} / Ecodesign ^{†8}
Other	Double-feed detection	Length check

- ^{*1} Scanning speeds may vary due to the system environment used
- ^{*2} Documents measuring approximately 148 mm in length or less are scanned in "Best mode", while other documents are scanned in "Better mode"
- ^{*3} When using the USB bus power cable, the personal computer must have two USB ports: one for power feeding, the other for USB cable connection
- ^{*4} The S1300i is capable of scanning documents that exceed A4 size in length. This function is available for all modes except Excellent mode
- ^{*5} Maximum capacity varies, depending upon paper weight
- ^{*6} When chute is closed
- ^{*7} PFU LIMITED, a Fujitsu company, has determined that this product meets RoHS requirements (2002/95/EC)
- ^{*8} PFU LIMITED, a Fujitsu company, has determined that this product meets Ecodesign Directive requirements (2009/125/EC)
- ^{*9} The software is available to be downloaded from the ScanSnap website: <http://scansnap.fujitsu.com/g-support/en/>



Bundled software	Purpose	Software	PC Compatible	MAC Compatible
	Scanner driver	ScanSnap Manager	✓	✓
	File management	ScanSnap Organizer	✓	
	Business card management	CardMinder™	✓	
		Cardiris™		✓
	Text recognition	ABBYY FineReader for ScanSnap™	✓	✓
	Cloud	Evernote	✓	✓
ECM linkage software		Scan to Microsoft® SharePoint™ ^{*9}	✓	

Consumables and options	Part number	Remarks
Consumable kit	CON-3541-010A	1 x pick roller; 2 x pad assy; total maximum lifetime 100,000 documents or 1 year
Cleaning kit	SC-CLE-SS	24 cleaning fluid impregnated wipes
ScanSnap case ^{*1}	PA03541-0004	Intended for ScanSnap S1300i, S1300, S300, S300M and included items

- ^{*1} This product has been especially designed for storing and carrying ScanSnap S1300i / S1300 / S300 / S300M. Please note that this product is not guaranteed to withstand damage by excessive shock or external pressure

All names, manufacturer names, brand and product designations are subject to special trademark rights and are manufacturer's trademarks and/or registered brands of their respective owners. All indications are non-binding. Technical data is subject to change without prior notification. Apple iPad, iPhone, iPod touch and iTunes are trademarks of Apple Inc., registered in the U.S. and other countries. App Store is a service mark of Apple Inc.

PFU Imaging Solutions Europe Limited
Hayes Park Central
Hayes End Road, Hayes
Middlesex UB4 8FE
United Kingdom

Tel: +44 (0)20 8573 4444
Fax: +44 (0)20 8573 2643

www.ScanSnapit.com

PFU Imaging Solutions Europe Limited
Frankfurter Ring 211
80807 Munich
Germany

Tel: +49 (0)89 32378 0
Fax: +49 (0)89 32378 100

PFU Imaging Solutions Europe Limited
Via Nazario Sauro, 38
20099 Sesto San Giovanni (MI)
Italy

Tel: +39 0226294 1
Fax: +39 0226294 201

FUJITSU