

SCIMITAR RGB ELITE

MOBA/MMO GAMING MOUSE

GETTING TO KNOW YOUR MOUSE

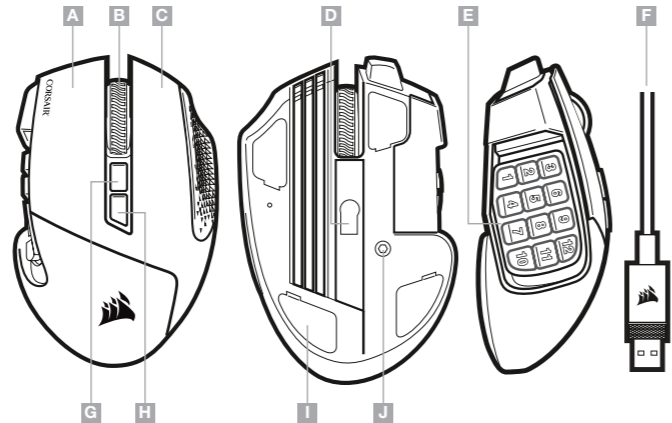

- A — LEFT CLICK BUTTON
- B — MIDDLE CLICK BUTTON
- C — RIGHT CLICK BUTTON
- D — OPTICAL GAMING SENSOR
- E — SIDE KEYPAD BUTTONS
- F — USB CONNECTION CABLE
- G — PROFILE CYCLE BUTTON
- H — DPI CYCLE BUTTON
- I — PTFE GLIDE PADS
- J — KEYPAD SLIDER LOCK

SETTING UP YOUR MOUSE

- > Turn on your computer and connect the mouse to available USB 2.0 or USB 3.0 port on your computer.
- > Download the iCUE software from www.corsair.com/downloads.
- > Run the installer program and follow instructions for installation.

ENGLISH

ADJUSTING THE KEY SLIDER

- Patented Key Slider™ control system lets you reposition the 12 side buttons to comfortably fit your grip.
- To adjust the keypad slider, please follow the steps below:
- > Insert the included Allen key into the keypad slider lock located at the bottom of the mouse and turn it counterclockwise to unlock the keypad.
 - > Move keypad to desired position and turn the Allen key clockwise to lock the keypad.

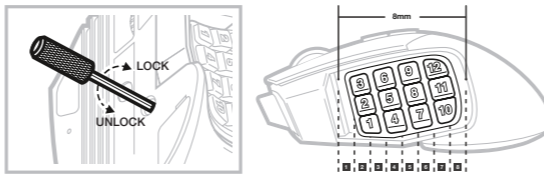

ONBOARD PROFILES

Three onboard profile slots hold predefined DPI settings, button assignments and lighting effects. All those settings can be fully customized using iCUE software and stored back in onboard memory.

	PROFILE #1	PROFILE #2	PROFILE #3	PROFILE #1	PROFILE #2	PROFILE #3
ONBOARD PROFILE STATUS LED	RED	GREEN	BLUE	KEYPAD SLIDER MAPPING		
STAGE #1	RED	800 DPI	400 DPI	800 DPI	800 DPI	800 DPI
STAGE #2	WHITE	1500 DPI	800 DPI	1500 DPI	1500 DPI	1500 DPI
STAGE #3	GREEN	3000 DPI	1500 DPI	4500 DPI	4500 DPI	4500 DPI
STAGE #4	PURPLE	6000 DPI	3000 DPI	9000 DPI	9000 DPI	9000 DPI
STAGE #5	CAPRI	9000 DPI	6000 DPI	18000 DPI	18000 DPI	18000 DPI
BUTTON 1	1	1	1	1	1	1
BUTTON 2	2	2	2	2	2	2
BUTTON 3	3	3	3	3	3	3
BUTTON 4	4	4	4	4	4	4
BUTTON 5	5	5	5	5	5	5
BUTTON 6	6	6	6	6	6	6
BUTTON 7	7	7	7	7	7	7
BUTTON 8	8	8	8	8	8	8
BUTTON 9	9	9	9	9	9	9
BUTTON 10	0	0	0	0	0	0
BUTTON 11	-	-	-	-	-	-
BUTTON 12	=	=	=	=	=	=

This Class B digital apparatus meets all requirements of the Canadian Interference-Causing Equipment Regulations, CAN ICES-3(B)/NMB-3(B)

CAUTION! The manufacturer is not responsible for any radio or TV interference caused by unauthorized modifications to this equipment. Such modifications could void the user authority to operate the equipment.

WARNING: Changes or modifications not expressly approved by CORSAIR MEMORY, Inc could void the user's authority to operate the equipment.

This equipment has been tested and found to comply with the limits for a Class B digital device, pursuant to part 15 of the FCC Rules. These limits are designed to provide reasonable protection against harmful interference in a residential installation. This equipment generates, uses and can radiate radio frequency energy and, if not installed and used in accordance with the instructions, may cause harmful interference to radio communications. However, there is no guarantee that interference will not occur in a particular installation. If this equipment does cause harmful interference to radio or television reception, which can be determined by turning the equipment off and on, the user is encouraged to try to correct the interference by one or more of the following measures:

- > Reorient or relocate the receiving antenna.
 - > Increase the separation between the equipment and receiver.
 - > Connect the equipment into an outlet on a circuit different from that to which the receiver is connected.
 - > Consult the dealer or an experienced radio/TV technician for help.
- This device must not be co-located or operating in conjunction with any other antenna or transmitter. Operation is subject to the following two conditions:

- (1) this device may not cause harmful interference, and
- (2) this device must accept any interference received, including interference that may cause undesired operation.

For use only with NRTL listed end product and mouse rating: 5V 170mA

ENGLISH

PRÉSENTATION DE LA SOURIS

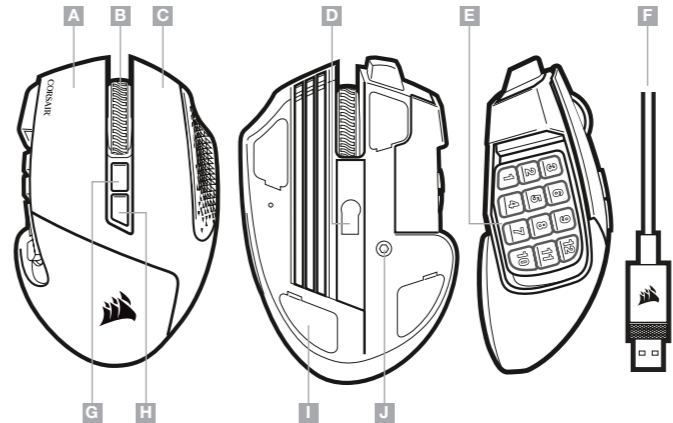

- A — BOUTON DE CLIC GAUCHE
- B — BOUTON DE CLIC DU MILIEU
- C — BOUTON DE CLIC DROIT
- D — CAPTEUR DE JEU OPTIQUE
- E — BOUTONS DU PAVÉ LATÉRAL
- F — CÂBLE DE CONNEXION USB
- G — BOUTON DE DÉFILEMENT DE PROFILS
- H — BOUTON DE DÉFILEMENT PPP
- I — PATINS EN PTFE
- J — VERROUILLAGE DU PAVÉ COULISSANT

CONFIGURATION DE LA SOURIS

- > Allumez votre ordinateur et branchez la souris sur un port USB 2.0 ou USB 3.0 disponible sur votre ordinateur.
- > Téléchargez le logiciel iCUE à l'adresse www.corsair.com/downloads.
- > Exécutez le programme d'installation et suivez les instructions d'installation.

FRANÇAIS

RÉGLAGE DU PAVÉ COULISSANT

- Le système de contrôle breveté Key Slider™ vous permet de repositionner les 12 boutons latéraux pour qu'ils s'adaptent confortablement à votre main. Pour régler le pavé coulissant, suivez les étapes suivantes:
- > Insérez la clé Allen (hexagonale) fournie dans le verrou du pavé coulissant situé sous la souris et tournez-la dans le sens contraire des aiguilles d'une montre pour déverrouiller le pavé.
 - > Placez le pavé à la position souhaitée et tournez la clé Allen dans le sens des aiguilles d'une montre pour le verrouiller.

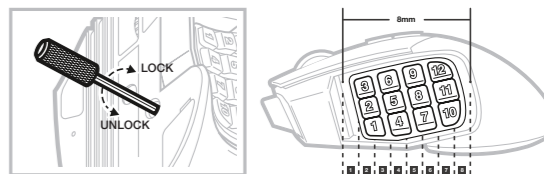

PROFILS INTÉGRÉS

Trois emplacements de profil intégrés contiennent les paramètres PPP, les affectations de boutons et les effets d'éclairage prédéfinis. Tous ces paramètres peuvent être entièrement personnalisés à l'aide du logiciel iCUE et retransférés dans la mémoire intégrée.

DEL D'ÉTAT DE PROFIL INTÉGRÉ		PROFIL 1	PROFIL 2	PROFIL 3
		ROUGE	VERT	BLEU
ÉTAT DE NIVEAU PPP				
NIVEAU 1	ROUGE	800 PPP	400 PPP	800 PPP
NIVEAU 2	BLANC	1500 PPP	800 PPP	1500 PPP
NIVEAU 3	VERT	3000 PPP	1500 PPP	4500 PPP
NIVEAU 4	VIOLET	6000 PPP	3000 PPP	9000 PPP
NIVEAU 5	BLEU CIEL	9000 PPP	6000 PPP	18000 PPP
MAPPAGE DU PAVÉ COULISSANT				
BOUTON 1		1	1	1
BOUTON 2		2	2	2
BOUTON 3		3	3	3
BOUTON 4		4	4	4
BOUTON 5		5	5	5
BOUTON 6		6	6	6
BOUTON 7		7	7	7
BOUTON 8		8	8	8
BOUTON 9		9	9	9
BOUTON 10		0	0	0
BOUTON 11		-	-	-
BOUTON 12		=	=	=

Cet appareil numérique de la class B respecte toutes les exigences du Règlement sur le matériel brouilleur du Canada.

FRANÇAIS

SCIMITAR RGB ELITE



WEB: corsair.com
PHONE: (888) 222-4346
SUPPORT: support.corsair.com

BLOG: corsair.com/blog
FORUM: forum.corsair.com
YOUTUBE: youtube.com/corsairhowto

© 2019 CORSAIR MEMORY, Inc. All rights reserved. CORSAIR and the sails logo are registered trademarks in the United States and/or other countries. All other trademarks are the property of their respective owners. Product may vary slightly from those pictured. 49-001943 AA



CONOZCA SU MOUSE

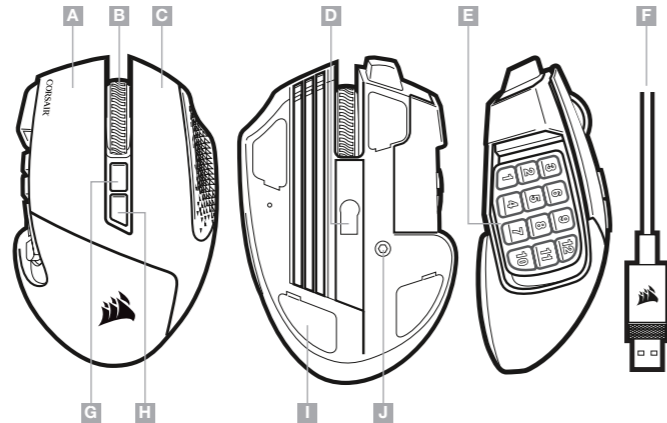

- A — BOTÓN DE CLIC IZQUIERDO
- B — BOTÓN DE CLIC MEDIO
- C — BOTÓN DE CLIC DERECHO
- D — SENSOR ÓPTICO DE JUEGOS
- E — BOTONES DEL TECLADO LATERAL
- F — CABLE DE CONEXIÓN USB
- G — BOTÓN DE CICLO DE PERFILES
- H — BOTÓN DE CICLO DE DPI
- I — COJINES DE DESLIZAMIENTO PTFE
- J — BLOQUEO DESLIZANTE DEL TECLADO

CONFIGURACIÓN DEL MOUSE

- > Encienda su computadora y conecte el mouse a un puerto USB 2.0 o 3.0 disponible..
- > Descargue el software de iCUE en www.corsair.com/downloads.
- > Ejecute el instalador y siga las instrucciones para completar la instalación.

ESPAÑOL

AJUSTE DE KEY SLIDER

El sistema de control patentado Key Slider™ le permite reubicar los 12 botones laterales para adaptarlos a su agarre más cómodo. Para ajustar el deslizamiento del teclado, realice los siguientes pasos:

- > Inserte la llave Allen (se incluye) en el bloqueo deslizante del teclado que se encuentra en la parte inferior del mouse. Gire la llave hacia la izquierda para desbloquear el teclado.
- > Mueva el teclado a la posición deseada y gire la llave Allen hacia la derecha para bloquearlo.

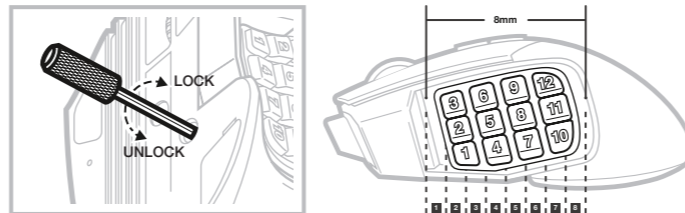

PERFILES INTEGRADOS

Los tres perfiles integrados incluyen opciones de configuración predefinidas de DPI, asignaciones de botones y efectos de luces. Todas estas opciones se pueden personalizar totalmente con el software iCUE y guardarlas en la memoria integrada.

LUZ LED DE ESTADO DEL PERFIL INTEGRADO	PERFIL #1	PERFIL #2	PERFIL #3
	ROJO	VERDE	AZUL
ESTADO DE LA ETAPA DPI			
ETAPA #1	ROJO 800 DPI	400 DPI	800 DPI
ETAPA #2	BLANCO 1500 DPI	800 DPI	1500 DPI
ETAPA #3	VERDE 3000 DPI	1500 DPI	4500 DPI
ETAPA #4	PÚRPURA 6000 DPI	3000 DPI	9000 DPI
ETAPA #5	AZUL CAPRI 9000 DPI	6000 DPI	18000 DPI

ASIGNACIÓN DE COMANDOS DEL TECLADO			
BOTÓN 1	1	1	1
BOTÓN 2	2	2	2
BOTÓN 3	3	3	3
BOTÓN 4	4	4	4
BOTÓN 5	5	5	5
BOTÓN 6	6	6	6
BOTÓN 7	7	7	7
BOTÓN 8	8	8	8
BOTÓN 9	9	9	9
BOTÓN 10	0	0	0
BOTÓN 11	-	-	-
BOTÓN 12	=	=	=

ESPAÑOL

CONHEÇA O SEU MOUSE

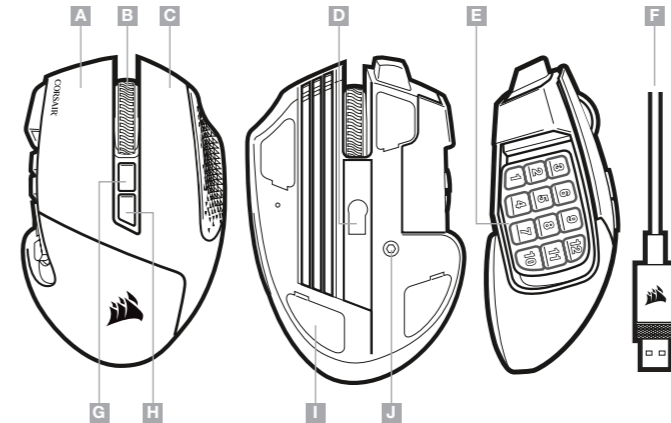

- A — BOTÃO DE CLIQUE ESQUERDO
- B — BOTÃO DE CLIQUE CENTRAL
- C — BOTÃO DE CLIQUE DIREITO
- D — SENSOR ÓPTICO PARA JOGOS
- E — BOTÕES DE TECLADO LATERAL
- F — CABO DE CONEXÃO USB
- G — BOTÃO DE CICLO DE PERFIL
- H — BOTÃO DE CICLO DPI
- I — ALMOFADAS DESLIZANTES DE PTFE
- J — TRAVA DO DESLIZADOR DO TECLADO

CONFIGURAÇÃO DO MOUSE

- > Ligue o computador e conecte o mouse a uma porta USB 2.0 ou USB 3.0 do computador.
- > Baixe o software iCUE em www.corsair.com/downloads.
- > Execute o programa de instalação e siga as instruções.

PORTUGUÊS

AJUSTE DO KEY SLIDER

O sistema de controle patentado Key Slider™ permite que você repositone os 12 botões laterais para se encaixarem confortavelmente na sua mão. Para ajustar o deslizador do teclado, siga os passos abaixo:

- > Insira a chave Allen incluída na trava do deslizador de teclado localizada na parte inferior do mouse e gire-a no sentido anti-horário para destravar o teclado.
- > Mova o teclado para a posição desejada e vire a chave Allen no sentido horário para travar o teclado.

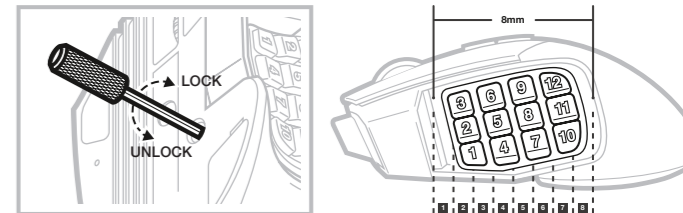

ARMAZENAMENTO INTERNO DE PERFIS

Três slots de armazenamento interno de perfil contêm configurações predefinidas de DPI, atribuições de botões e efeitos de iluminação. Todas essas configurações podem ser completamente personalizadas usando o software iCUE e armazenadas novamente na memória interna.

LED DE STATUS DO PERFIL INTERNO	PERFIL N.º 1	PERFIL N.º 2	PERFIL N.º 3
	VERMELHO	VERDE	AZUL
STATUS DO ESTÁGIO DE DPI			
ESTÁGIO N.º 1	VERMELHO 800 DPI	400 DPI	800 DPI
ESTÁGIO N.º 2	BRANCO 1500 DPI	800 DPI	1500 DPI
ESTÁGIO N.º 3	VERDE 3000 DPI	1500 DPI	4500 DPI
ESTÁGIO N.º 4	ROXO 6000 DPI	3000 DPI	9000 DPI
ESTÁGIO N.º 5	CAPRI 9000 DPI	6000 DPI	18000 DPI

MAPEAMENTO DO DESLIZADOR DE TECLADO			
BOTÃO 1	1	1	1
BOTÃO 2	2	2	2
BOTÃO 3	3	3	3
BOTÃO 4	4	4	4
BOTÃO 5	5	5	5
BOTÃO 6	6	6	6
BOTÃO 7	7	7	7
BOTÃO 8	8	8	8
BOTÃO 9	9	9	9
BOTÃO 10	0	0	0
BOTÃO 11	-	-	-
BOTÃO 12	=	=	=

PORTUGUÊS