

WorkForce WF-7610DWF



DATASHEET / BROCHURE



A3 duplex business printer that can quickly produce affordable, business-quality documents.

Ideal if you need to print A3-sized documents on a regular basis, this business printer with Wi-Fi and Ethernet features fast business-quality printing of up to 18ppm¹ and 10.9cm touch-screen. It also comes with a front-loading paper tray and features high yield cartridges to help printing costs low. Print up to 2,200 pages² with the XXL black ink cartridge.

A3 duplex 4-in-1

This business printer comes with a 35-sheet automatic document feeder and offers A3 duplex print, scan, copy and fax. As well as the front loading paper tray, the rear speciality paper path means you can print on a wide range of thicker paper, envelopes or labels to suit your business needs.

Mobile printing

Epson Connect³ allows you to print important office documents from smartphones and tablets. You can also print from anywhere in the world by emailing files directly to the printer, and store scanned documents in cloud services. In addition, this printer is also Google Cloud Print and Apple AirPrint compatible. For added versatility, Wi-Fi Direct™ allows easy printing from wireless devices without having to connect to a wireless router.

New printhead

PrecisionCore, Epson's most advanced printhead technology, powers the industry-leading output quality and durability that Epson is renowned for, at the high speeds required for office, commercial and industrial printing.

Durable ink

Epson's DURABrite Ultra Ink is ideal for producing laser-like business documents. Documents are water, smudge and highlighter resistant, while its quick-drying properties make it perfect for duplex printing. Available in 27XXL, 27XL and standard sizes, these high-capacity, individual ink cartridges offer great savings, with a 50% lower cost-per-page than competitive lasers⁴.

KEY FEATURES

- **A3 4-in-1**
Duplex print, scan, copy and fax
- **Fast print speeds**
Business-quality 18ppm printing¹
- **Connectivity**
Wi-Fi, Wi-Fi Direct and Ethernet
- **Front paper tray**
250-sheet capacity
- **Epson Connect**
Freedom to print and scan anywhere

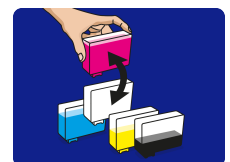

PRODUCT SPECIFICATIONS

TECHNOLOGY	
Printing Method	PrecisionCore™ Print Head
Minimum Droplet Size	2.8 pl, With Variable-Sized Droplet Technology
Ink Technology	DURABrite™ Ultra
PRINT	
Printing Speed ISO/IEC 24734	18 pages/min Monochrome, 10 pages/min Colour
Duplex Printing Speed	8.7 A4 Pages/min Monochrome, 6 A4 Pages/min Colour
ISO/IEC 24734	
Maximum Printing Speed	32 pages/min Monochrome (plain paper 75 g/m ²), 20 pages/min Colour (plain paper 75 g/m ²)
Printing Resolution	4,800 x 2,400 DPI
Printing Volume	20,000 pages per month
	The maximum number of printed pages per month based on the performance capabilities of the printer, including ISO rated print speeds and paper handling capabilities.
Colours	Black, Cyan, Yellow, Magenta
For detailed information on printing speeds please visit http://www.epson.eu/testing .	
SCAN	
Optical Resolution	1,200 DPI x 2,400 DPI (Horizontal x Vertical)
Output formats	BMP, JPEG, TIFF, PDF, searchable PDF
Scanner type	Contact image sensor (CIS)
FAX	
Fax speed dials (max)	200 names and numbers
Page memory	Up to 550 pages/ 6MB (ITU-T No. 1 chart)
Fax Functions	Favorites, PC Fax, Auto Redial, Speed Dial
PAPER / MEDIA HANDLING	
Paper Formats	A3+, A3 (29.7x42.0 cm), A4 (21.0x29.7 cm), A5 (14.8x21.0 cm), A6 (10.5x14.8 cm), B4 (25.7x36.4 cm), B5 (17.6x25.7 cm), C4 (Envelope), C6 (Envelope), DL (Envelope), No. 10 (Envelope), Letter, 9 x 13 cm, 10 x 15 cm, 13 x 18 cm, 16:9, User defined, Legal
Automatic Document Feed	35 pages
Duplex	Yes (A4/A3, plain paper)
Paper Tray Capacity	250 Sheets Standard, 250 Sheets Maximum
Number of paper trays	1
CONNECTIVITY	
Interfaces	Hi-Speed USB - compatible with USB 2.0 specification, Ethernet interface (100 Base-TX / 10 Base-T), Wireless LAN IEEE 802.11b/g/n, Wi-Fi Direct
WLAN Security	WEP 64 Bit, WEP 128 Bit, WPA PSK (TKIP), WPA PSK (AES)
GENERAL	
Energy Use	19 Watt (standalone copying, ISO/IEC 24712 pattern), 1.7 Watt (sleep mode), 8.5 Watt (Ready), 0.3 Watt (Power off)
OTHER	
Warranty	12 months On-site service Optional warranty extension available

LOGISTICS INFORMATION

SKU	C11CC98301
EAN code	8715946529585
Country of Origin	Indonesia
Layer	2 Units
Layer Block	2 Units



For more information please contact:

Home users: 0343 90 37766
 Business users*: 0871 42 37766
 Republic of Ireland: 01 436 7742
 Or visit us at <https://www.epson.co.uk/contactus>
 * 10p per minute plus network extras.

Web: www.epson.co.uk
www.epson.ie

Trademarks and registered trademarks are the property of Seiko Epson Corporation or their respective owners. Product information is subject to change without prior notice.

WorkForce WF-7610DWF

WHAT'S IN THE BOX

- CD Manual
- Driver and utilities (CD)
- Individual Ink Cartridges
- Main unit
- Power cable
- Quick Start Guide
- Software (CD)
- Warranty document

INK CARTRIDGE COMPATIBILITY



INK YIELD DATA

	Alarm clock 27	Alarm clock 27XL	Alarm clock 27XXL
	350 pages*	1,100 pages*	2,200 pages*
	Alarm clock 27	Alarm clock 27XL	Alarm clock 27XXL
	300 pages*	1,100 pages*	

* Approx. page yield based on ISO/IEC 24711/24712 or ISO/IEC 29102/29103. Actual yield will vary depending on images printed and usage conditions. For more information visit <http://www.epson.eu/pageyield>

1. - Determined in accordance with ISO/IEC 24734 showing the average of ESAT from the Office Category Test for default A4 simplex and duplex. For more information, please visit www.epson.eu/testing
- 2.
3. - Approx. page yield based on ISO/IEC 24711/24712. Actual yield will vary depending on images printed and usage conditions. For more information visit www.epson.eu/pageyield
- 4.
5. - Epson iPrint requires a wireless connection and the Epson printing app. Epson Email print, Epson Remote Print Driver and Epson Scan-to-Cloud require a connection to the internet. For more information, supported languages and devices, please visit www.epsonconnect.eu
- 6.
7. - For more information, please visit www.epson.eu/inkjetsaving