

Wall Mount Quick Installation Guide

1. Use two M2 x 4mm screws (in the DL camera package) to secure the cable fixing plate (in the DL camera package) to the camera. Plug in cables. Use 3 cable ties (in the DL camera package) to secure the cables and cable fixing plate.
2. Use the drilling paper included in the package to drill the holes in the wall where the user wants to mount the camera.

①

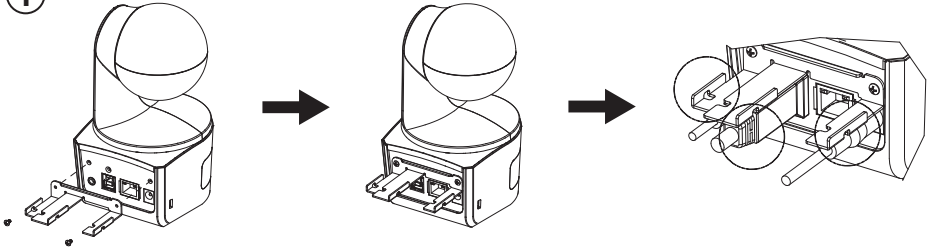

②

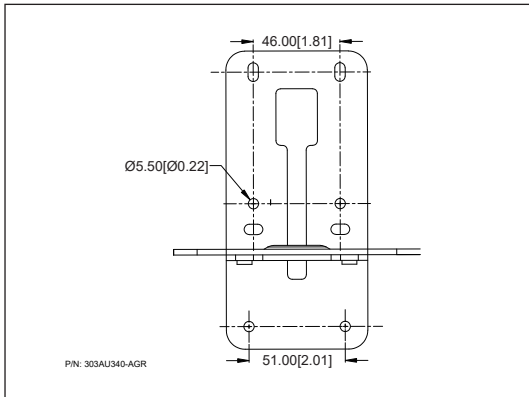

3. Use the screws specified below (not included) to secure the L-mount bracket onto the wall.
 [Note] For cement wall: M4 x 20mm self-tapping screws (x4) + plastic conical anchor
 For wooden wall: M4 x 20mm self-tapping screws (x4)
4. Then, assemble the L-mount brackets + with 2 screws (M4 x 8mm, included in the package).
5. After assembling the L-mount brackets, use the screws specified below (not included) to secure the lower part of L-mount brackets onto the wall.
 [Note] For cement wall: M4 x 20mm self-tapping screws (x2) + plastic conical anchor
 For wooden wall: M4 x 20mm self-tapping screws (x2)
6. Pass the cables through the hole on the L-mount brackets and connect the cables to their corresponding connection ports.
7. Use the remaining screw (1/4"-20, L=7.5mm, included in the package) to secure the camera on the L-mount brackets.

