

**PP-7600/7600K
POS Printer
User Manual**

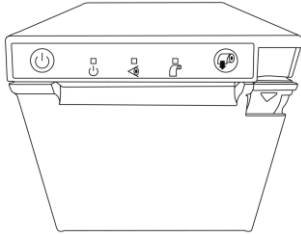

Package Contents

- ✓ POS Printer.....(x1)
- ✓ 80mm-wide Thermal Paper.....(x1)
(For operational testing)
- ✓ 58mm Paper Spacer Plate.....(x1)
- ✓ 24V/60W Power Adapter.....(x1)
- ✓ Power Cord.....(x1)
- ✓ USB Cable.....(x1)
- ✓ RS232 Cable (Optional).....(x1)
- ✓ Soft Wiping Cloth.....(x1)
- ✓ User Manual.....(x1)

Product Features

- 3" thermal printer with auto cutter
- Printing speed up to 200 mm/sec
- 80 mm or 58 mm paper width support
- Drop-and-load action for easy paper roll replacement
- Control over 2 cash drawers through 1 D.K port
- Interface: USB (True USB & Virtual COM selectable) + serial, optional LAN or WLAN (WiFi) interface module
- High compatibility with Android, Linux, and Windows operating system
- Easy wireless printing not only bringing along the mobility but also increasing the productivity
- Near end sensor
- Optional LD-2000 light bar modular



To avoid paper jam occurring, do NOT press the printer's cover open lever or pull the printed paper during printing.



When a paper jam occurs, press the cover open lever to release the paper cover. Then, remove the jammed paper and reinstall the paper roll. Next, close the paper cover properly and firmly.

If the auto cutter is still jammed, the paper cover will be locked. Should the cutter jam be so serious to interfere the paper cover release operation, please push the paper cover back and press the cover open lever several times. If the problem cannot be solved none the less, please call your local service center for help right away.

Views of the PP-7600/7600K

Front View

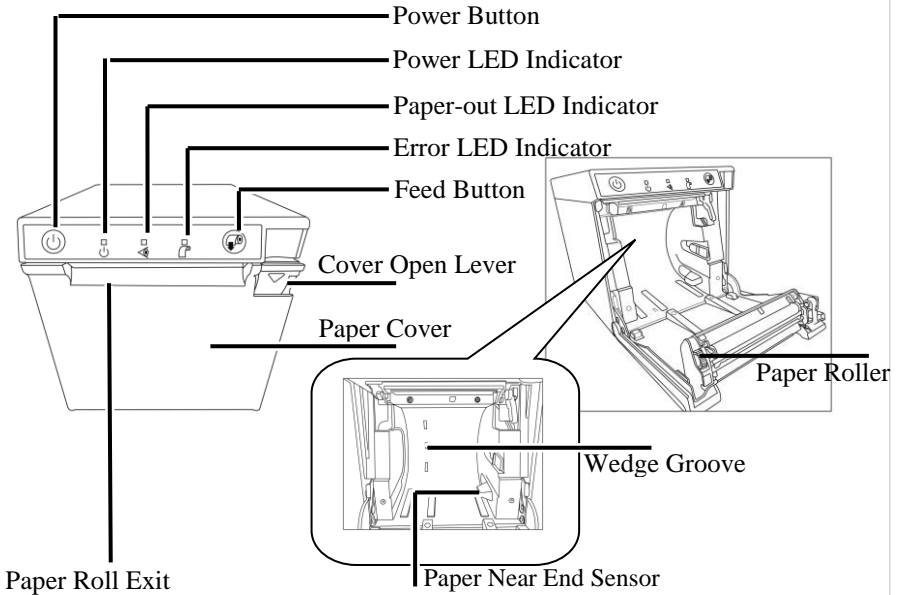

Part Names	Description
Power Button	This button turns the printer on or off. <i>(controllable for PP-7600 ONLY)</i>
Power LED Indicator	This indicator turns on when the printer is on.
Error LED Indicator	This indicator works when the printer has something wrong. For more details, refer to the Status LED Indicators section given below.
Paper-out LED Indicator	This indicator turns on when the paper-out issue occurs.
Feed Button	Press this button once to feed the paper roll for one line. Hold down this button to continue feeding the roll paper
Paper Cover	Open this cover when installing or replacing the paper roll.
Cover Open Lever	Push this lever to open the paper roll cover.
Paper Exit	An opening where the paper is outputted

Part Names	Description
Wedge Groove	A settled routine that makes the paper spacer plate hard to escape
Paper Near End Sensor	(Provided for adjusting the detection position to suit the diameter of the paper core used, and for adjusting the detection position of remaining amount of paper)

Rear View

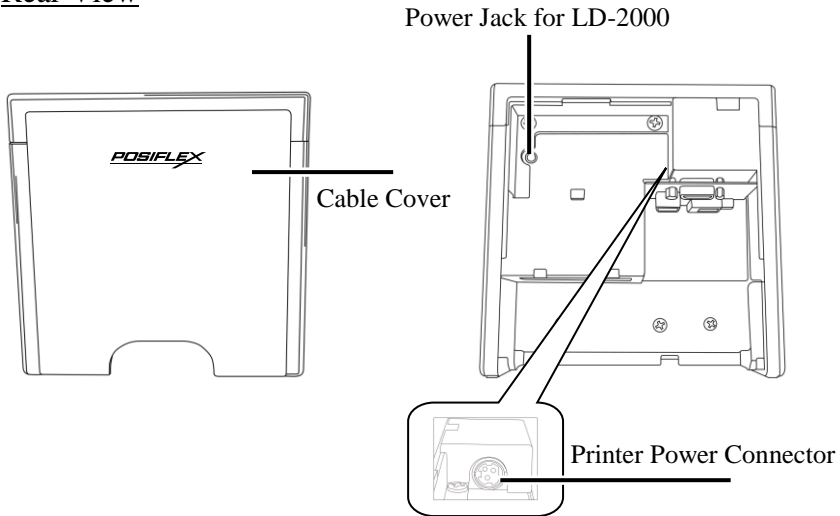

Part Names	Description
Power Jack for LD-2000	Connects the DC cable of LD-2000
Printer Power Connector	Connects the DC cable for the power adapter of the POS printer

Bottom View

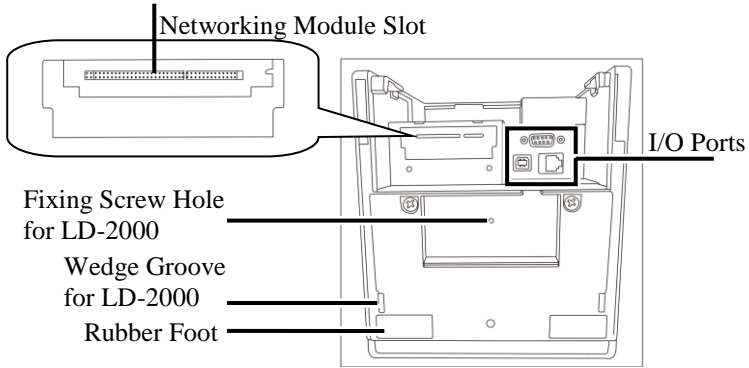

Part Names	Description
Networking Module Slot	A slot for optional LAN or Wi-Fi networking module
I/O Ports	USB connector (Type-B) Serial port connector (RS232) Cash drawer connector (RJ10)
Fixing Screw Hole for LD-2000	Formed for fixing the optional LD-2000 light bar
Wedge Groove for LD-2000	Formed for fixing the optional LD-2000 light bar

I/O Ports of the PP-7600/7600K

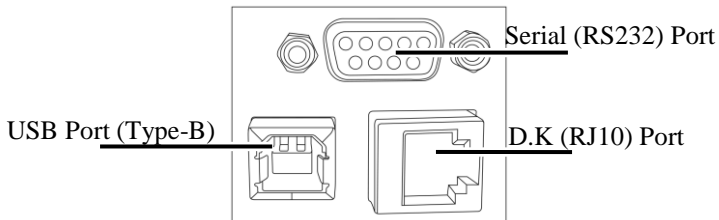

Loading a Paper Roll

Before loading a paper roll, make sure you use a specified paper type. Follow the steps below to load a paper roll.

1. Press down the cover open lever to release the paper cover.

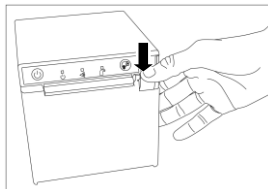

2. The paper cover ejects. Then, open the paper cover manually.

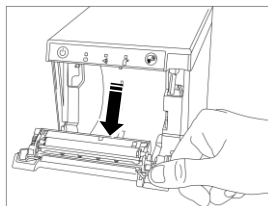

3. Drop the 80mm-wide thermal paper inside the paper compartment of the printer, as shown in the right figure.

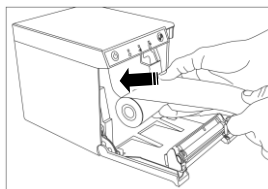

4. Drag the paper roll to the portion where the paper roller is installed.

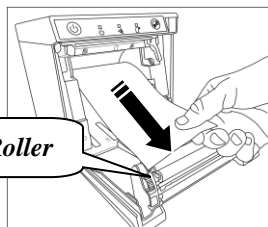

If you want to use a paper roll of 58mm width, install the spacer plate in the compartment of the printer, as shown in the right figure, and then load the paper roll of 58mm width into the partition at the right side of the plate.

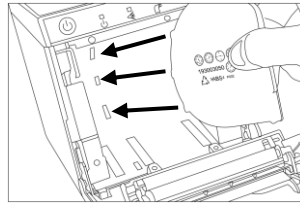

Next, set the paper width by using **PP-7600 Series thermal Printer Software Switch Utility for Windows**. The software switch utility can be downloaded from the Posiflex' global website: <http://www.posiflex.com/en-global/Download/download>. To get more detailed information on the paper width jumper setting, contact directly the Posiflex' technical service team.

5. To avoid the paper cover not being locked completely, push the central portion of the paper cover to close.

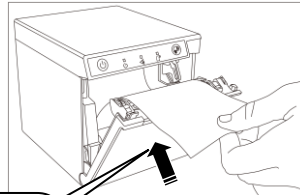

Push

Connecting Power Adapter and I/O Cables

Follow the steps listed below to open the rear cover and connect cables.

1. Hold the concave portion of the cable cover with thumb, as shown in the circled portion of the figure.

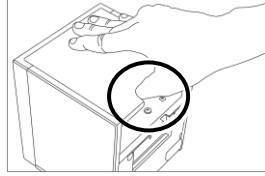

2. Pull the cover in the direction indicated by the arrow in the right figure.

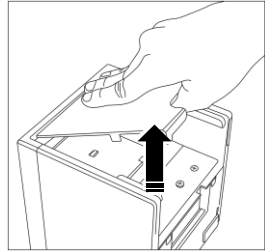

3. Remove the cable cover.

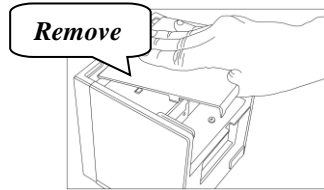

4. Connect power adapter to the printer power connector of the PP-7600.

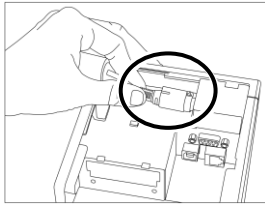

5. Connect I/O cable(s) to the I/O port(s) of the PP-7600.

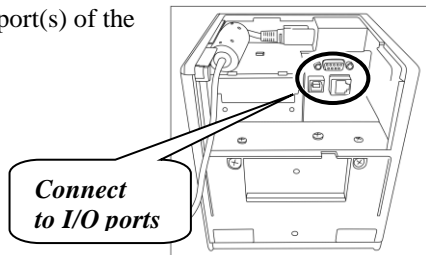



Please follow the instruction given below to connect I/O cables before powering on the printer.

Connect the POS printer with either a USB cable or a RS-232 cable to your POS terminal. After being powered ON, the POS printer will automatically detect its connected I/O port.

Reboot the printer if you switch the RS-232 interface of the printer to the USB interface and vice versa.

6. Make the cable cover wedge to the printer. Determine that the cable cover is well wedged to the printer.

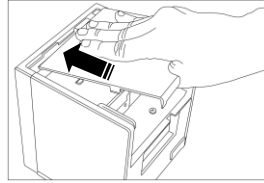

7. Cover the I/O ports of the printer.

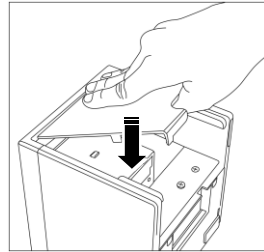

8. Determine that the cable cover is completely closed.

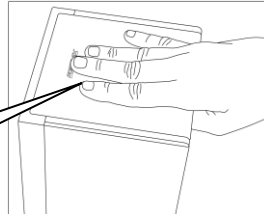

Firmly Closed

Setting up the Printer

The PP-7600/7600K can be set through the specific software switch setting utility for setup of other functions. Please visit our web site <http://www.posiflex.com/en-global/Download/download> to download the **PP-7600 Thermal Printer Software Switch Utility for Windows**. Software switches are divided into **SW1, SW2, SW3, and SW4**. After downloading the utility, please call your service center for support before operating the software switch setup.

Please reboot the printer after the switch settings are done.

Installing the LD-2000 Light Bar (Optional)

Follow the steps below to install the LD-2000 light bar on the POS printer.



Power off the printer when installing the LD-2000 light bar.

1. Determine that the micro USB connector of the cable for LD-2000 to the POS printer is securely connected to the micro USB port on the LD-2000 control board.

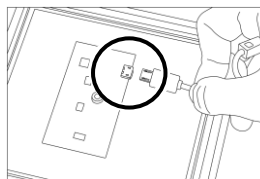

2. Plug the L-formed header of the LD-2000 power cable into the LD-2000 power jack of the POS printer.

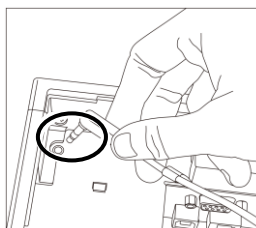
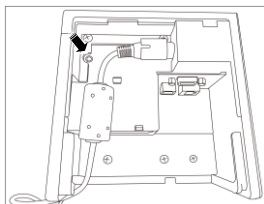

3. Make the four joints formed on the LD-2000 wedge to the four wedge grooves formed on the POS printer.

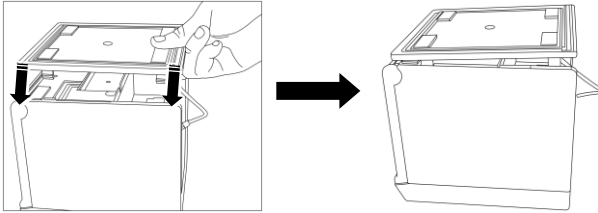

4. Determine that the LD-2000 securely connects to the POS printer.

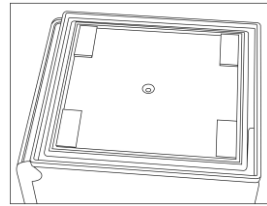

5. Fix the LD-2000 to the bottom side of the POS printer with a screw.

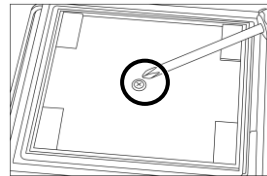

6. The installation of LD-2000 light bar is completed.

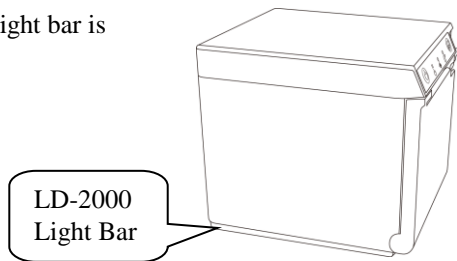

After installing the LD-2000 light bar, you can set up the LD-2000 by using the Posiflex LD2000 Tool. For more detailed information, refer to the Posiflex LD2000 Tool. To download the LD2000 Tool and its manual, go to the Posiflex' global website: <http://www.posiflex.com/en-global/Download/download>.

Installing a Networking Module (Optional)

Networking Module Slot

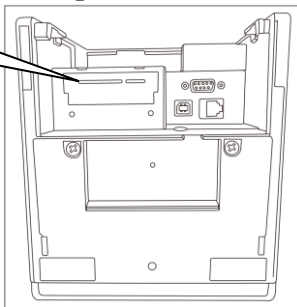

It is easy to install a networking module in the POS printer. Just refer to the following step-by-step instructions on installation of the module.

1. Loosen and remove the screw from the I/O board bracket of the printer.

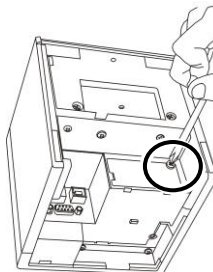

2. Remove the I/O board bracket from the printer.

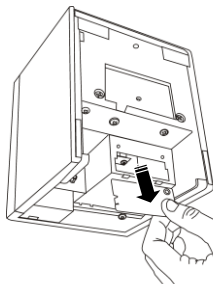

3. Glide the networking module along the track of the I/O bracket and then insert the module into the networking module slot of the printer.

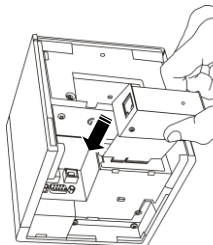



When the networking module is inserted into the networking module slot of the printer, the printer will automatically detect the inserted module and the networking interface is enabled. To set up the networking module, firstly connect the POS printer with a USB cable to your POS terminal and then set up the module by using the **Posiflex LAN Wi-Fi Printer Manager**. When completing in setting up the networking module, pull the USB cable out of the USB port of the printer and reboot the printer.

Be aware that if you want to re-set up the printer, connect the POS printer with a USB cable to your POS terminal again and then set up the module by using the **Posiflex LAN Wi-Fi Printer Manager**. When completing in setting up the networking module, pull the USB cable out of the USB port of the printer and reboot the printer.

4. Securely fix the networking module with 2 screws by using a screwdriver.

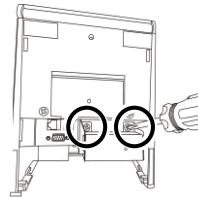

Installing the Posiflex LAN Wi-Fi Printer Manager (Optional)

After you install the networking module in the POS printer, to allow you to easily do settings of the LAN or Wi-Fi printer, please install the Posiflex LAN Wi-Fi Printer Manager. To download the **Posiflex LAN Wi-Fi Printer Manager**, go to the Posiflex' global website: <http://www.posiflex.com/en-global/Download/download> to download the up-to-date utility.

However, to avoid users doing settings by mistake, it is suggested that professional technicians implement the setup. To do more advanced settings on the printer, contact directly the Posiflex' technical service team.

Installing the USB Virtual COM Port Driver

If you use software programs that communicate with your POS terminal via a serial interface (e.g. COM1...COM8), but your POS system does not have any serial port, you will require a so-called virtual COM port driver. This virtual COM port driver allows you to assign a virtual COM port connection number to your POS terminal connected via a USB port and enables bidirectional communication between your POS terminal and the printer.

To download the USB Virtual COM Port Driver, go to the Posiflex' global website: <http://www.posiflex.com/en-global/Download/download> to download the up-to-date driver of the POS printer.

After downloading the driver, start to install them. When you finish installing the driver, it is suggested to turn on your POS terminal again. The system will automatically detect the POS printer.

Powering ON the PP-7600 Printer

1. Press the power button of the printer.
2. The power LED indicator stays bright and solid green when the printer is powered ON.

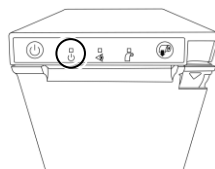
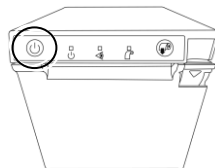

Status LED Indicators

After powering ON the printer, you can read the printer operation status from the power LED indicator on the printer. The LED status is described below.

LED	Status	Description
Power LED	Solid green	Printer powered on
Error LED	Flash red + several beeps	Cutter abnormal
	Solid red	Cover open
	Flash red	Operation temp. high
Paper-out LED	Solid red + continual beep	Paper out

Cleaning

➤ Cleaning the Printer Case

Before cleaning the printer case, be sure to power off the printer, and wipe the dirt off the printer case with a soft wiping cloth we provide.



Do NOT clean the product with alcohol, benzene, thinner, or other such solvents. Doing so may damage or break the parts made of plastic and rubber.

➤ Cleaning the Thermal Head and the Platen Roller

We recommend cleaning the thermal head to maintain receipt print quality. We also recommend cleaning periodically (about once every 3 months).

Depending on the paper roll used, paper dust may stick to the platen roller and the paper may not be fed correctly. To remove the paper dust, clean the platen roller with a cotton swab moistened with water. Power on the printer only after the water has completely dried.



 After printing, the thermal head and its surroundings can be very hot. Be careful. Let it be cool before you clean it.

 Do not damage the thermal head with your fingers or any other hard object.

Troubleshooting

➤ The printer cannot print

If you cannot print even though an error has not occurred, perform a self-test to check if printing is possible.

Follow the steps below.

1. Close the paper cover.
2. While pressing the feed button, power on the printer. (Hold down the feed button until printing starts.) The current print status is printed.
3. Briefly press the feed button (less than one second) to continue the self-test. The printer prints using the built-in character set. After the self-test printing, the printer is reset and switches to standard mode.

➤ LED Indicators are On/Flashing/Off

No lights is given by the LED indicators

Check whether the power supply cable is correctly connected to the printer and the socket.

Error LED is on

- ✓ Check whether the paper cover is closed.
- ✓ Check if paper jam occurs or foreign substance enters the paper cutter.
- ✓ The thermal head and its surroundings can be very hot. Printing stops if the thermal head is too hot. Printing starts again automatically when the thermal head temperature falls.

Paper-out LED indicator is on

- ✓ Check whether the paper roll is correctly installed and any paper roll remains.

Error LED indicator is flashing

Power off the printer; after 10 seconds, power it back on. If the error LED indicator turns on again even after turning the power back on, malfunction may occur. Contact your dealer or Posiflex' technical service team.

Specifications

General	
Printer Reliability	100 Km print length
Auto Cutter Reliability	700,000 cuts or more
NV Bit Image Memory	12KB (max.)
NV Graphics	384KB (max.)
Receive Buffer	6KB
Printer Driver	Windows Printer Driver, OPOS, JavaPOS (Win), JavaPOS (Linux), Virtual COM Driver, CUPS Driver (Linux)
Software	Printer Utility (Android), Software Switch Utility (Windows Desktop), LAN WIFI Manager
LED Indicators	Green LED – On = Power Red LED - Error and/or Paper Out
Sensors	Cover Open Out-of-paper Paper Near End
Cash Drawer Port (D.K port)	2 drivers (D.K port x1)
Power Consumption	Approx. 1.5A (mean)
Power Source	AC adapter (24V DC)
Power Saving	Yes
Temperature	Print quality assured: +5°C ~ +40°C Operating: 0°C ~ +40°C Non-operating: -20°C ~ +60°C
Relative Humidity	Operating: 20 ~ 85%, non-condensing 35% above for auto cutter Non-operating: 5% ~ 90%, non-condensing (paper excluded)
Acoustic Noise Level	55db
Standards and Approvals	EMI FCC Class A, CAN ICES-3(A)/NMB-3(A) Safety Standard UL60950-1/CSA C22.2 No60950-1
Dimensions(W x D x H)	5.08" x 5.86" x 5.1" / 129 x 148.8 x 129.5 mm
Weight	1kg
Color	Black / White
Print	
Print Method	Thermal dot line printing
Print Speed	200 mm/second (max)
Print Resolution	576 dots/line (W 8 dots/mm x H 8 dots/mm)
Print Direction	Vertical and Horizontal
Print Fonts	
Fonts/Column capacity	Font A: 12 x 24 48 cpl (default); Font B: 10 x24 57 cpl

Character Size	Font A: 1.25 x 3.00 mm; Font B: 1.13 x 3.00 mm
Character Set	95 Alphanumeric, 18 International, 128 x 43 Graphic
Barcode	UPC-A, UPC-E, JAN13 / EAN13, Code39, Code93, Code128, ITF, CODABAR(NW-&), GS1 DataBar
2D Symbol Printing	PDF417, QR code, Two Dimensional GS1 DataBar
Media Handling	
Paper Type	Thermal paper
Paper Feed Method	Friction feed
Print Width	72 mm
Paper Width	80 or 58 +/-1 mm
Paper Loading	Drop-in
Roll Diameter (Max)	80 mm
Core Diameter (Min)	φ 8 mm
Paper Thickness	60 ~ 80 um
Paper Guide	Yes
Auto Cutter	Yes
Connectivity	
Serial Interface	RS-232
USB Interface	Built-in USB
Ethernet Interface (optional)	Ethernet 10/100Base-T/TX
Wi-Fi Interface (optional)	802.11 a/b/g/n (2.4/5GHz)
Wireless Security Mode	WEP, WPA, WPA2-Personal/Enterprise
Operating System	
OS support	Android / Windows / Linux

※ The product information and specifications are subject to change without prior notice. To get the detailed information on PP-7600/7600K, please check this model from Posiflex Global Website (<http://www.posiflex.com/en-global/Download/download>).

<MEMO>

<MEMO>

<MEMO>