



P/N: 15G065182000AK V1.0

Quick Installation Guide
1U4LW-X570/2L2T



SATA Cable Connections

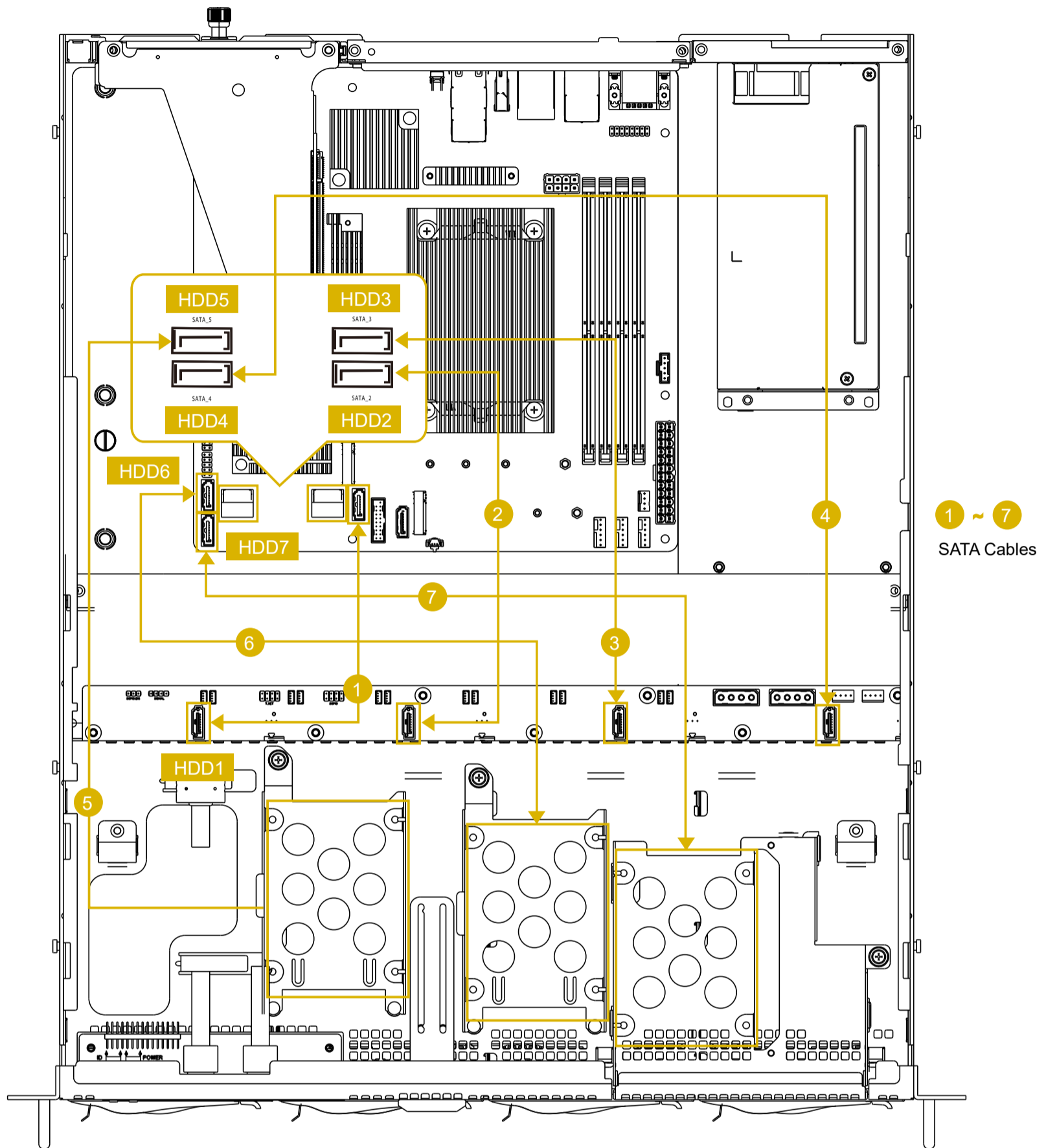



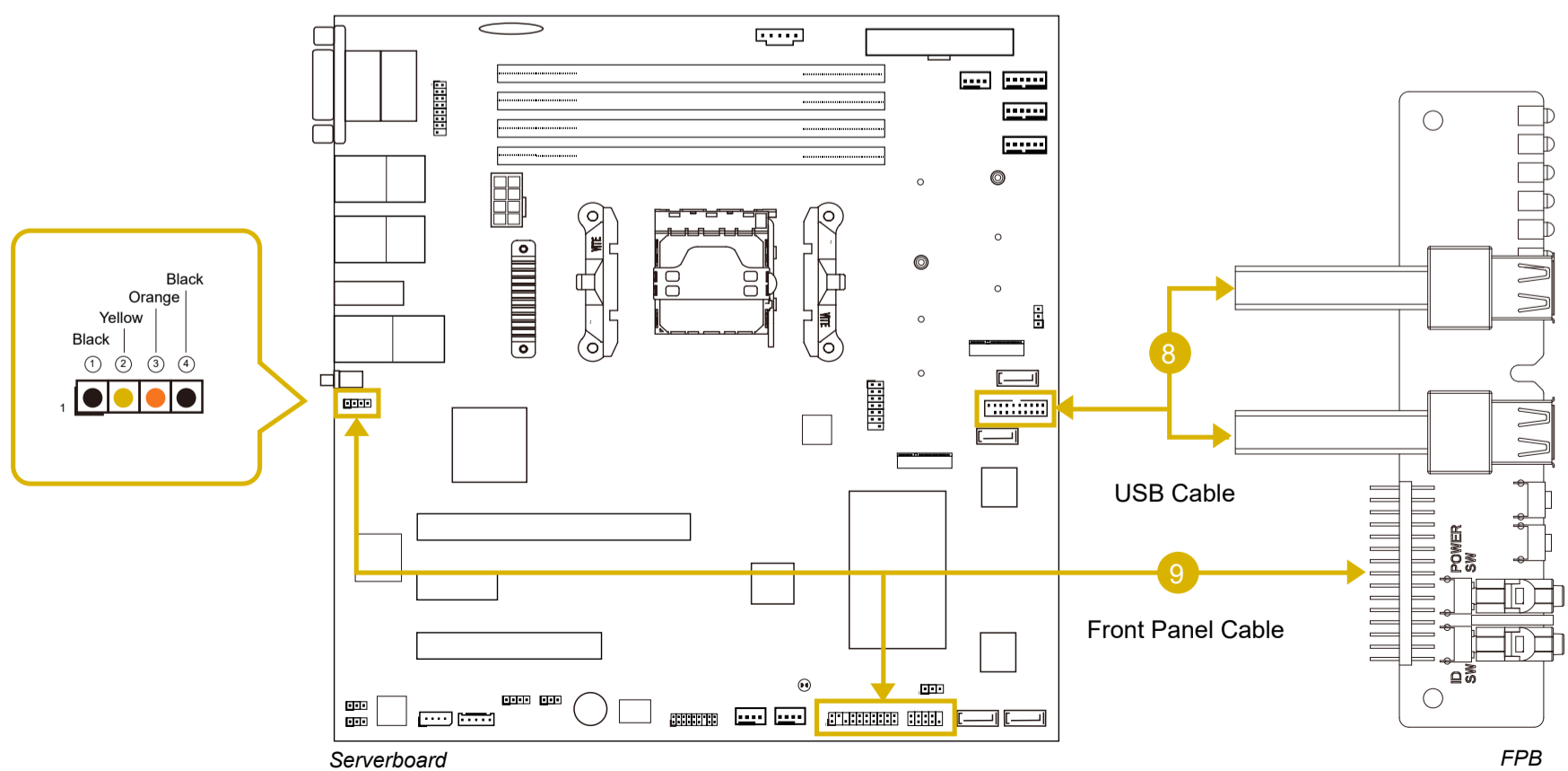

Front Panel Cable & USB Cable Connections

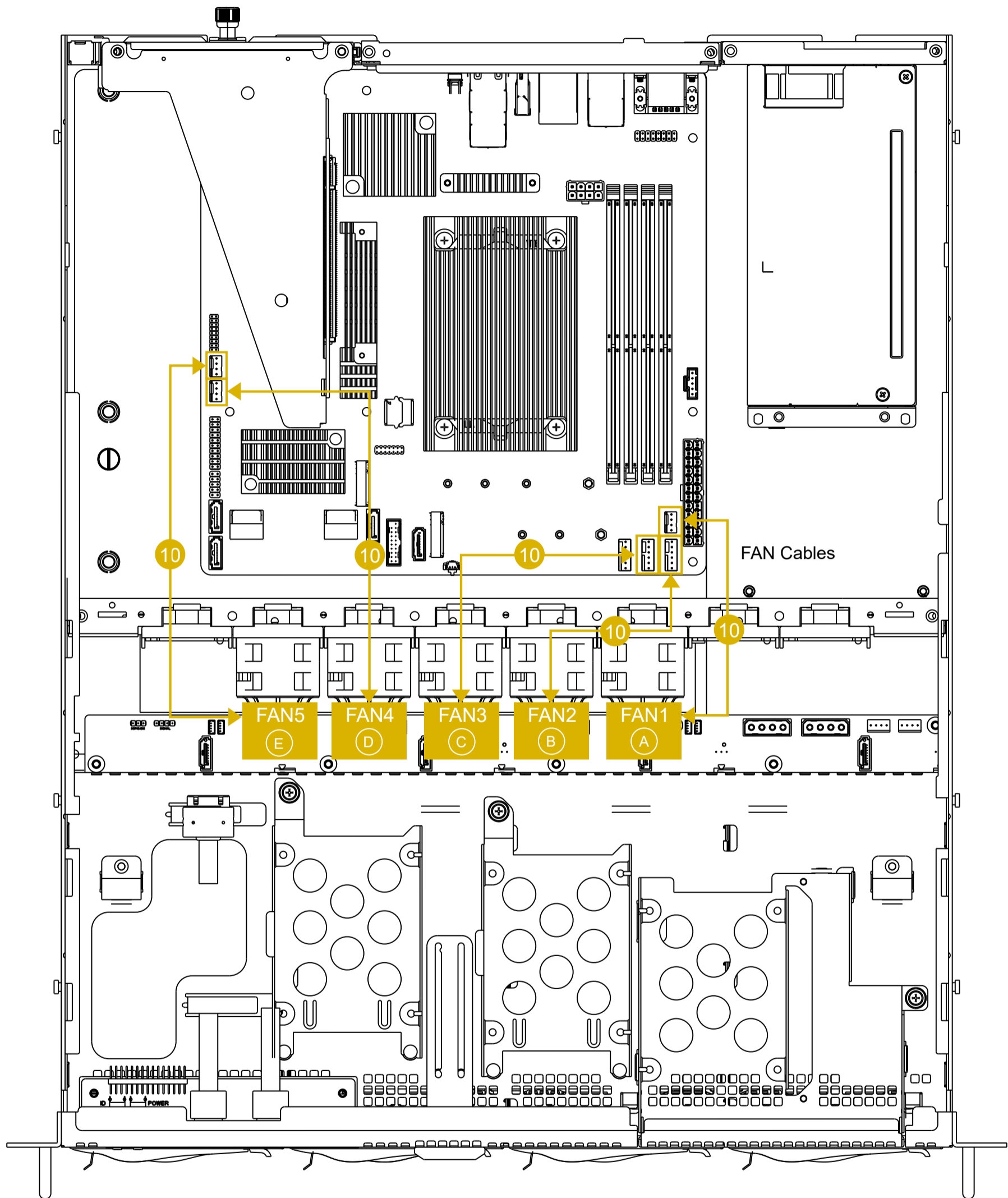

Fan Cable Connections



FAN Name				
Item	Chassis	Motherboard	BMC Web	BIOS HW Monitor
(A)	FAN1	 4-pin FAN3	FAN3	FAN3
(B)	FAN2	 6-pin FAN4	FAN4	FAN4
(C)	FAN3	 6-pin FAN5	FAN5	FAN5
(D)	FAN4	 4-pin FAN1	FAN1	FAN1
(E)	FAN5	 4-pin FAN2	FAN2	FAN2