

Jabra GN

USER MANUAL



PANACAST 50 VBS

Technology for life's new rhythm

© 2024 GN Audio A/S. All rights reserved. Jabra® is a trademark of GN Audio A/S. The Bluetooth® word mark and logos are registered trademarks owned by the Bluetooth SIG, Inc. and any use of such marks by GN Audio A/S is under license.

Made in China

MODEL: VSM040; VTD040



Declaration of Conformity can be found on www.jabra.com/doc

1. Welcome.....	5	6.4 Single-stream Dynamic Composition	
2. Overview.....	6	6.5 Smart Gallery - Multi-stream - only for Zoom Rooms	
2.1 Jabra PanaCast 50 VBS bar overview		6.6 Field of view	
2.2 Jabra PanaCast Control overview		6.7 Pan, Tilt, Zoom presets - available for Zoom Rooms	
2.3 Included accessories - Jabra PanaCast 50 VBS bar		6.8 Image quality settings	
2.4 Included accessories - Jabra PanaCast Control		6.9 Video flicker	
2.5 Optional accessories		6.10 Enhanced Noise Suppression	
3. Hardware setup overview	13	6.11 Intelligent Meeting Space	
4. Visual indicators.....	15	7. Bring Your Own Device (BYOD) mode.....	26
5. Settings management.....	16	8. Share content	28
6. Video settings.....	18	8.1 Wireless content sharing	
6.1 Intelligent Zoom		8.2 Wired content sharing	
6.2 Virtual Director		9. Privacy cover.....	30
6.3 Panoramic View		10. Safety capacity settings.....	31

11.Hearing augmentation with Assistive Listening Devices.....	32
12.Update firmware.....	33
13.Restart devices.....	35
14.Factory reset	38
15.Languages.....	42
16.Support.....	43
16.1FAQ and technical specifications	
16.2How to care for your Jabra device	

1. Welcome

Thank you for using the Jabra PanaCast 50 VBS. We hope you will enjoy it!

Here are some key features you will benefit from by using the Jabra PanaCast 50 VBS:

- World-class audio with full duplex and powerful stereo speakers
- Unique 180° full room coverage in high-definition Panoramic-4K for a more natural view of the meeting room
- Access to an easier meeting experience with the touchscreen-activated PanaCast Control
- Certified for the strict requirements of Microsoft Teams Rooms and Zoom Rooms to connect, share, and collaborate seamlessly and securely
- On-device AI that powers a range of intelligent features for immersive and natural virtual collaboration

2. Overview

2.1 Jabra PanaCast 50 VBS bar overview

FRONT SIDE

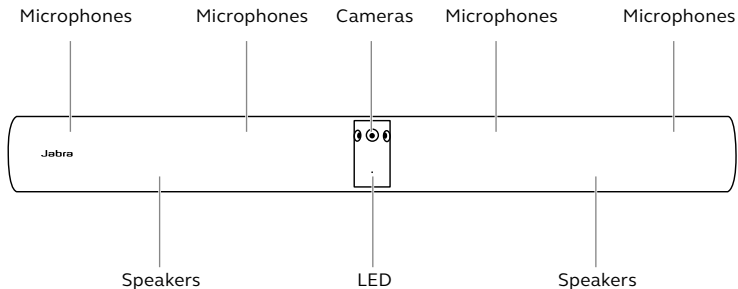

SECURITY NOTE: microphones and cameras can be used to record private conversations and footage.

BACK SIDE

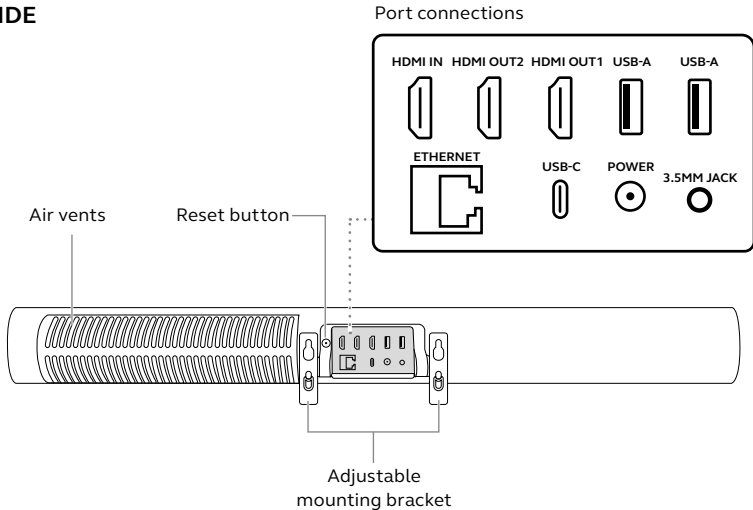

Security note: Bluetooth, Ethernet or Wi-Fi connections can potentially be used to transfer data to unauthorized devices.

2.2 Jabra PanaCast Control overview

FRONT SIDE

10-inch LCD
touch screen

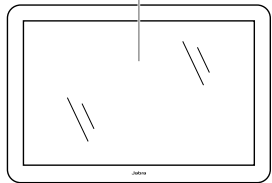

Proximity sensor

BACK SIDE

Ultrasonic sound
proximity detector

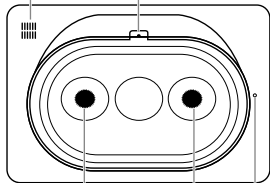

Manual tightening
screws

Ethernet port (PoE)

USB-C port

Port connections
(remove cover for
access)

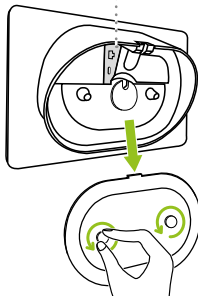
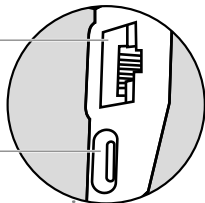

SECURITY NOTE: sensors can potentially be used to detect the presence of a user.

2.3 Included accessories - Jabra PanaCast 50 VBS bar

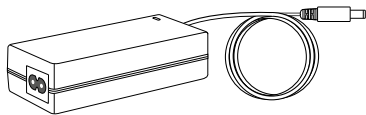

AC power adapter (1.83m/6ft)

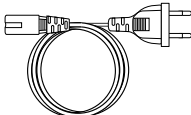

AC power cable
(1m/3.28ft)

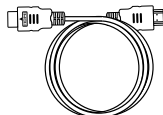

HDMI cable
(1.83m/6ft)

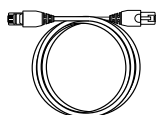

RJ45 Ethernet cable
(4.57m/15ft)

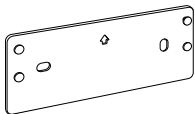

Wall mount



Camera privacy cover

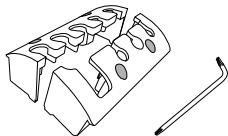

Cable compartment cover (2 pcs)
with embedded screws
& screwdriver

Additional accessories can be purchased at jabra.com/accessories

2.4 Included accessories - Jabra PanaCast Control

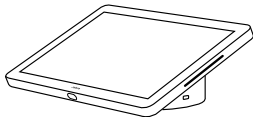

Jabra PanaCast Control

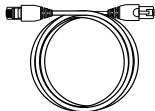

RJ45 Ethernet cable
(4.57m/15ft)

POWER OVER ETHERNET (PoE) KIT

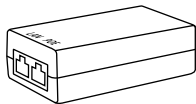

PoE injector

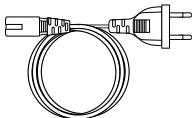

AC power cable
(1m/3.28ft)



RJ45 Ethernet cable
(4.57m/15ft)

Additional accessories can be purchased at jabra.com/accessories

2.5 Optional accessories

Accessories can be purchased at [jabra.com/accessories](https://www.jabra.com/accessories)

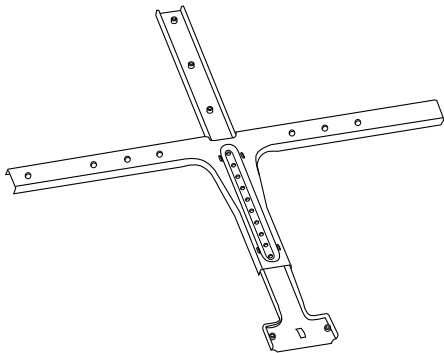

Screen mount

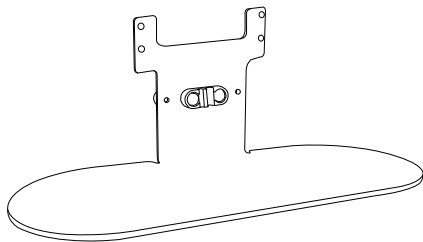
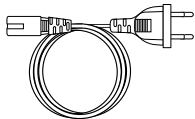
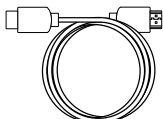

Table stand

Accessories can be purchased at jabra.com/accessories



**Regional power
cords**(1m/3.28ft)



HDMI cable
(1.83m/6ft)

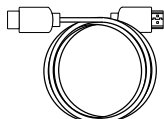

**HDMI ingest
cable**
(4.57m/15ft)

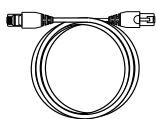

**RJ45 Ethernet
cable**
(4.57m/15ft)



USB-A to C cable
(4.57m/15ft)



USB-A to B cable
(1.83m/6ft)



**Jabra PanaCast Control
table mount**

3. Hardware setup overview

This is an overview of the steps required to set up the Jabra PanaCast 50 VBS.

1. Mount the video bar.

Refer to the assembly videos or assembly instructions available in jabra.com/help/panacast50vbs/getstarted

2. Connect the cables.

Refer to the cabling instructions available in the Installation manual.

3. Set up the touch controller.

After the device powers on, follow the setup wizard displayed on the touch controller. During the last step of the configuration, it is necessary to log into the video conferencing account of your service provider.

4. Manage settings and devices locally using the touch controller or remotely using the Web Console or Jabra Plus Management.

To manage settings and devices using the touch controller, go to the **More**

menu in the video conferencing app, select **Settings** and then **Device settings**. The Jabra PanaCast 50 VBS settings screen will be displayed. Go to the **Admin** menu and log in as an administrator. If this is the first login, the default username is **admin** and the password is the **last 6 digits of the touch controller serial number**. After the first login, you must change the password.

To manage settings and devices using the Web Console, enter the IP address of the video bar or the touch controller in a browser. If this is the first time accessing the Web Console, the default username is **admin** and the password is the **last 6 digits of the serial number of the device used to access the Web Console**. After the first login, you must change the password.

To manage settings and devices using Jabra Plus Management, log in with your Jabra Plus account. Go to the **Meeting rooms > Room inventory** menu, select the corresponding meeting room and Jabra PanaCast 50 VBS.

To access the Jabra PanaCast 50 VBS manuals, assembly videos and instructions, go to jabra.com/support or jabra.com/help/panacast50vbs/getstarted

For more information on Jabra Plus Management, go to jabra.com/support

4. Visual indicators

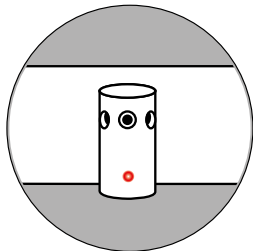
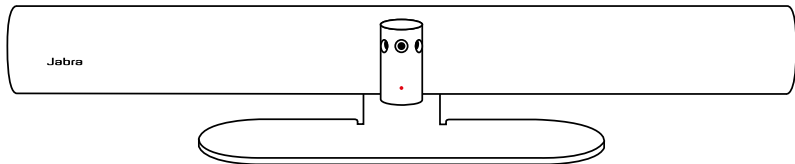

LED STATUS

Off or not streaming	(LED off)
Starting up	○ (flashing white)
Connected	○ (on for 3 seconds)
In call or streaming video/media	○
In call, audio muted	●
Firmware updating	● (flashing pink)

5. Settings management

After the Jabra PanaCast 50 VBS configuration process is completed, the touch controller will display the video conferencing app of your service provider.

To access the Jabra PanaCast 50 VBS settings, go to the **More** menu in the video conferencing app, select **Settings** and then **Device settings**.

Basic settings and **general information** of the touch controller will be displayed.

Advanced settings are available when logging in as an administrator. If this is the first login, the default username is **admin** and the password is the **last 6 digits of the touch controller serial number**. After the first login, you must change the password.

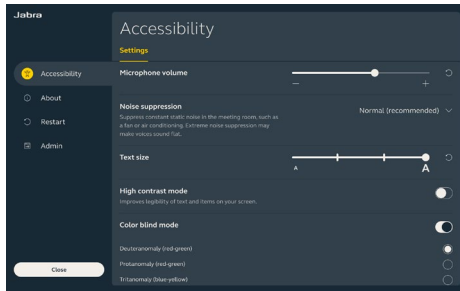

All Jabra PanaCast 50 VBS settings can be configured using the Web Console or Jabra Plus Management.

To access the Web Console, enter the IP address of the video bar or touch controller in a browser. The IP address is displayed on the installation screen during the configuration process of the Jabra PanaCast 50 VBS. The IP address is also available in the **About** section of the **Device settings** menu on the touch controller.

If this is the first time accessing the Web Console, the default username is **admin** and the password is the **last 6 digits of the serial number of the device used to access the Web Console**. After the first login, you must change the password.

To access Jabra Plus Management, log in using your Jabra Plus account. Go to the **Meetingrooms > Roominventory** menu, select your organization and corresponding meeting room. Select the provisioned Jabra PanaCast 50 VBS to access its settings.

For more information on Jabra Plus Management, go to jabra.com/support

6. Video settings

Administrators can remotely configure the video conferencing settings using the Web Console, Jabra Plus Management or directly in the touch controller.

To access the video conferencing settings using the touch controller, go to the **More** menu in the video conferencing app, select **Settings** and then **Device settings**. The Jabra PanaCast 50 VBS settings screen will be displayed. Go to the **Admin** menu and log in as an administrator.

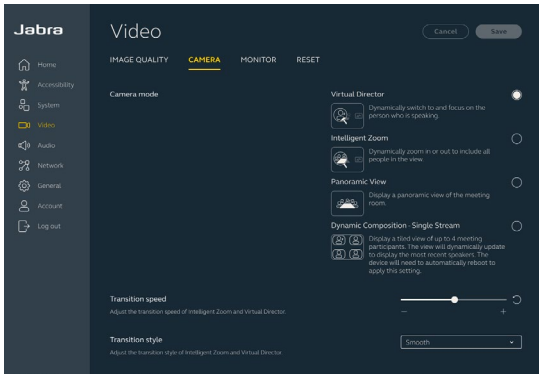

To access the video conferencing settings using the Web Console, enter the IP address of the video bar or touch controller in a browser. The IP address is displayed on the installation screen during the configuration process of the Jabra PanaCast 50 VBS. The IP address is also available in the **About** section of the **Device settings** menu on the touch controller.

To access Jabra Plus Management, log in using your Jabra Plus account. Go to the **Meeting room > Room inventory** menu, select your organization and corresponding meeting room. Select the provisioned Jabra PanaCast 50 VBS to access the video settings.

6.1 Intelligent Zoom

Intelligent Zoom is a camera mode that dynamically frames all visible people in the meeting room.

Only one camera mode can be active at a time. By default, camera mode is set to Intelligent Zoom.

6.2 Virtual Director

Virtual Director is a camera mode that dynamically switches to and focuses on the person who is speaking.

6.3 Panoramic View

Panoramic View is a camera mode that displays a panoramic view of the meeting room.

6.4 Single-stream Dynamic Composition

Single-stream Dynamic Composition is an advanced camera mode that displays a tiled view of up to four speakers and a full room view. The tiled view will dynamically update to display the participants who are actively speaking.



6.5 Smart Gallery - Multi-stream - only for Zoom Rooms

The Jabra PanaCast 50 VBS creates individual streams of in-room participants, as well as full room view, so each in-room participant gets their own stream in a Zoom meeting. The tiled view will dynamically update to highlight the participant who is actively speaking.

To select this video mode, go to **Zoom Room** settings and select **Multi-Stream** option.

To hide the panoramic view and only display the individual video streams, go to **Zoom Room** settings and select **Hide Room View**.

6.6 Field of view

The angle of the camera is set to a 180° view of the meeting room.

6.7 Pan, Tilt, Zoom presets - available for Zoom Rooms

Pan, Tilt, Zoom presets allow users to adjust and save the camera view using the touch controller. Saved presets do not overwrite the default Pan, Tilt, Zoom settings. Users can select saved presets when a new meeting starts. Pan, Tilt, Zoom controls are only available when using panoramic view mode.

6.8 Image quality settings

The image brightness, contrast, saturation, sharpness, and white balance can be adjusted in the Web Console or using the touch controller through the admin device settings.

Additionally, Vivid HDR and Automatic white balance can be enabled. If Vivid HDR is enabled, contrast, saturation, and sharpness cannot be adjusted manually. If Automatic white balance is enabled, the white balance cannot be adjusted manually. To manually adjust the white balance, automatic white balance must be disabled.

6.9 Video flicker

Video flicker can occur if the Jabra PanaCast 50 VBS is not set to the correct geographical region. If you encounter video flicker, select Auto (50Hz/60Hz) for regions that support NTSC format, or 50Hz for regions that support PAL format.

By default, **Video flicker** is set to Auto.

6.10 Enhanced Noise Suppression

The Jabra PanaCast 50 VBS provides noise suppression which addresses noise, echo cancellation and suppresses constant static noise, such as a fan or air conditioning.

Based on the meeting room conditions, you can select Extreme Noise Suppression to suppress all background noise. Extreme Noise suppression may make voices sound flat.

6.11 Intelligent Meeting Space

Define a customized boundary that can be applied to a meeting space. This will ensure that only people within this boundary will be considered as meeting room participants.

Intelligent Meeting Space is especially useful for meeting rooms that have glass walls.



7. Bring Your Own Device (BYOD) mode

BYOD mode allows hosting a meeting from a computer and not from the Jabra PanaCast 50 VBS. To enable BYOD mode, go to the **Admin** menu and log in as administrator. If this is the first login, the default username is admin and the password is the **last 6 digits of the serial number of the Jabra device**. After the first login, you must change the password.

Go to **System > Bring Your Own Device** and **Enable BYOD**. This allows meeting participants to start and exit BYOD mode from the Jabra device when required.

After enabling BYOD mode, it will be automatically available when connecting a personal computer to the video bar via USB-C. The camera, microphone and speakers from the video bar will be used during the meeting. To view the personal computer screen on the meeting room monitor, connect an HDMI cable between the video bar and the computer.

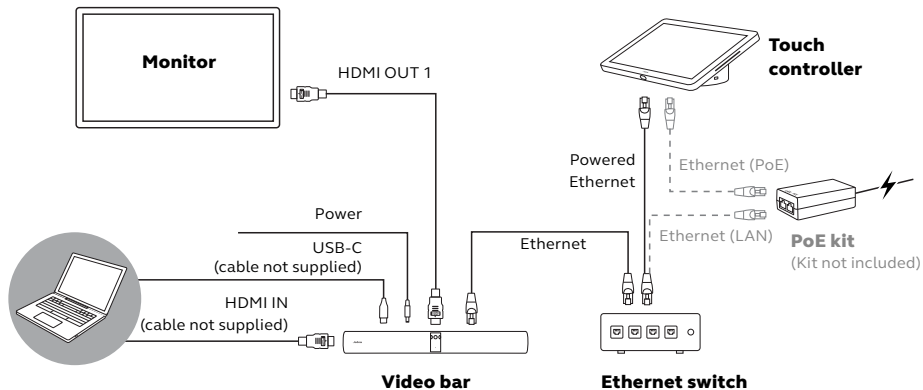

8. Share content

8.1 Wireless content sharing

The video bar and touch controller have Bluetooth® technology that allows users to share content directly from their computers or mobile devices.

When sharing content using a wireless signal, the **share content** feature must be enabled in the video conferencing app.

For more information on how to share content wirelessly, go to the support page of your video conferencing service provider.

8.2 Wired content sharing

Connect HDMI cable from the computer to the **HDMI IN** port on the back of the video bar. The content from the computer will be displayed in the meeting and on the room monitor connected to the video bar.

Additional HDMI cables are not supplied and can be purchased at jabra.com/accessories

9. Privacy cover

When the video bar is not in use, the privacy cover can be used to cover the lenses of the camera.

It is recommended not to use the privacy cover while the video bar is in a meeting as it may cause the image from the camera to flicker, which may be triggering for photosensitive individuals.

To stop the video feed during the meeting, users can use the in-meeting controls in the video conferencing application.

10.Safety capacity settings

The Jabra PanaCast 50 VBS works together with the video conferencing app to monitor the safety capacity limit of a meeting room.

These settings are configured and managed directly in the admin portal of your video conferencing service provider.

11. Hearing augmentation with Assistive Listening Devices

The Jabra PanaCast 50 VBS aux-out feature allows the connection of Assistive Listening Devices to improve accessibility in meeting rooms for people with hearing loss. Audio volume and mute apply to the video bar speakers and aux-out audio.

To enable this setting, go to the **Audio** menu and turn on **AUX port**.

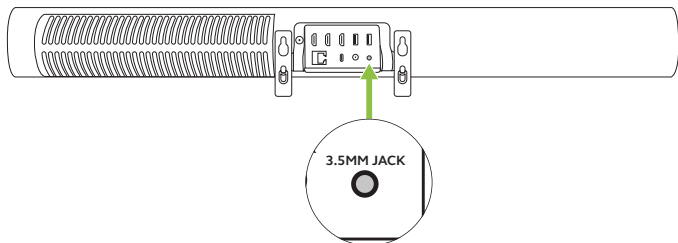

12. Update firmware

Firmware updates improve performance or add new functionality to Jabra devices. It is recommended to update your Jabra device to the latest firmware available before first use. Jabra PanaCast 50 VBS firmware updates can be done:

- Locally on the video bar (mouse or touch screen monitor required)
- Locally on the paired touch controller
- Remotely using the Web Console(s) for the video bar and touch controller
- Remotely using the admin portal of your video conferencing service provider
- Remotely using Jabra Plus Management

For local updates, access the **Device settings** menu on the touch controller or video bar, go to the **System** section and select **Update**.

For remote updates, access the Web Console of the video bar and touch controller individually. Enter the IP address of the video bar or touch controller in a browser. If this is the first time accessing the Web Console, the default username is **admin** and

the password is the **last 6 digits of the serial number of the device used to access the Web Console**. After the first login, you must change the password.

Firmware updates in Jabra Plus Management will follow the Firmware policy assigned to the meeting room configuration.

Go to the **Meeting rooms > Room configurations** menu and select **Firmware policy**.

13. Restart devices

You can restart the video bar and touch controller using one of the following options:

Touch Controller – go to the **Device settings** menu in your video conferencing app. Go to **General > System reset** and select **Restart connected devices**. The video bar and touch controller will be restarted.

Web Console – enter the IP address of the video bar or touch controller in the browser and go to **General > System reset** and select **Restart connected devices**.

Jabra Plus Management – log in using your Jabra Plus account. Go to **Meeting room > Room inventory**, select your organization and corresponding meeting room. Go the action menu on the Jabra PanaCast 50 VBS video bar or touch controller, and select **Reboot device**.

Admin portal of your video conferencing service provider.

Manual restart of the video bar

Press and hold the **Reset** button on the back of the video bar. Release the button after 5 seconds and a restarting message will be displayed on the monitor.

The video bar will restart and play an audio notification when ready for use. The reboot takes approximately 1 minute.

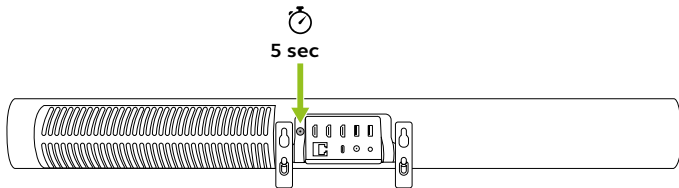

Manual restart of the touch controller

Use a paperclip to press and hold the **Pinhole reset** button on the back of the touch controller. Release the button after 5 seconds and a restarting message will be displayed on the monitor.

The touch controller will flash green and restart. The reboot takes approximately 1 minute.

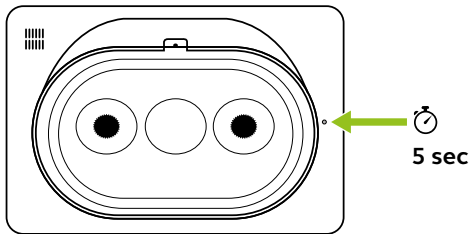

14. Factory reset

Factory reset will restore the touch controller and video bar to their factory default settings and it will be necessary to re-pair the devices.

You can factory reset the video bar and touch controller using one of the following options:

Touch Controller – go to **Device settings** in your video conferencing app. Log in as admin and go to **General > System reset** and select **Factory reset**. The video bar and touch controller will be reset.

Web Console – enter the IP address of the video bar or touch controller in the browser and go to **General > System reset** and select **Factory reset**.

Admin portal of your video conferencing service provider.

These are the recommended factory reset methods instead of manual factory resets of the video bar and the touch controller.

Manual factory reset of the video bar

Manual factory reset will restore the video bar to its factory default settings and it will be necessary to re-pair the video bar to the touch controller.

Press and hold the **Reset** button on the back of the video bar for 20 seconds until the LED flashes pink and the factory data reset message is displayed on the monitor.

The video bar will restart and play an audio notification when ready for use. The reboot takes approximately 1 minute.

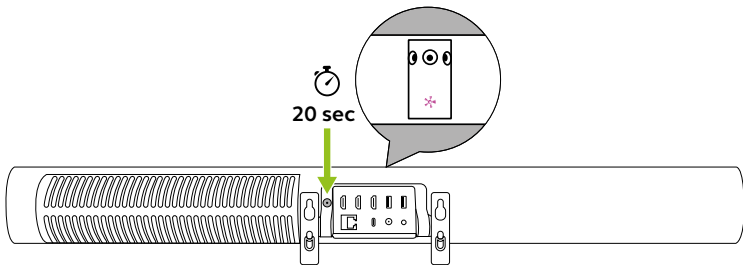

Manual factory reset of the touch controller

Manual factory reset will restore the touch controller to its factory default settings and it will be necessary to re-pair the touch controller to the video bar.

Use a paperclip to press and hold the Pinhole reset button on the back of the touch controller for 20 seconds until the factory data reset message is displayed on the screen.

The reboot takes approximately 1 minute.

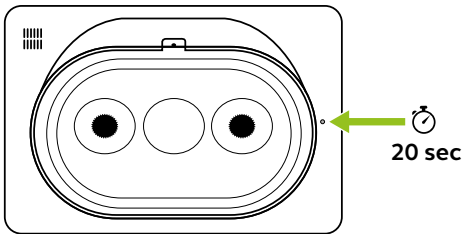

A security code can be configured to prevent users from manually factory resetting the Jabra devices. You can configure it using the Web Console or within the admin settings directly on the device.

Web Console - enter the IP address of the video bar or touch controller in the browser. Log in as an admin and go to **Account > Access**.

Touch controller - log in as an admin and go to **Account > Access**.

After manually starting the factory reset of the Jabra device, the security code must be entered to complete the factory reset.

15. Languages

The PanaCast 50 VBS is available in the following languages:

- | | | | |
|----------|------------|------------|-----------|
| -Chinese | -Finnish | -Norwegian | -Turkish |
| -Czech | -French | -Polish | -Japanese |
| -Danish | -German | -Russian | -Korean |
| -Dutch | -Hungarian | -Spanish | |
| -English | -Italian | -Swedish | |

16.Support

16.1 FAQ and technical specifications

View the FAQ, certifications, and technical specifications at jabra.com/help/panacast50vbs

16.2 How to care for your Jabra device

The Jabra PanaCast 50 VBS is for indoor use only.

- Avoid direct sunlight and temperatures above 40°C/104°F or below 0°C/32°F.
- Do not expose the camera or cables to rain or other liquids.
- Do not position the devices near the vents of a monitor or TV as this may cause the devices to overheat and malfunction.
- Clean the surface with a cloth dampened with a mild soap solution.

To learn more about the Jabra PanaCast 50 VBS,
go to jabra.com/help/panacast50vbs/getstarted