





# Product Guide

## HP LaserJet Pro MFP 4200 series

Colourful productivity. Seamless management.



# Key selling points

	Maximum productivity in full colour	Compact design with groundbreaking performance <sup>1,2,8</sup>
	Seamless management	Robust tools to set up and manage your printers <sup>3,4</sup>
	HP Wolf Pro Security	Advance your security with HP Wolf Pro
	Instant Ink	Save on toner and never run out with Instant Ink <sup>10,11,12,13</sup>
	Sustainable printing	Save energy with auto technology and efficiency <sup>5,6,7</sup>





# Maximum productivity in full colour

Compact design with groundbreaking performance. High-speed, double-sided colour printing at up to 35 ppm and self-healing Wi-Fi®.<sup>1,2,8</sup>



## Shortcuts to keep your teams moving fast



Step up your workflow with lightning fast speed to meet high-demand environments.<sup>1</sup>



Do more in fewer steps. Simple shortcuts enable your employees to complete everyday tasks with just the touch of a button.



Support your business work team with this compact, high-performing colour printer, ideal for up to 10 users.



Avoid interruptions with Wi-Fi<sup>®8</sup> that intelligently looks for the best connection to stay online.<sup>8</sup>

## Ultimate productivity with MFP features.



Scan both sides with a single pass. Dual-sided scanning enables your MFP users to get more done in less time.



No PC or driver required.

## Expand your capacity



Tailor this printer to the needs of your business with an optional 550-sheet paper tray and spend less time loading paper with a 900-sheet maximum input capacity.



# Seamless management

Manage your printers with the powerful Web Jetadmin and take advantage of robust management tools to set up your printers, onboard users, track toner levels, manage security and much more.<sup>3,4</sup>



## HP Web Jetadmin

Centralise your print fleet management. HP Web Jetadmin easily adds and updates devices, solutions and policies.<sup>4</sup>



## Simple set-up

Set up your printer fleet quickly wherever work happens. Cloud connectivity makes it easy for your IT team.<sup>3</sup>



# HP Wolf Pro Security

Advance your security with the legendary HP Wolf Pro Security, instantly embedded and preconfigured from the start.



HP WOLF SECURITY



## Immediately ready

Get instant printer fleet security. Preconfigured settings mean it is ready when you are.



## Smart Admin

Set up your printer fleet security from the dashboard. Smart Admin makes IT configuration and monitoring easy.<sup>3</sup>



## Optional PIN/pull printing

Add a layer of security. PIN/pull option authenticates your print jobs only when you are present.



## Optional HP Security Manager

Strengthen and simplify compliance. This upgrade applies your business policies across the fleet.<sup>9</sup>

For more information

- HP Wolf Pro, visit:  
<https://www.hp.com/gb-en/security/solutions.html>

- HP JetAdvantage Security Manager, visit:  
[www.hp.com/go/securitymanager](http://www.hp.com/go/securitymanager)

# Hassle-free supplies management with Instant Ink

Save on toner and never run out when you sign up to Instant Ink for laser – an automatic toner subscription that delivers toner only when you need it so you can focus on running your business. Get flexible plans so that you can change or cancel any time.<sup>10,11,12,13</sup>



Never run out of toner with Instant Ink for laser.<sup>12</sup>



With Instant Ink, get toner automatically delivered to remote workers or distributed in offices –all on one consolidated bill.<sup>11</sup>



With Instant Ink's flexible monthly plans, you get to select the right plan for each printer. Change or cancel at any time.<sup>13</sup>



Partner with HP to help reduce environmental impact. Send us your used Original HP cartridges with prepaid postage labels and we will recycle them for you.<sup>7</sup>



# Sustainable printing

Designed with the environment in mind, HP LaserJet Pro printers meet the industry standards for energy efficiency, so you can achieve more while using less.<sup>5,6,7</sup>



## TerraJet sustainability

Redesigned Original HP TerraJet Cartridge for reduced plastic use and energy consumption when printing.<sup>14,15</sup>



## Auto duplex

Reduce your paper use. Default duplex setting prints on both sides of each page.



## Energy Star® certified

Meet the industry standard for efficiency with an Energy Star® rating.<sup>5</sup>



## HP Auto-On/Auto-Off

Reduce your footprint. HP Auto-On/Auto-Off<sup>6</sup> technology optimises printer energy usage and costs.



## HP Planet Partners

We take recycling<sup>7</sup> full circle. Our ink cartridges reuse plastic and can be returned after use.

# LaserJet Pro MFP 4203fdw

## The product in detail

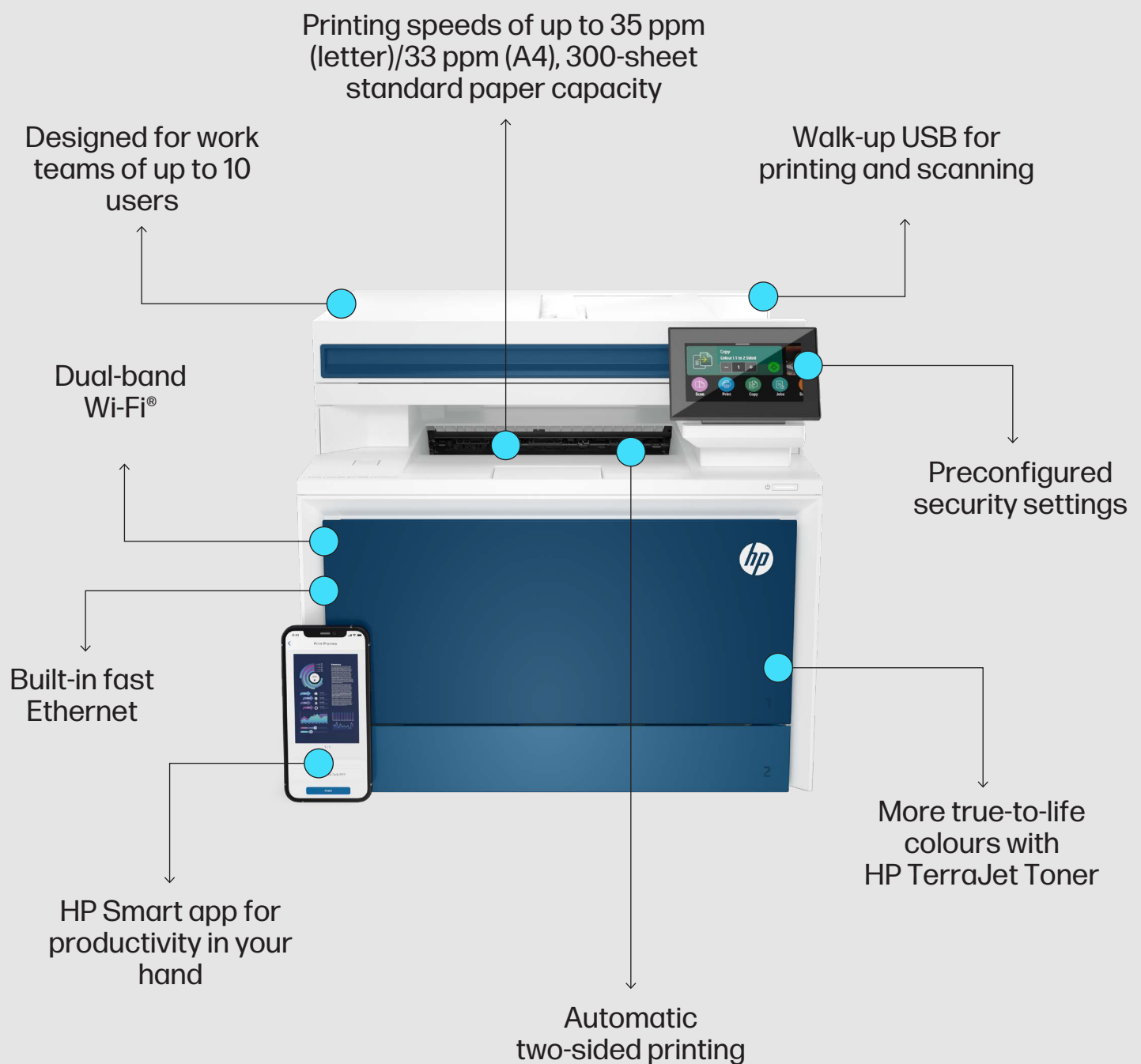



# LaserJet Pro MFP 4200

## Series line-up



	HP Colour LaserJet Pro MFP 4203dw	HP Colour LaserJet Pro MFP 4203dn
Best for	Small thriving businesses that want want fast colour printing and scanning for maximum productivity.	
Functions	Print, scan, copy. Automatic two-sided printing. 50-page Automatic Document Feeder.	Print, scan, copy. Automatic two-sided printing. 50-page Automatic Document Feeder.
Connectivity	Dual-band Wi-Fi®, Bluetooth®, Wi-Fi® Direct and Ethernet	Ethernet
Productivity	Printing speeds of up to 35 ppm (letter)/33 ppm (A4), 300-sheet standard paper capacity	
User interface	Twist and click speed dial with four-line LCD	
User volume	3-10 people printing up to 4,000 pages per month	

# HP LaserJet Pro MFP 4200 series

## HP 210/220/230\* A/X Black Original LaserJet Toner Cartridges with JetIntelligence



Produce high-quality business documents with crisp black text and professional-quality graphics.



Sustainable cartridge design

Redesigned Original HP TerraJet Cartridge for reduced plastic use and energy consumption when printing.<sup>5,6</sup>



Innovative toner design

Next-generation, high-performance HP Toner.



Security you can trust

Secured cartridges for a more protected ecosystem.



Specially formulated, low-melt HP TerraJet Toner is designed for low energy use. It uses an average of 28% less energy than the previous generation of HP cartridges.



Optional high-yield cartridges save money and time, delivering more than three times as many pages compared to standard cartridges.



# Legal disclaimers

1. Measured using ISO/IEC 24734 and excludes first set of test documents. For more information, visit: [hp.com/go/printerclaims](https://hp.com/go/printerclaims). Exact speed varies depending on the system configuration, software application, driver and document complexity.
2. Requires the HP Smart app to be downloaded. For details on local printing requirements, see [www.hp.com/go/mobileprinting](https://www.hp.com/go/mobileprinting). Certain software/features are only available in English and may differ between desktop and mobile applications. Subscription may be required; Subscription may not be available in all countries. Visit [www.hpsmart.com](https://www.hpsmart.com) for more details. Internet access required and must be purchased separately. HP account required for full functionality. List of supported operating systems available in app stores. Fax capabilities are only for sending faxes. After two years, a monthly fee will apply for continued access to advanced features with HP Smart Advance. HP Smart Advance is not available in all countries. Visit [www.hpsmart.com](https://www.hpsmart.com) for more information.
3. Easy set-up and management - requires use of Smart Admin Dashboard for printer set-up and onboarding of users.
4. HP Web Jetadmin is available for download at no additional charge at [www.hp.com/go/webjetadmin](https://www.hp.com/go/webjetadmin).
5. HP calculations based on ENERGY STAR® normalised TEC data comparing HP LaserJet 200-500 series printers at launch. Visit [www.hp.com/ecosmart](https://www.hp.com/ecosmart).
6. HP Auto-On/Auto-Off technology capabilities subject to printer and settings; a firmware upgrade may be required.
7. Recycling: programme availability varies. Original HP cartridge return and recycling is currently available in more than 60 countries, territories and regions in Asia, Africa, Europe and North and South America through the HP Planet Partners programme. For details, visit: [www.hp.com/recycle](https://www.hp.com/recycle).
8. Wireless operations are compatible with 2.4 GHz and 5.0 GHz operations only. Learn more at [www.hp.com/go/mobileprinting](https://www.hp.com/go/mobileprinting). Wi-Fi is a registered trademark of Wi-Fi Alliance®. Supports both 5.0 GHz and 2.4 GHz using up to 12 non-overlapping channels vs only three non-overlapping channels for 2.4 GHz only. Supports 5.0 GHz band (up to 150 mbps) vs 2.4 GHz band (up to 72.2 mbps). Internet access required and must be purchased separately.
9. HP JetAdvantage Security Manager must be purchased separately. To learn more, please visit: [www.hp.com/go/securitymanager](https://www.hp.com/go/securitymanager).
10. Save up to 50% on toner (mono) - based on the monthly subscription cost of HP Instant Ink monochrome toner service 1,500-page plan without purchase of additional sets of pages compared to cost per page to print ISO/IEC 24711 pages on most in-class, traditional A4 monochrome toner cartridge printers < USD 493 and < EUR 494 and MFPs priced < USD 649 and < EUR 672 using original standard-capacity integrated cartridges (toner and drum in one cartridge). Average CPP per country used to determine percentage savings claim versus CPP for HP Instant Ink. Sale prices not considered for this study. Printers that only use XL cartridges excluded due to non-standard hardware and supplies model. Keypoint Intelligence September 2021 study commissioned by HP, based on publicly available information as at 18 August 2021. Printers selected by market share in IDC Quarterly Hardcopy Peripherals Tracker - Final Historical 2021 Q2. For details, visit: [www.keypointintelligence.com/HPInstantInk](https://www.keypointintelligence.com/HPInstantInk).
11. Automatic delivery and consolidated bill: Printers require direct connection to the internet for programme participation. Internet access sold separately.
12. Never run out: based on plan usage, internet connection to eligible HP printer, valid credit/debit card, email address and delivery service in your geographic area.
13. Change or cancel: Change or cancel your plan at any time online. If you decide to cancel your HP Instant Ink plan, you can go back to using HP Original Standard or XL cartridges. Plan upgrades are effective immediately and the charges will be applied retrospectively or in the next billing cycle, depending on user choice. Plan downgrades and cancellations are effective after the last day of the current billing period. For full details, visit: [www.hpinstantink.com/terms](https://www.hpinstantink.com/terms).

