

Lenovo Wireless Multi-Mode Pro Keyboard 6000

About the product

The keyboard combines silent typing, reliable performance, and a sleek, comfortable design for focused work. It connects to up to three devices via Bluetooth or 2.4GHz for smooth, uninterrupted productivity.

Note: Images shown are for illustration only and may differ slightly from the actual product.

Overview

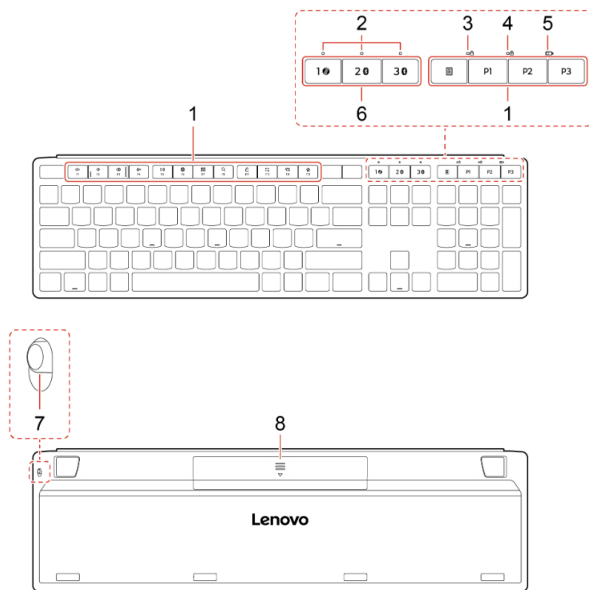

1. Programmable keys

2. Connection indicators

- Blinking quickly: Pairing mode
- Blinking slowly: Connecting
- Solid white: Connected (the indicator turns off after a few seconds)

3. Num lock indicator

4. Caps lock indicator

5. Battery status indicator

- Solid white: Powered on (the indicator turns off after a few seconds)
- Blinking amber: Low battery (replace the batteries)

6. Wireless channels connection keys

- Short press: Switch channels.
- Press and hold for two seconds: Connect through the current wireless channel.

7. Power switch

8. Battery and receiver compartment cover

Note: You can customize the function of the programmable keys via [Lenovo Accessories and Display Manager \(LADM\)](#).

Function keys	Description
F1	Mute/Unmute the speaker.
F2	Decrease the speaker volume.
F3	Increase the speaker volume.
F4	Mute/Unmute the microphone.
F5	Play/Pause a multimedia file.
F6	Launch the default Web browser.
F7	Switch between tasks.
F8	Start the operating system search.
F9	Lock the computer screen.
F10	Take a screenshot.
F11	Open Smart Share/Phone Link.
F12	Open Lenovo AI Portal/Lenovo Official Site.

Download the software

Lenovo Accessories and Display Manager (LADM) is a software platform designed for the efficient use and easy setup of compatible Lenovo products. Through LADM, you can customize programmable keys or buttons, DPI settings, receiver settings, and more.



To download LADM, go to <https://support.lenovo.com/downloads/ladm>.

Set up the product

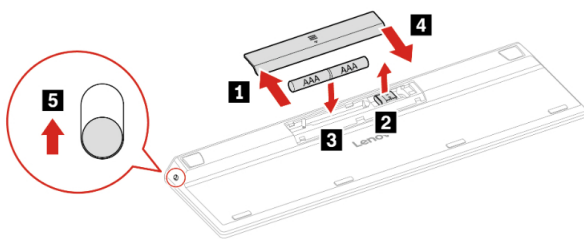

1. Remove the battery and receiver compartment cover.
2. Remove the receiver.
3. Insert two AAA batteries (match polarity indicators).
4. Reinstall the cover.
5. Turn on the power switch.

Use the product

Wireless pairing

You can connect up to three devices to this product using a Lenovo Pro USB Unified Pairing Receiver and Bluetooth, and switch between them.

Pair with USB receiver

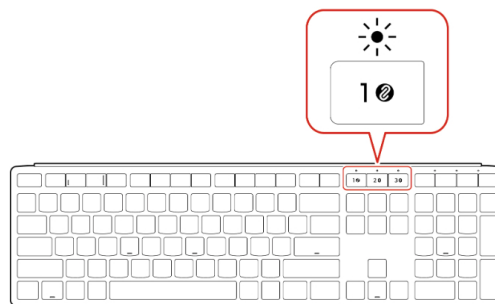

The receiver is pre-paired with the product. Install the receiver into a USB-A connector on your device to directly connect the device to your product.

Notes:

- Ensure that the distance between your product and the receiver is within 30 cm.
- If it doesn't work, re-pair the receiver with the product via LADM and follow the instructions below:
 1. Press and hold the wireless channels connection key (receiver channel) for two seconds (the indicator blinks quickly).
 2. The product is successfully connected (the indicator turns solid white for a few seconds and then turns off).

Pair with Bluetooth

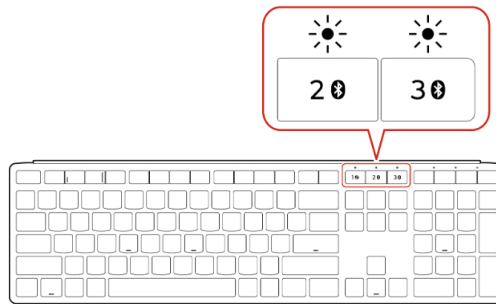

You can connect up to two devices to this product using Bluetooth.

Note: Keep the product close to the device during pairing.

1. Press and hold the wireless channels connection key (Bluetooth channel) for two seconds (the indicator blinks quickly).
2. In your device's Bluetooth menu, select the keyboard.
3. The product is successfully connected (the indicator turns solid white for a few seconds and then turns off).
4. Repeat the above steps to connect to a third device if needed.

Select the paired device

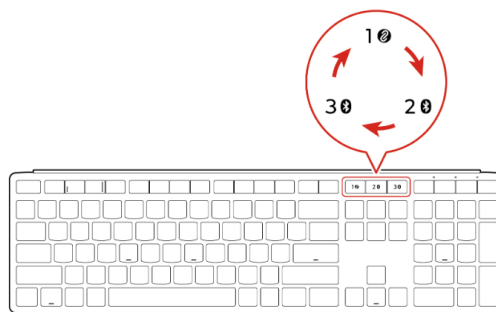

To switch between the paired devices, short-press the wireless channels connection keys until the desired connection indicator turns on.

Use the phone stand

Elevate your workspace with the Lenovo Integrated Phone Stand for Keyboard 6000. Detachable for flexible desk use, it's built with high-quality materials for stability, decluttering your space to boost efficiency.

Note: Please be aware that the stand is not included in the package. It can be purchased separately.

Follow the instructions below to use it if needed:

1. Attach the phone stand to the keyboard.

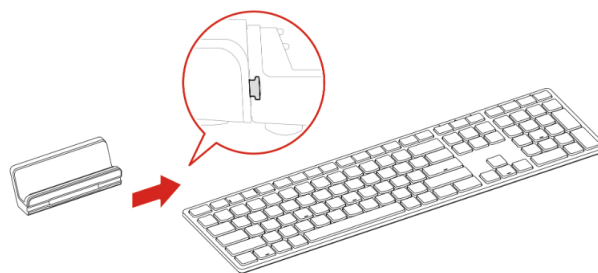

2. Adjust it to work with the keyboard properly.

