

Wireless Keyboard + EasyGlide Mouse - 4270100

Quick Start Guide

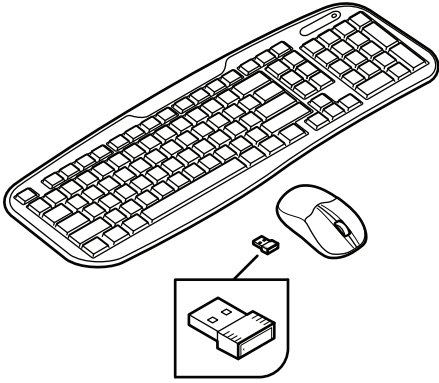

System Requirements:

- PC with Windows® ME/2000/XP/Vista™/Win7™/Win8™
- Mac OS X v10.4 or above
- Available USB port

Packaging Contents:

- Wireless keyboard
- EasyGlide™ mouse
- Nano USB Receiver
- 4 AAA batteries
- Quick Start Guide

1

Remove the battery cover and the USB receiver from the optical mouse. Install 2 AAA alkaline batteries and replace the cover. Slide the power switch to the On position.

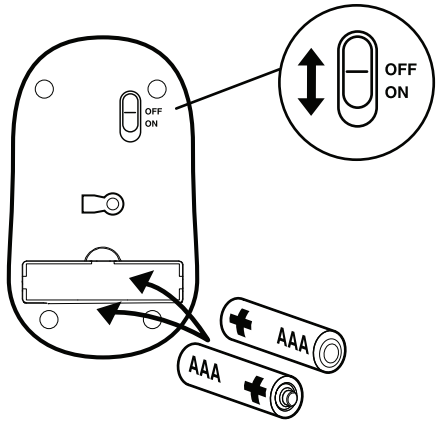

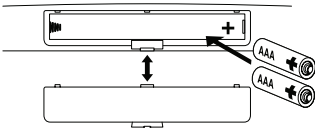

2

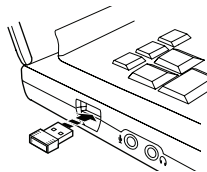

Remove the battery cover from the wireless keyboard. Install 2 AAA alkaline batteries and replace the cover.

3



Plug the USB receiver into an available USB port on the computer. USB ports are identified as .

Note:

The mouse and keyboard are plug-and-play. Once connected to the computer, they will be available for use.