

## Articulating Wall Arm For 22" to 40" LCD Flat Panel Screens

### NEW!

It's easy to get the best viewing options by pulling out the screen from the wall, positioning it in almost any direction, even turning it around corners and then smoothly returning it to the wall when finished. Effortlessly adjust the tilt with just a touch and level the screen at any time, even after installation. With integrated cable management, cords and cables are never in the way - even when extending and retracting the screen.

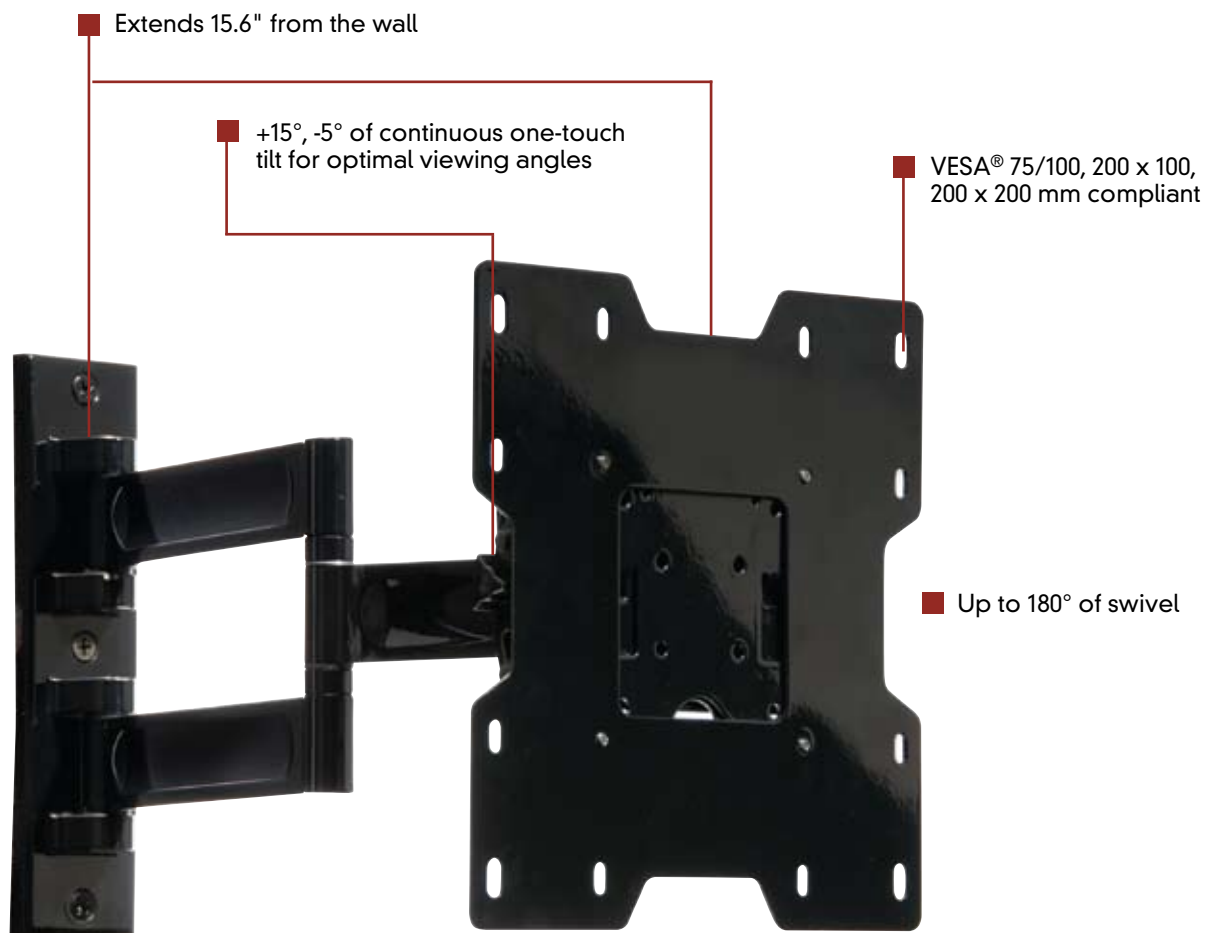



# Articulating Wall Arm

## For 22" to 40" LCD Flat Panel Screens

### Model Numbers

PA740, PA740-S

### Product Specifications

- Extends 15.6" from the wall
- Retracts to 2.93" to save space
- Integrated cable management keeps cables and cords out of the way
- $\pm 15^\circ$ ,  $-5^\circ$  of continuous one-touch tilt for optimal viewing angles
- Up to  $180^\circ$  of swivel
- VESA® 75/100, 200 x 100 and 200 x 200 mm compliant
- UL listed

**DIMENSIONS (W x H x D)** 8.75" x 9.35" x 2.93" - 15.6" (22.2 x 23.7 x 7.4 - 39.6 cm)

**LOAD CAPACITY** 80 lb (36.2 kg)

**PRODUCT WEIGHT** 4.62 lb (2.9 kg)

**FINISH** Scratch-resistant fused epoxy

**AVAILABLE COLORS**  
PA740: High gloss black  
PA740-S: High gloss silver

**ACCESSORIES**  
Metal stud wall plate (WSP940)  
Screen-side security fasteners (ACC919)

**PATENT** Patent pending

### Package Specifications

**PACKAGE CONTENTS** Mount with VESA® 75/100, 200 x 100 and 200 x 200 mm adapter, all necessary mounting and screen attachment hardware

**UNITS IN PACKAGE** 1

**PACKAGE SIZE (W x H x D)** 10.625" x 10.313" x 4" (26.98 x 26.195 x 10.16 cm)

**PACKAGE SHIP WEIGHT** 5.89 lb (2.67 kg)

**PACKAGE UPC CODE**  
PA740: 735029256090  
PA740-S: 735029256106

**WARRANTY** Limited 5-year

**peerless®**  
**MOUNTS**

Peerless Industries, Inc.  
3215 W. North Avenue,  
Melrose Park, IL 60160

(800) 865-2112

(708) 865-8870

Fax: (708) 865-2941

www.peerlessmounts.com



One-touch tilt allows adjustment of  $+15^\circ$ / $-5^\circ$  without the use of tools



Integrated cable management keeps cables and cords out of the way



LIT-0236