

650184 17"-35" Premium Monitor Desk Mount Bracket, Black

Product Images

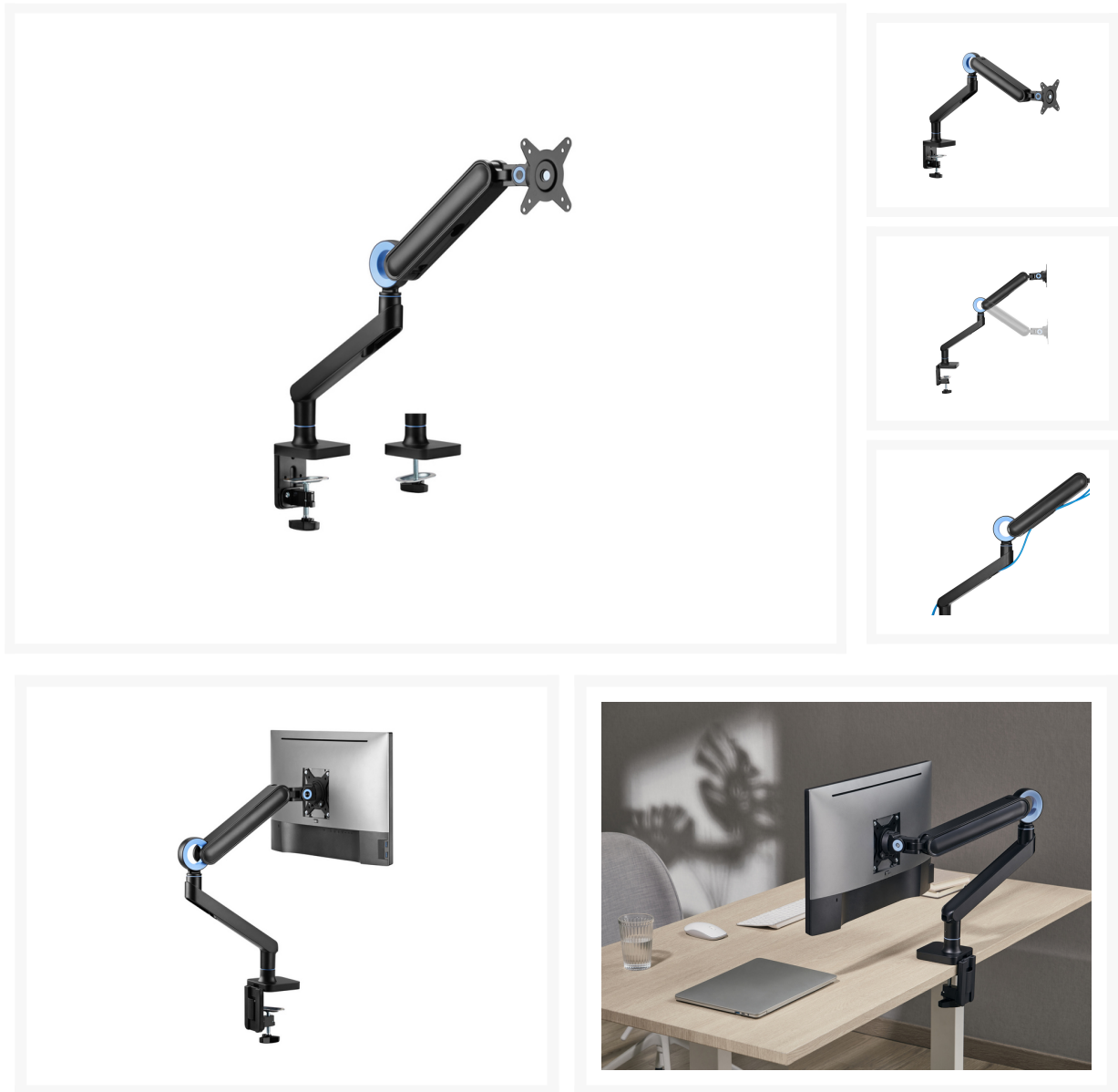



Dimensions (mm)

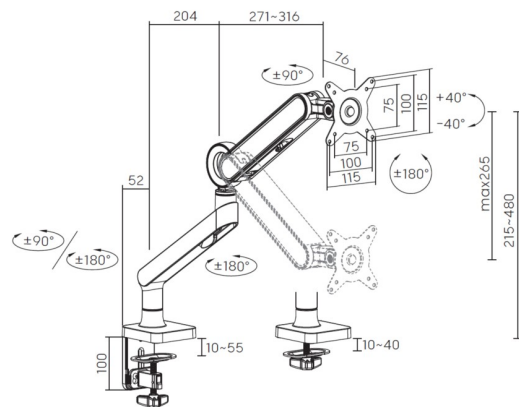

Short Description

- Max. Load Capacity: 10.5Kg
- Max. VESA: 75x75, 100x100
- Sturdy and lightweight aluminum construction
- Gas spring structure offers perfect counterbalance presentation in all directions
- Built-in spring tension gauge can be easily adjusted to fit varied weights on the arm
- Tool-free height adjustment
- VESA standards compliant

- Free-tilting design for multiple monitor viewing angles
- Detachable VESA Plate Design
- Cable clips keep cables organized and protected

Description

The Equip 650184 17"-35" Premium Monitor Desk Mount Bracket is a high-quality and versatile solution designed to elevate your workspace. This premium mount is crafted to support monitors ranging from 17 inches to 35 inches in size, providing stability and flexibility for a superior display experience.

Crafted with precision and durability in mind, the premium desk mount bracket ensures a secure and stable foundation for monitors with varying weights. The sleek and modern design complements your workspace aesthetics, creating a professional and organized look.

The adjustable features of this premium mount allow for personalized positioning, enabling optimal ergonomic arrangements tailored to your preferences. Whether you're a professional requiring precision in your work or a gamer seeking an immersive display setup, this premium bracket delivers on both performance and style.

Installation is seamless, and the mount is compatible with various desk surfaces. The premium build guarantees long-lasting quality, making it a reliable choice for enhancing your workstation. Additionally, cable management features contribute to a clean and clutter-free workspace.

Additional Information

Harmonized System (HS) code	852990
Customs product code (TARIC)	8529909700
Approval and Compliance	RoHS & REACH
Package Contents	Desk Mount Bracket User Manual Screws kits
Color	Black
EAN	4015867236093
Model Number	650184
Cable management	Yes
Quick Installation VESA Plate	Yes
Compatible Display Size	17"-35"
Installation	Clamp,Grommet
Load Capacity (kg)	10.5kg
Material	Plastic, Stainless Steel, Aluminum
Mount	Desk mount
Pan (Swivel) range	+90°~-90°
Screen Rotation	+180°~-180°
Screens support quantity	1
Support Curved TV (Monitors)	Yes
Tilt range	+40°~-40°
VESA compatibility	75x75,100x100
Dimensions (W x D x H)	115 x 603 x 652 mm
Product weight (kg)	2.95

