

Keychron B4 Pro

QUICK START GUIDE

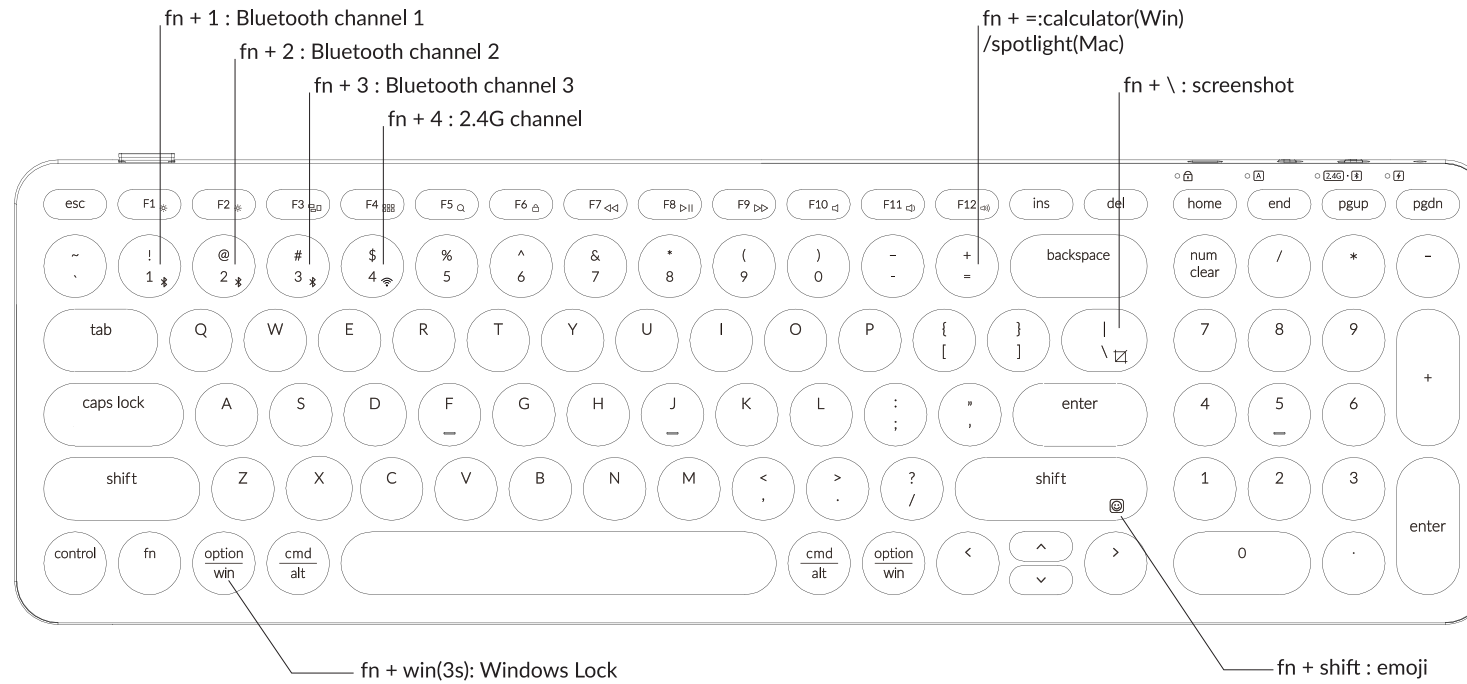

Visit B4 Pro online user guide



1 Connect 2.4GHz Receiver

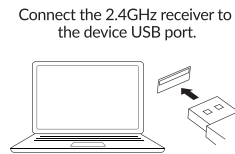

Connect the 2.4GHz receiver to the device USB port.

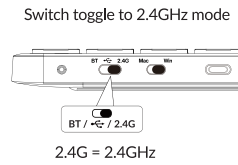

Switch toggle to 2.4GHz mode

BT / / 2.4G
2.4G = 2.4GHz

2 Connect Bluetooth

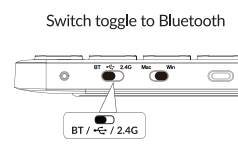
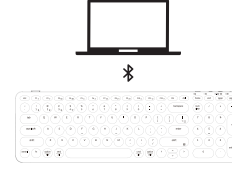

Switch toggle to Bluetooth

BT / / 2.4G

Press fn + 1 (for 3 seconds) and pair with device named Keychron B4 Pro.



fn + 1

3 Connect Cable

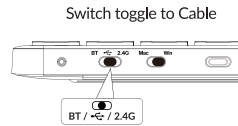
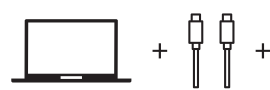

Switch toggle to Cable

BT / / 2.4G
Mac Win

4 Switch To The Right System

Please make sure the system toggle on the top right corner has been switched to the same system as your computer's operating system.

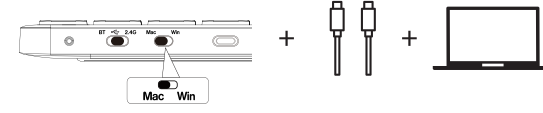

Mac Win

5 Switch Between Function And Multimedia Keys

Press fn + X + L (for 3 seconds) to switch



fn + X + L

Multimedia keys

Function keys

F1 / F2 / F3 / F4 / F5 / F6 / F7 / F8 / F9 / F10 / F11 / F12

6 Reset Keyboard

Hold fn + J + Z for 3 seconds.



fn + J + Z



Not Happy

support@keychron.com